

# **Benoit Angus Ranch**

## **19th Annual Production Sale**



**Thursday, March 20, 2008 • 1:00 PM (CST)**  
**Esbon, Kansas**



**19th ANNUAL**

**Performance Production Sale**

**THURSDAY, MARCH 20, 2008**

**1:00 PM (CST) • AT THE RANCH on US Hwy 36**



**SELLING:**

- **150 SPRING BULLS** (11 to 14 Months Old, Not Picked Over)
- **20 FALL BULLS** (18 Months Old, Not Picked Over)

**AUCTIONEER:**

James M. Birdwell  
Home (580) 549-6636 - Cell (580) 695-2352



**LIVESTOCK PRESS REPRESENTATIVES & RINGMEN:**

- Matt Caldwell, *Angus Journal* ..... (816) 390-6602  
Regional Manager of the American Angus Association
- Brett Spader, *Kansas Stockman* ..... (785) 273-5115
- Guy Peverley, *High Plains Journal* ..... (785) 456-9911
- Doug Paul, *Stock Exchange* ..... (405) 840-3915
- Anne Lampe, *Kansas Angus News* ..... (620) 872-3915
- Galen Gerdes, *Nebraska & Kansas Farmer* (308) 380-0302
- Randy Rasby, *Livestock Plus, Inc.* H:(308) 386-4857 C:(308) 539-6195

*Buyers unable to attend the sale may send their bids to the field representatives or the auctioneer.*

**ACCOMMODATIONS:**

- Crest Vue, Mankato, KS ..... (785) 378-3515
- U.S Center Motel, Smith Center, KS ..... (785) 282-6611
- Super 8, Beloit, KS ..... (800) 800-8000
- Super 8, Belleville, KS ..... (785) 527-2112
- West Lake Inn, Downs, KS ..... (785) 454-3345

**TRANSPORTATION:**

Airstrips for small planes are available in surrounding towns close to the ranch. Contact Bonnie Benoit for more information. We will arrange for pick-up service from the small airports in our areas if notified before.

**TERMS AND CONDITIONS:**

This sale is being conducted under the suggested Terms and Conditions of the American Angus Association.

**HERD HEALTH:**

All bulls will be fertility tested. The bulls in the sale have been pre-weaned and weaning vaccinated for respiratory disease. They have been poured and dewormed.

**CATALOG UPDATE:**

A supplemental sheet will be available sale day with updated information. This sheet will take precedence over the sale catalog. We will post updates as soon as possible on our web site.

**LIVESTOCK INSURANCE:**

American Livestock Insurance Co. (Harding & Harding)  
Sheila Jensen

**LOT NUMBERS:**

Ear tags on cattle correspond with lot numbers in this book.

**DELIVERY:**

Free delivery. All bulls will be delivered free in Nebraska or Kansas, or we will keep them 30 days and you pick them up, your choice. We will start to deliver a week after the sale. You can take them home the day of the sale and we will give \$50 off each bull purchased. All bulls selling over \$3,000 outside of Kansas and Nebraska will be delivered to a central point.

**GUARANTEE:**

All bulls selling for \$2,000 or more are guaranteed against breeding injury for the first breeding season. Breeding season is defined as the 90-day period following the first turnout of the bulls. If a replacement bull is available, he will be provided, or if the buyer prefers, credit toward one bull will be given in the following year's sale, less salvage value of the injured bull. We will not replace a dead animal if it is killed or dies for any reason. Normal care needs to be exercised toward these animals and not be allowed to get thin or neglected.

**MEALS:**

Coffee and donuts in the morning.  
Complimentary lunch will be served at 11:30 AM



**SALE DAY PHONE (785) 725-3231  
EXTRA LINE (785) 725-3039**

*Please Bring This Book With You To The Sale!*



Everett, Bonnie Benoit  
621 Hwy. 36 • Esbon, KS 66941  
(785) 725-3231 • (785) 725-3039  
Toll Free (888) 870-2855 • Cell (785) 545-6248  
E-Mail: [bbenoit@uscenter.net](mailto:bbenoit@uscenter.net)  
[www.benoitangus.com](http://www.benoitangus.com)

Doug & Michelle Benoit  
(785) 725-6211 • Cell (785) 545-6806  
Chad & Marcy Benoit  
(785) 725-3005 • (785) 545-8095

Dear Cattleman and Friends,

Welcome too our 19<sup>th</sup> Annual Production Bull sale. We have had a very busy and exciting year. In July, we added a very special young lady to our family as Chad married the former Marcy Fletchall. We are very fortunate and proud to have her as part of the family.

The bulls we are offering this year are as good as we've ever offered. This group has been assembled with the breeding of the cattle the right way with something that will work for our bull customers. The bulls in the sale are not picked over, creep fed, and are fed a high roughage ration. They are selected with the most discriminating cow person in mind and are as uniform and deep in quality as you'll find anywhere. Over 50% of the bulls have a birth EPD of +2.0 or under, which is suitable for heifers. Our weaning weights were exceptional, and these bulls have excelled on test and in carcass data.

We would like to invite you to inspect our bulls that will be selling before some of the other sales to compare. We are sure that you will be pleased with both the bulls selling and our current cow herd. If there are any questions about the sale offering, please don't hesitate to give us a call at the phone number above. Also check out our web site <http://www.benoitangus.com> for new updates on the bulls.

We are always excited for a new year to visit with our old customers and to meet our new customers. We will be moving the bulls from our feeding location just south of Esbon to our sale facility on Hwy 36 on Wednesday, March 19<sup>th</sup>. They will be at the Benoit Ranch to view. We try to offer a welcome mat to anyone that comes before the sale. We hope that you can be here early on Thursday morning for a complimentary breakfast and lunch. Thanks for your interest.

Sincerely,

*Benoit Family*

Benoit Angus  
Everett & Bonnie  
Chad & Marcy  
Doug, Michelle and Family





# REFERENCE SIRES



## **A** HD Dunn Cornerstone 0245 Calved: 2/10/00 Tattoo: 0245 +13648126

#Sitz Traveler 9929 #DHD Traveler 6807  
Sitz Traveler 7594 Sitz Everelda Entense 1137  
Sitz Emma E 2552 #GDAR Traveler 044  
Sitz Emma E 447

#Shoshone Intent KGEA27 #Shoshone Viking GD60  
#Dixie Erica of CH 6180 Shoshone Barbara 2GEA 27  
Dixie Erica of CH 1019 #PBC 707 1M F0203  
Dixie Erica of CH 615

BW	WW	Milk	Comb.	YW			
+4.0	.69	+39 .69	+11 .45	+31	+77 .61		
%IMF	Ribeye	Fat	\$W	\$F	\$G	\$B	
+.06	.64	+.29 .65	+.004 .65	+16.06	+21.08	+12.79	+30.74

## **B** RR Popatop 0600 Calved: 1/17/00 Tattoo: 0600 13595546

#RR Hero 6267 #Highwood Hero LCH  
#Hero 6267 or RR 2418 #Blackbird of RR 1204  
RR Everelda Entense 0413 #QAS Traveler 23-4  
RR Everelda Entense 8320 TPB

#Sitz Rito 9819 #Rito 054 GDAR  
Erica Lassie of RR 2407 #Sitz Barbaramere Jet 175  
Erica Lassie of RR 6313 #Highwood Hero LCH  
Erica Lassie of RR 9221

BW	WW	Milk	Comb.	YW			
-0.1	.74	+43 .74	+39 .61	+61	+77 .71		
%IMF	Ribeye	Fat	\$W	\$F	\$G	\$B	
-.31	.71	+.28 .71	-.004 .71	+32.52	+19.55	-2.28	+16.03

## **C** Summitcrest High Prime 0H29 Calved: 1/24/98 Tattoo: 0H29 13122485

#RR Traveler 5204 #QAS Traveler 23-4  
#Gardens Prime Time Eriskay of Rollin Rock 3302  
#Green Garden Susie 1246 S1 Gardens Transition 7205 S1  
Green Garden Susie 9118 S2

#Finks 5522-6148 #Emulation N Bar 5522  
Summitcrest Missie 2F55 Finks Proud Formera 614  
#Summitcrest Missie 1C24 #Hyline Nickel  
Summitcrest Missie 0Z48

BW	WW	Milk	Comb.	YW			
+1.2	.96	+43 .96	+24 .95	+46	+73 .94		
%IMF	Ribeye	Fat	\$W	\$F	\$G	\$B	
+.34	.96	+.41 .96	-.028 .96	+37.27	+15.65	+37.46	+47.98

## **D** E&B 1680 Precision 1023 Calved: 2/01/01 Tattoo: 1023 +13913492

#Tehama Bando 155 #Band 234 of Ideal 3163  
#GAR Precision 1680 Tehama Blackcap G373  
9J9 GAR 856 #Rito 9J9 of B156 7T26  
Blackbird GAR 833

#DHD Traveler 6807 #QAS Traveler 23-4  
E&b 6807 Lady Traveler 61 #Bemindful Maid DHD 0807  
Lady 963 Dividend 404 #TC Dividend 963  
Lady Traveler B169

BW	WW	Milk	Comb.	YW			
+0.0	.91	+51 .91	+19 .66	+45	+92 .85		
%IMF	Ribeye	Fat	\$W	\$F	\$G	\$B	
+.52	.87	+.70 .87	-.007 .87	+34.43	+31.51	+31.01	+56.53

## **E** HA Power Alliance 1025 Calved: 2/13/01 Tattoo: 1025 +13992383

#Sitz Traveler 8180 #GDAR Traveler 71  
#Sitz Alliance 6595 Sitz Everelda Entense 1137  
#Sitz Barbaramere Jet 2698 3 Bar Spike 1766  
#Sitz Baramere Jet 155

#CH Stacker 7040 #Rito 2100 GDAR  
+HA Rito Lady 4167 Merle of CH 2031  
H 96 Band Lady 3714 Band 105 of Hyline 2380  
Rito Eileenmere 378 of 96

BW	WW	Milk	Comb.	YW			
+4.6	.87	+55 .87	+27 .59	+54	+93 .67		
%IMF	Ribeye	Fat	\$W	\$F	\$G	\$B	
+.18	.72	+.64 .72	+.008 .72	+27.74	+30.95	+17.93	+43.37

## **F** E&B 1680 Precision 1123 Calved: 9/10/01 Tattoo: 1123 14206314

#Tehama Bando 155 #Band 234 of Ideal 3163  
#GAR Precision 1680 Tehama Blackcap G373  
9J9 GAR 856 #Rito 9J9 of B156 7T26  
Blackbird GAR 833

#Gardens EXT 4137 S2 #N Bar Emulation EXT  
E&b 4137 Ext 9004 #Green Garden Bonnie 1134 S1  
+E&d 71 Lady Traveler 677 #GDAR Traveler 71  
Lady Stacker B184

BW	WW	Milk	Comb.	YW			
+2.7	.60	+40 .60	+21 .34	+41	+82 .50		
%IMF	Ribeye	Fat	\$W	\$F	\$G	\$B	
+.26	.55	+.42 .55	+.035 .55	+21.32	+25.68	+17.31	+38.56

## **G** LD Axis 1410 Calved: 9/10/01 Tattoo: 1410 +14121061

#Tehama Bando 155 #Band 234 of Ideal 3163  
#Bon View Bando 598 Tehama Blackcap G373  
#Bon View Dora 56 #Voltage HK K142  
#Bon View Dora 254

#DHD Traveler 6807 #QAS Traveler 23-4  
Hinksons Erica 9310 #Bemindful Maid DHD 0807  
#Hinksons Erica 911119 Hinksons Saratoga Country  
Hinksons Erica 8729

BW	WW	Milk	Comb.	YW			
-0.8	.66	+39 .66	+19 .46	+39	+79 .58		
%IMF	Ribeye	Fat	\$W	\$F	\$G	\$B	
+.14	.62	+.19 .63	+.021 .63	+25.63	+23.06	+13.07	+32.63

## **H** Stevenson Midland 1543 Calved: 1/09/03 Tattoo: 1543 14370412

#Twin Valley Precision E161 #GAR Precision 1680  
BR Midland +WCC Blackcap C9  
BR Royal Lass 7036-19 #+SAF Neutron  
#SAF Royal Lass 7036

#Rockn D Ambushh 1531 #Paramont Ambush 2172  
Stevenson Rosebud 9271 MS Blackcap Band of RD 1301  
#Stevenson Rosebud J716 #Basin Rainmaker 654X  
Stevenson Rosebud 4977

BW	WW	Milk	Comb.	YW			
+1.0	.70	+47 .70	+18 .26	+42	+73 .63		
%IMF	Ribeye	Fat	\$W	\$F	\$G	\$B	
+.21	.67	+.67 .67	+.011 .67	+31.13	+14.15	+21.89	+37.04

# B REFERENCE SIRES B

## I HSAF Bando 1961

Calved: 3/07/01      Tattoo: 1961      +13896250

#Bon View Bando 598      #Tehama Bando 155  
 #+SAF 598 Bando 5175      #Bon View Dora 56  
 +SAF Royal Lass 1002      #VDAR New Trend 315  
    +SAF Royal Lass 6089

#N Bar Emulation EXT      #Emulation N Bar 5522  
 +JKS Miss Cheyenne 196      N Bar Primrose 2424  
 +Magic Meadow Miss Cheyenne      #Century Touchstone 131  
    SAV Cheyenne 2213

BW	WW	Milk	Comb.	YW		
+2.2 .91	+58 .91	+32 .65	+61	+102 .73		
%IMF	Ribeye	Fat	\$W	\$F	\$G	\$B
+1.2 .72	+0.09 .73	+0.015 .73	+33.30	+39.10	+9.51	+38.88

## M E&B New Design 3133

Calved: 2/01/03      Tattoo: 3133      +14466268

#VDAR New Trend 315      #AAR New Trend  
 #B/R New Design 036      #VDAR Lucy 704  
    B/R Blackcap Empress 76      #K&K Top Gun  
    +QLC A70 Blkcp Empress E43T

#DHD Traveler 6807      #QAS Traveler 23-4  
 E&b 6807 Lady Traveler 61      #Bemindful Maid DHD 0807  
    Lady 963 Dividend 404      #TC Dividend 963  
         Lady Traveler B169

BW	WW	Milk	Comb.	YW		
-0.1 .51	+40 .50	+25 .30	+45	+69 .47		
%IMF	Ribeye	Fat	\$W	\$F	\$G	\$B
+1.15 .52	+1.11 .53	+0.002 .53	+30.21	+12.91	+17.77	+31.41

## J LD Hawkeye 211

Calved: 10/23/02      Tattoo: 211      14406019

#B/R New Design 036      #VDAR New Trend 315  
 +B/R New Frontier 095      B/R Blackcap Empress 76  
    White Fence Pride H1      #Connealy Dateline  
         #Pleasant Pill of Conanga

#DHD Traveler 6807      #QAS Traveler 23-4  
 #LD 6807 Pride 9211      #Bemindful Maid DHD 0807  
    Molitor 473 Pride 8432      #Molitor Cardinal  
         #Molitor Amargo Pride 4638

BW	WW	Milk	Comb.	YW		
+1.0 .67	+35 .66	+20 .37	+38	+73 .60		
%IMF	Ribeye	Fat	\$W	\$F	\$G	\$B
+4.4 .63	+3.33 .64	+0.012 .64	+22.80	+18.67	+26.22	+41.91

## N Hyline Right Time 338

Calved: 1/29/98      Tattoo: 338      13058662

#N Bar Emulation EXT      #Emulation N Bar 5522  
 #+Leachman Right Time      N Bar Primrose 2424  
    Leachman Erica 0025      #Tehama Bando 155  
         Leachman Erica 8058

+Hyline SVF Traveler 0115      #Traveler 124 GDAR  
 Hyline Pride 265      #Pride of Hyline 7919  
    Hyline Pride 870      #Hyline Oscar 555  
         Hyline Pride 505

BW	WW	Milk	Comb.	YW		
+3.9 .97	+60 .97	+32 .96	+62	+106 .96		
%IMF	Ribeye	Fat	\$W	\$F	\$G	\$B
+2.25 .96	+3.32 .96	+0.008 .15	+41.27	+42.52	+15.50	+46.03

## K Rito 2 878 of 2536 BVND 878

Calved: 9/10/02      Tattoo: 2878      +14200755

#B/R New Design 036      #VDAR New Trend 315  
 #Bon View New Design 878      B/R Blackcap Empress 76  
    Bon View Gammer 85      #Bon View Bando 598  
         Bon View Gammer 233

#GAR Precision 1680      #Tehama Bando 155  
 GAR Precision 2536      9J9 GAR 856  
    +GAR Ext 2104      #N Bar Emulation EXT  
         #GAR Scotch Cap 867

BW	WW	Milk	Comb.	YW		
+0.8 .93	+44 .93	+24 .73	+46	+80 .87		
%IMF	Ribeye	Fat	\$W	\$F	\$G	\$B
+2.26 .89	+3.89 .89	+0.029 .89	+27.86	+22.13	+22.06	+42.09

## O E&B 878 New Design 4114

Calved: 2/07/04      Tattoo: 4114      +14751103

#B/R New Design 036      #VDAR New Trend 315  
 #Bon View New Design 878      B/R Blackcap Empress 76  
    Bon View Gammer 85      #Bon View Bando 598  
         Bon View Gammer 233

#DHD Traveler 6807      #QAS Traveler 23-4  
 +E&d Lady 6807 796      #Bemindful Maid DHD 0807  
    Lady 183 Traveler 334      E&b Traveler 183  
         Lady Stacker B23

BW	WW	Milk	Comb.	YW		
+2.7 .54	+42 .52	+25 .30	+46	+78 .45		
%IMF	Ribeye	Fat	\$W	\$F	\$G	\$B
+0.00 .53	+3.55 .53	+0.016 .53	+25.35	+20.92	+11.82	+30.42

## L E&B 1680 Precision 295

Calved: 2/04/02      Tattoo: 295      +14206379

#Tehama Bando 155      #Band 234 of Ideal 3163  
 #GAR Precision 1680      Tehama Blackcap G373  
    9J9 GAR 856      #Rito 9J9 of B156 7T26  
         Blackbird GAR 833

#Gardens EXT 4137 S2      #N Bar Emulation EXT  
 E&b 4137 Lady Dominique 794      #Green Garden Bonnie 1134 S1  
    Lady Scotch Traveler 321      #RR 9440 Scotch Cap 1483  
         Lady Stacker B185

BW	WW	Milk	Comb.	YW		
+2.2 .66	+39 .66	+19 .40	+39	+68 .60		
%IMF	Ribeye	Fat	\$W	\$F	\$G	\$B
+5.59 .65	+7.76 .66	-0.018 .66	+24.87	+12.33	+35.78	+49.52

## P E&B Lead On 450

Calved: 1/09/04      Tattoo: 450      14755377

#Connealy Leadtime      #Connealy Dateline  
 Connealy Lead On      #Ruths Rona of Conanga  
    Eligence Plus of Conanga      #TC Dividend 963  
         Eura Cap of Conanga

#Bon View Bando 598      #Tehama Bando 155  
 +E&B 598 Lady Bando 292      #Bon View Dora 56  
    +E&d 1483 Lady Scotchman 797      #RR 9440 Scotch Cap 1483  
         Lady 183 Traveler 334

BW	WW	Milk	Comb.	YW		
+3.5 .56	+58 .54	+31 .26	+60	+108 .50		
%IMF	Ribeye	Fat	\$W	\$F	\$G	\$B
-0.21 .53	+7.75 .53	+0.005 .53	+27.37	+45.50	+3.45	+34.59

# REFERENCE SIRES

## **Q** Dalebanks Centennial 4670 Calved: 2/29/04 Tattoo: 4670 14796617

#Bon View New Design 878 #B/R New Design 036  
Dalebanks Centennial 2526 Bon View Gammer 85  
#Witch of Dalebanks 9067 #N Bar Emulation EXT  
#Witch of Dalebanks 6011

Dalebanks Emulation Ext 3383 #N Bar Emulation EXT  
#Enamel 1614 of Dalebanks Erica of Dalebanks 0853  
#Enamel 4054 of Dalebanks #Rito 8E8 of 5H11 Traveler  
Enamel 9544 of Dalebanks

BW		WW		Milk		Comb.		YW	
+2.5	.59	+42	.57	+19	.22	+41		+82 .48	
%IMF	Ribeye	Fat		\$W	\$F	\$G	\$B		
+3.2	.49	+3.0	.50	+0.04	.50	+23.29	+24.90	+21.08	+41.68

## **U** E&B E161 Precision 557 Calved: 2/01/05 Tattoo: 557 +15122270

#GAR Precision 1680 #Tehama Bando 155  
#Twin Valley Precision E161 9J9 GAR 856  
+WCC Blackcap C9 #SS Traveler 6T6  
Premier Blackcap 6276A

#RR 9440 Scotch Cap 1483 #RR Scotchcap 9440  
+E&b 1483 Lady Scotchman 75 Eriskay of Rollin Rock 8211  
Lady 183 Traveler 334 E&b Traveler 183  
Lady Stacker B23

BW		WW		Milk		Comb.		YW	
+2.6	.34	+38	.30	+20	.31	+39		+84 .31	
%IMF	Ribeye	Fat		\$W	\$F	\$G	\$B		
+2.7	.35	+5.7	.37	+0.13	.37	+18.73	+28.48	+20.63	+42.62

## **R** A&B Midland 5096 Calved: 2/16/05 Tattoo: 5096 15150872

#Twin Valley Precision E161 #GAR Precision 1680  
BR Midland +WCC Blackcap C9  
BR Royal Lass 7036-19 #+SAF Neutron  
#SAF Royal Lass 7036

SVF Oscar 18E +SVF Oscar 9-1-1  
A&B Own Lass 9050 Blackbird of SVF 1429  
A&b Lass 5037 #CH Stacker 7040  
#A&b Viking Lass 293

BW		WW		Milk		Comb.		YW	
+2.7	.33	+45	.29	+19	.27	+42		+90 .29	
%IMF	Ribeye	Fat		\$W	\$F	\$G	\$B		
+6.2	.31	+4.6	.33	+0.31	.34	+22.08	+31.85	+27.34	+52.01

## **V** GAR Retail Product Calved: 8/14/99 Tattoo: 5659 13395329

#Tehama Bando 155 #Band 234 of Ideal 3163  
#GAR Precision 1680 Tehama Blackcap G373  
9J9 GAR 856 #Rito 9J9 of B156 7T26  
Blackbird GAR 833

#N Bar Emulation EXT #Emulation N Bar 5522  
+GAR Ext 4927 N Bar Primrose 2424  
GAR Traveler 641 #QAS Traveler 23-4  
+GAR Scotch Cap 150

BW		WW		Milk		Comb.		YW	
+2.6	.97	+46	.97	+27	.94	+50		+92 .96	
%IMF	Ribeye	Fat		\$W	\$F	\$G	\$B		
+5.2	.96	+6.4	.96	+0.03	.96	+34.49	+33.51	+30.12	+57.75

## **S** E&B Power Alliance 5152 Calved: 3/16/05 Tattoo: 5152 15103389

#Sitz Alliance 6595 #Sitz Traveler 8180  
+HA Power Alliance 1025 #Sitz Barbaramere Jet 2698  
+HA Rito Lady 4167 #CH Stacker 7040  
H 96 Band Lady 3714

+HD Dunn Cornerstone 0245 Sitz Traveler 7594  
E&B Lady Cornerstone 2121 #Dixie Erica of CH 6180  
E&b 4137 Lady Dominett 862 #Gardens EXT 4137 S2  
Lady 90 Stacker 339

BW		WW		Milk		Comb.		YW	
+3.0	.38	+48	.31	+19	.17	+43		+90 .27	
%IMF	Ribeye	Fat		\$W	\$F	\$G	\$B		
+0.9	.31	+7.1	.34	+0.16	.34	+23.61	+30.65	+14.78	+39.41

## **W** E&B 208 New Design 573 Calved: 1/11/05 Tattoo: 573 15103467

#B/R New Design 036 #VDAR New Trend 315  
#Bon View New Design 208 B/R Blackcap Empress 76  
#Bon View Erica 443 #N Bar Emulation EXT  
#Bon View Erica 1380

+HD Dunn Cornerstone 0245 Sitz Traveler 7594  
E&B Lady Cornerstone 382 #Dixie Erica of CH 6180  
E&b 5706 Lady Arbitrator 866 +Leachman Arbitrator  
Lady 228 Stepahead 473

BW		WW		Milk		Comb.		YW	
+1.0	.38	+48	.31	+34	.25	+58		+87 .27	
%IMF	Ribeye	Fat		\$W	\$F	\$G	\$B		
+1.1	.32	+6.3	.34	+0.03	.35	+31.44	+27.60	+16.76	+40.25

## **T** RR Midland 5166 Calved: 2/21/05 Tattoo: 5166 15238104

#Twin Valley Precision E161 #GAR Precision 1680  
BR Midland +WCC Blackcap C9  
BR Royal Lass 7036-19 #+SAF Neutron  
#SAF Royal Lass 7036

#Hero 6267 of RR 2418 #RR Hero 6267  
#RR Revolution Rose 1663 RR Everelda Entense 0413  
RR Revolution Rose 9700 #+RR Bentley 779F  
KMA Revolution Rose 1156

BW		WW		Milk		Comb.		YW	
+2.4	.33	+47	.29	+20	.27	+44		+86 .29	
%IMF	Ribeye	Fat		\$W	\$F	\$G	\$B		
+4.2	.33	+3.7	.35	+0.07	.35	+26.26	+26.98	+23.96	+45.42

## **X** GAR Predestined Calved: 8/16/99 Tattoo: 5899 13395344

#VDAR New Trend 315 #AAR New Trend  
#B/R New Design 036 #VDAR Lucy 704  
B/R Blackcap Empress 76 #K&K Top Gun  
+QLC A70 Blkcp Empress E43T

#N Bar Emulation EXT #Emulation N Bar 5522  
#+GAR Ext 4206 N Bar Primrose 2424  
+GAR 6807 Traveler 1432 #DHD Traveler 6807  
#GAR 9J9 57

BW		WW		Milk		Comb.		YW	
+4.0	.95	+53	.95	+28	.79	+55		+99 .93	
%IMF	Ribeye	Fat		\$W	\$F	\$G	\$B		
+7.6	.94	+8.1	.94	+0.32	.94	+29.80	+37.98	+34.49	+66.52

# REFERENCE SIREs

## E&B E161 Precision 591

**Y** Calved: 1/23/05 Tattoo: 591 +15103481

#GAR Precision 1680 #Tehama Bando 155  
 #Twin Valley Precision E161 9J9 GAR 856  
 +WCC Blackcap C9 #SS Traveler 6T6  
 Premier Blackcap 6276A

#DHD Traveler 6807 #QAS Traveler 23-4  
 +E&d Lady 6807 767 #Bemindful Maid DHD 0807  
 Lady 183 Traveler 334 E&b Traveler 183  
 Lady Stacker B23

BW	WW	Milk	Comb.	YW		
+2.5 .34	+43 .30	+20 .29	+42	+91 .31		
%IMF	Ribeye	Fat	\$W	\$F	\$G	\$B
+1.3 .35	+43 .37	-0.07 .37	+20.91	+33.68	+17.45	+42.30

## Rito 616 of 4B20 6807

**CC** Calved: 1/04/96 Tattoo: 616 #12530601

#QAS Traveler 23-4 #Band 234 of Ideal 3163  
 #DHD Traveler 6807 QAS Blackbird Eve 601 1  
 #Bemindful Maid DHD 0807 #PBC 707 1M F0203  
 Bemindful Maid of RR 1079

#Tehama Bando 155 #Band 234 of Ideal 3163  
 +Rita 4B20 of 0FB1 Bando Tehama Blackcap G373  
 +Rita 0FB1 of 5H11 Fullback #Leachman Fullback  
 Rita 5H11 of 1B14 Rito 9J9

BW	WW	Milk	Comb.	YW		
-0.4 .98	+40 .98	+17 .97	+37	+85 .97		
%IMF	Ribeye	Fat	\$W	\$F	\$G	\$B
+1.18 .97	+21 .97	-0.001 .97	+28.82	+28.71	+21.39	+43.62

## GAR Solution

**Z** Calved: 8/12/02 Tattoo: 6032 14222615

#DHD Traveler 6807 #QAS Traveler 23-4  
 #SS Traveler 6807 T510 #Bemindful Maid DHD 0807  
 #SS Miss Hi Spade A114 #Hoff Hi Spade SC 491  
 SS Miss Rito 0H3 5H9

#B/R New Design 036 #VDAR New Trend 315  
 +GAR New Design 50 B/R Blackcap Empress 76  
 GAR Precision 2536 #GAR Precision 1680  
 +GAR Ext 2104

BW	WW	Milk	Comb.	YW		
-0.8 .94	+47 .94	+23 .55	+47	+92 .89		
%IMF	Ribeye	Fat	\$W	\$F	\$G	\$B
+7.8 .88	+37 .88	-0.003 .88	+28.37	+33.11	+33.12	+55.61

## Ironwood New Level

**DD** Calved: 4/08/99 Tattoo: 9399 13320150

#B/R New Design 036 #VDAR New Trend 315  
 Ironwood New Design 022 701 B/R Blackcap Empress 76  
 Wardens Lady 022 5410 Ironwood Impact PP 022  
 Wardens Lady 927 135

#Finks 5522-6148 #Emulation N Bar 5522  
 Wardens Blackcap 6148 6309 Finks Proud Formera 614  
 Wardens Blackcap SC 025 #Scotch Cap  
 Blackcap Samantha P 616

BW	WW	Milk	Comb.	YW		
-0.2 .96	+48 .96	+34 .92	+58	+90 .94		
%IMF	Ribeye	Fat	\$W	\$F	\$G	\$B
+1.12 .94	+29 .94	+0.11 .94	+36.28	+30.65	+17.39	+43.07

## Wulffs Ext 6106

**AA** Calved: 9/04/96 Tattoo: 6106 +12813196

#Emulation N Bar 5522 #Emulation 31  
 #N Bar Emulation EXT Ankony 8F78 Lass 8F275  
 N Bar Primrose 2424 #Emulation 31  
 Primrose N Bar 9962

#Tehama Bando 155 #Band 234 of Ideal 3163  
 Wulffs Erica Dianna C116 Tehama Blackcap G373  
 Wulffs Erica Dianna A308 Tehama Transmitter  
 #Tehama Erica Dianna M412

BW	WW	Milk	Comb.	YW		
-0.3 .92	+51 .92	+24 .87	+49	+89 .90		
%IMF	Ribeye	Fat	\$W	\$F	\$G	\$B
-0.02 .93	+29 .93	-0.001 .93	+40.21	+28.45	+9.59	+30.64

## Lemmon Newline C804

**EE** Calved: 3/13/00 Tattoo: C804 +13632776

#VDAR New Trend 315 #AAR New Trend  
 #B/R New Design 036 #VDAR Lucy 704  
 B/R Blackcap Empress 76 #K&K Top Gun  
 +QLC A70 Blkcp Empress E43T

#Connealy Dateline #DHD Traveler 6807  
 White Fence Pride H1 #Eila Eila of Conanga  
 #Pleasant Pill of Conanga #Tehama Bando 155  
 Pleasant Pride of Conanga

BW	WW	Milk	Comb.	YW		
+2.7 .96	+49 .96	+30 .88	+55	+85 .94		
%IMF	Ribeye	Fat	\$W	\$F	\$G	\$B
-0.04 .94	+45 .94	-0.020 .94	+30.89	+25.19	+13.35	+36.98

## GAR Yield Grade

**BB** Calved: 8/16/00 Tattoo: 6110 +13724351

#Tehama Bando 155 #Band 234 of Ideal 3163  
 #GAR Precision 1680 Tehama Blackcap G373  
 9J9 GAR 856 #Rito 9J9 of B156 7T26  
 Blackbird GAR 833

#N Bar Emulation EXT #Emulation N Bar 5522  
 +GAR Ext 4526 N Bar Primrose 2424  
 +GAR 6807 Traveler 93 #DHD Traveler 6807  
 +GAR Scotch Cap 199

BW	WW	Milk	Comb.	YW		
+0.9 .94	+51 .94	+24 .82	+50	+105 .92		
%IMF	Ribeye	Fat	\$W	\$F	\$G	\$B
+2.7 .93	+49 .93	-0.003 .93	+30.12	+45.19	+21.31	+51.69

## DCC New Look 101

**FF** Calved: 2/02/01 Tattoo: 101 13974138

#OCC Doctor 940D #+Rito 9FB3 of 5H11 Fullback  
 +OCC Genesis 872G Dixie Erica of CH 1019  
 #Blackbird of RR 1204 #PBC 707 1M F0203  
 Blackbird of RR 7023

#OCC Anchor 771A #DHD Traveler 6807  
 OCC Dixie Erica 814G OCC Juanada 709V  
 OCC Dixie Erica 764C #N Bar Emulation EXT  
 +OCC Dixie Erica 739A

BW	WW	Milk	Comb.	YW		
+1.0 .72	+45 .72	+19 .48	+42	+70 .61		
%IMF	Ribeye	Fat	\$W	\$F	\$G	\$B
-0.32 .66	+44 .66	+0.020 .66	+30.69	+12.02	-4.05	+10.17

# B REFERENCE SIRES B

## **GG** Twin Valley Precision E161 Calved: 5/16/95 Tattoo: E161 #12346200

#Tehama Bando 155 #Band 234 of Ideal 3163  
#GAR Precision 1680 Tehama Blackcap G373  
9J9 GAR 856 #Rito 9J9 of B156 7T26  
Blackbird GAR 833

#SS Traveler 6T6 #QAS Traveler 23-4  
+WCC Blackcap C9 #SS Miss Power Play 4A4  
Premier Blackcap 6276A +Brusco  
Premier Lady Blackcap 2861U

BW	WW	Milk	Comb.	YW		
+3.1 .97	+41 .97	+19 .96	+40	+91 .96		
%IMF	Ribeye	Fat	\$W	\$F	\$G	\$B
+32 .97	+68 .97	-.004 .97	+15.11	+34.48	+25.28	+51.31

## **HH** Koupals Glory 526 Calved: 1/07/05 Tattoo: 526 15105160

+OCC Exodus 712E #OCC Bonanza 880B  
#OCC Glory 950G Dixie Erica of CH 1019  
OCC Dixie Eica 971E +OCC Counterbalance 920C  
OCC Dixie Erica 907C

#+OCC Edison 801E #DHD Traveler 6807  
#Koupals Flower 072 Blackcap of RR 5367  
Beefland Flower 675 Summitcrest Ext 0C34  
Beefland Flower K145

BW	WW	Milk	Comb.	YW		
+3.6 .39	+38 .32	+16 .25	+35	+81 .29		
%IMF	Ribeye	Fat	\$W	\$F	\$G	\$B
+08 .29	+48 .31	+025 .32	+16.45	+25.45	+12.28	+32.68

## **II** GAR US Premium Beef Calved: 3/01/02 Tattoo: N502 +14301014

#Tehama Bando 155 #Band 234 of Ideal 3163  
#GAR Precision 1680 Tehama Blackcap G373  
9J9 GAR 856 #Rito 9J9 of B156 7T26  
Blackbird GAR 833

#N Bar Emulation EXT #Emulation N Bar 5522  
GAR Ext 2928 N Bar Primrose 2424  
+GAR 6807 Traveler 154 #DHD Traveler 6807  
+GAR Scotch Cap 309

BW	WW	Milk	Comb.	YW		
+1.1 .95	+36 .95	+20 .78	+38	+77 .92		
%IMF	Ribeye	Fat	\$W	\$F	\$G	\$B
+38 .92	+49 .93	+036 .93	+25.32	+22.23	+18.64	+42.60

## **J** ALC National T60N Calved: 3/03/03 Tattoo: T60N +14547797

#GAR Precision 1680 #Tehama Bando 155  
#Twin Valley Precision E161 9J9 GAR 856  
+WCC Blackcap C9 #SS Traveler 6T6  
Premier Blackcap 6276A

#N Bar Emulation EXT #Emulation N Bar 5522  
#ALC Blackcap E03F N Bar Primrose 2424  
Bon View Blackcap 1330 #VDAR New Trend 315  
Bon View Blackcap 2397

BW	WW	Milk	Comb.	YW		
+4.6 .69	+57 .68	+19 .40	+48	+107 .63		
%IMF	Ribeye	Fat	\$W	\$F	\$G	\$B
+36 .67	+17 .67	+018 .67	+21.57	+44.84	+17.69	+48.84



## LiveAuctions. TV

Real-time bidding is available via the internet. Live audio and live video will allow buyers to bid on Lots just as if they were present at the sale. Go to <http://www.liveauctions.tv>. If you cannot attend the sale because of weather, distance or business conflicts, please use LiveAuctions.tv. Call (sale management) for assistance.

# FALL BULLS

## 1 E&B 3133 New Design 69

**Bull Calved: 8/20/06 Tattoo: 69 15793086**

#B/R New Design 036 #VDAR New Trend 315  
 +E&B New Design 3133 B/R Blackcap Empress 76  
 E&b 6807 Lady Traveler 61 #DHD Traveler 6807  
 Lady 963 Dividend 404

#Bon View New Design 878 #B/R New Design 036  
 +E&B Lady 878 New Design 443 Bon View Gammer 85  
 +E&d Lady 6807 796 #DHD Traveler 6807  
 Lady 183 Traveler 334

CED	BW	WW	YW	Scrotal	CEM	Milk	\$EN	\$W
+11	+0.3	+43	I+73	N/A	+9	+26	+1.35	+31.07
Act. BW	Adj. WW	Adj. YW	%IMF	RE	Fat	\$F	\$G	\$B
65	814	1407	+19	+41	+0.09	+15.65	+18.68	+34.67

• This 3133 son should be an awesome heifer bull. He is out of one of the very best 878 daughters we have raised. This bull scanned very good. Dams WR 2/103.

## 2 E&B 4114 New Design 6208

**Bull Calved: 9/25/06 Tattoo: 6208 15793081**

#Bon View New Design 878 #B/R New Design 036  
 +E&B 878 New Design 4114 Bon View Gammer 85  
 +E&d Lady 6807 796 #DHD Traveler 6807  
 Lady 183 Traveler 334

#Bon View Bando 598 #Tehama Bando 155  
 +E&B 598 Lady Bando 294 #Bon View Dora 56  
 +E&d 1483 Lady Scotchman 797 #RR 9440 Scotch Cap 1483  
 Lady 183 Traveler 334

CED	BW	WW	YW	Scrotal	CEM	Milk	\$EN	\$W
+4	+3.4	+43	I+86	N/A	+6	+26	-2.29	+22.25
Act. BW	Adj. WW	Adj. YW	%IMF	RE	Fat	\$F	\$G	\$B
84	767	1530	-.07	+.36	+.010	+28.55	+6.18	+29.03

• 6208 is a powerful son out of the 4114 bull we raised and was one of the top selling bulls in the 2005 sale going to Leon Eck. We saw how good the 4114 calves were and we bought him back. The 598 daughter, 294, is one of the top cows in the herd. If you need a bull to add power and maternal to your next calf crop, this bull will work. Dams WR 3/106.

## 3 E&B 4114 New Design 6217

**Bull Calved: 10/20/06 Tattoo: 6217 15810769**

#Bon View New Design 878 #B/R New Design 036  
 +E&B 878 New Design 4114 Bon View Gammer 85  
 +E&d Lady 6807 796 #DHD Traveler 6807  
 Lady 183 Traveler 334

+E&B 1680 Precision 2129 #GAR Precision 1680  
 E&B Lady 2129 Precision 485 +E&d 7040 Lady Stacker 671  
 #+E&B Lady 9440 Scotchman 9106 #RR Scotchcap 9440  
 Lady Scotch Traveler 321

CED	BW	WW	YW	Scrotal	CEM	Milk	\$EN	\$W
+5	+4.0	+39	I+70	N/A	+7	+21	+6.43	+21.11
Act. BW	Adj. WW	Adj. YW	%IMF	RE	Fat	\$F	\$G	\$B
82	700	1345	-.07	+.37	+.002	+14.25	+8.98	+23.13

• 6217 is the youngest fall bull and is a typical powerful 4114 son that will work well on cows. Dams WR 1/101.



E&b 6807 Lady Traveler 61  
 Granddam of several of the bull lots.

## 4 FULL BROTHERS E&B 2V1 6201

**Bull Calved: 9/12/06 Tattoo: 6201 +15793074**

CED	BW	WW	YW	Scrotal	CEM	Milk	\$EN	\$W
I+6	I+2.2	I+54	I+98	I+.43	I+9	I+26	-2.98	+32.02
Act. BW	Adj. WW	Adj. YW	%IMF	RE	Fat	\$F	\$G	\$B
84	703	1288	+.29	+.50	+.032	+36.53	+18.22	+45.16

## 5 E&B 2V1 6206

**Bull Calved: 9/09/06 Tattoo: 6206 +15793079**

CED	BW	WW	YW	Scrotal	CEM	Milk	\$EN	\$W
I+6	I+2.2	I+54	I+98	I+.43	I+9	I+26	-2.98	+32.02
Act. BW	Adj. WW	Adj. YW	%IMF	RE	Fat	\$F	\$G	\$B
82	692	1359	+.44	+.46	+.031	+36.53	+22.01	+48.95

## 6 E&B 2V1 6207

**Bull Calved: 9/09/06 Tattoo: 6207 +15793080**

CED	BW	WW	YW	Scrotal	CEM	Milk	\$EN	\$W
I+6	I+2.2	I+54	I+98	I+.43	I+9	I+26	-2.98	+32.02
Act. BW	Adj. WW	Adj. YW	%IMF	RE	Fat	\$F	\$G	\$B
85	668	1377	+.30	+.41	+.032	+36.53	+17.81	+44.75

## 7 E&B 2V1 6210

**Bull Calved: 9/01/06 Tattoo: 6210 +15793083**

#Bon View New Design 1407 #B/R New Design 036  
 +Rito 2V1 of 2536 1407 Bon View Pride 664  
 GAR Precision 2536 #GAR Precision 1680  
 +GAR Ext 2104

#N Bar Emulation EXT #Emulation N Bar 5522  
 +E&B Lady Erica 174 N Bar Primrose 2424  
 E&b 6807 Lady Traveler 61 #DHD Traveler 6807  
 Lady 963 Dividend 404

CED	BW	WW	YW	Scrotal	CEM	Milk	\$EN	\$W
I+6	I+2.2	I+54	I+98	I+.43	I+9	I+26	-2.98	+32.02
Act. BW	Adj. WW	Adj. YW	%IMF	RE	Fat	\$F	\$G	\$B
65	606	1214	+.16	+.63	+.028	+36.53	+15.67	+42.61

• These 2V1 sons out of E&B Lady Erica 174 scanned well and should add strength to their offspring on carcass and maternal. We believe 174 is one of the very best EXT daughters anywhere. Note how she is bred on the bottom side. Werner Angus in Illinois bought the last half of her this winter. We will have many more calves from her in 2008. Dams WR 3/107 and YR 3/101.



E&B Lady Erica 174 - Dam of Lots 4-10 and 60-65

## FULL BROTHERS



SAV 8180 Traveler 004 - Sire of Lots 8-12

### 8 Bull Calved: 9/11/06 Tattoo: 6200 +15793073

CED	BW	WW	YW	Scrotal	CEM	Milk	\$EN	\$W
I+7	I+1.9	I+53	I+93	I+.55	I+9	I+23	+1.54	+33.11
Act. BW	Adj. WW	Adj. YW	%IMF	RE	Fat	\$F		
94	667	1373	-.05	+.37	+.023	+31.74		
								\$G
								+5.80
								\$B
								+31.57

### 9 Bull Calved: 9/11/06 Tattoo: 6204 +15793077

CED	BW	WW	YW	Scrotal	CEM	Milk	\$EN	\$W
I+7	I+1.9	I+53	I+93	I+.55	I+9	I+23	+1.54	+33.11
Act. BW	Adj. WW	Adj. YW	%IMF	RE	Fat	\$F		
82	661	1254	-.12	+.42	+.027	+31.74		
								\$G
								+3.05
								\$B
								+28.82

### 10 Bull Calved: 9/12/06 Tattoo: 6211 +15793084

#Sitz Traveler 8180	#GDAR Traveler 71	\$W						
SAV 8180 Traveler 004	Sitz Everelda Entense 1137	+33.11						
+Boyd Forever Lady 8003	#AAR New Trend	\$F						
	SVF Forever Lady 57D	+31.74						
#N Bar Emulation EXT	#Emulation N Bar 5522	\$G						
+E&B Lady Erica 174	N Bar Primrose 2424	+3.14						
E&b 6807 Lady Traveler 61	#DHD Traveler 6807	\$B						
	Lady 963 Dividend 404	+28.91						
CED	BW	WW	YW	Scrotal	CEM	Milk	\$EN	\$W
I+7	I+1.9	I+53	I+93	I+.55	I+9	I+23	+1.54	+33.11
Act. BW	Adj. WW	Adj. YW	%IMF	RE	Fat	\$F		
86	653	1335	-.13	+.45	+.025	+31.74		
								\$G
								+3.14
								\$B
								+28.91

• These 004 sons out of 174 will be tremendous cow makers. Check them out! Dams WR 3/107 and YR 3/101.

### 11 Bull Calved: 9/12/06 Tattoo: 6209 +15793082

#Sitz Traveler 8180	#GDAR Traveler 71	\$W						
SAV 8180 Traveler 004	Sitz Everelda Entense 1137	+27.49						
+Boyd Forever Lady 8003	#AAR New Trend	\$F						
	SVF Forever Lady 57D	+38.86						
#Bon View Bando 598	#Tehama Bando 155	\$G						
+E&B 598 Lady Bando 292	#Bon View Dora 56	+6.08						
+E&d 1483 Lady Scotchman 797	#RR 9440 Scotch Cap 1483	\$B						
	Lady 183 Traveler 334	+34.99						
CED	BW	WW	YW	Scrotal	CEM	Milk	\$EN	\$W
I+4	I+3.3	I+56	I+101	I+.55	I+7	I+26	-6.59	+27.49
Act. BW	Adj. WW	Adj. YW	%IMF	RE	Fat	\$F		
94	693	1419	-.03	+.35	+.019	+38.86		
								\$G
								+6.08
								\$B
								+34.99

• The dam of Lot 2 bull 294 and this bulls mother 292 are full sisters. The 598 daughters are excellent cows. With 004 on the top side this will take the guess work out of it. If you need to add pounds and maternal, this bull will work. Dams WR 2/116 and YR 2/108.

### 12 Bull Calved: 9/10/06 Tattoo: 6203 +15793076

#Sitz Traveler 8180	#GDAR Traveler 71	\$W
SAV 8180 Traveler 004	Sitz Everelda Entense 1137	+21.21
+Boyd Forever Lady 8003	#AAR New Trend	\$F
	SVF Forever Lady 57D	+28.15
#GAR Precision 1680	#Tehama Bando 155	\$G
E&B Lady Precision 122	9J9 GAR 856	+10.99
E&b Lady 4137 Ext 964	#Gardens EXT 4137 S2	\$B
	Lady High Flyer 598	+34.27

CED	BW	WW	YW	Scrotal	CEM	Milk	\$EN	\$W
I+6	I+3.3	I+44	I+86	I+.54	I+8	I+19	+3.62	+21.21
Act. BW	Adj. WW	Adj. YW	%IMF	RE	Fat	\$F		
90	708	1370	-.02	+.48	+.006	+28.15		
								\$G
								+10.99
								\$B
								+34.27

• This is another top 004 son out of one of our top donors, E&B Lady Precision 122. These 004 sons should be cow makers. Dams WR 4/98.



E&B 598 Lady Bando 292 - Dam of Lot 11

## Trailer Discount

**We will deduct \$50 off the purchase price of each lot if picked up the day of the sale.**

# FALL BULLS

## 13 Bull Calved: 9/11/06 Tattoo: 6205 +15793078

#DHD Traveler 6807 #QAS Traveler 23-4  
 #Rito 616 of 4B20 6807 #Bemindful Maid DHD 0807  
 +Rita 4B20 of OFB1 Bando #Tehama Bando 155  
 +Rita OFB1 of 5H11 Fullback

#GAR Precision 1680		#Tehama Bando 155		\$W				
E&B Lady Precision 122		9J9 GAR 856		+20.53				
E&b Lady 4137 Ext 964		#Gardens EXT 4137 S2		\$F				
		Lady High Flyer 598		+21.62				
CED	BW	WW	YW	Scrotal	CEM	Milk	\$EN	\$G
I+9	I+1.4	I+35	I+76	I-.12	I+8	I+17	+8.06	+16.86
Act. BW	Adj. WW	Adj. YW	%IMF	RE	Fat	\$B		
88	641	1204	+15	+14	+001	+35.12		

\* This 616 should be a very good heifer bull. These 616 sons and daughters are very easy to handle and look outstanding. Dams WR 4/98.

## 14 Bull Calved: 9/06/06 Tattoo: 6212 +15793085

#N Bar Emulation EXT #Emulation N Bar 5522  
 +Wulffs Ext 6106 N Bar Primrose 2424  
 Wulffs Erica Dianna C116 #Tehama Bando 155  
 Wulffs Erica Dianna A308

#GAR Precision 1680		#Tehama Bando 155		\$W				
E&B Lady Precision 221		9J9 GAR 856		+27.15				
E&b Lady 963 Dividend 929		#TC Dividend 963		\$F				
		E&b 1483 Lady Scotchman 709		+22.90				
CED	BW	WW	YW	Scrotal	CEM	Milk	\$EN	\$G
I+9	I+0.8	I+42	I+80	I-.23	I+9	I+23	+1.97	+17.48
Act. BW	Adj. WW	Adj. YW	%IMF	RE	Fat	\$B		
78	628		I+.15	I+.32	I-.001	+35.00		

\* This is a well bred heifer bull. The 221 cow is a very good cow and has worked well as a donor. Full brother to Lots 88-90. Dams WR 2/98 and YR 1/104.

## 15 Bull Calved: 9/06/06 Tattoo: 6202 +15793075

#Gardens Prime Time #RR Traveler 5204  
 Summitcrest High Prime 0H29 #Green Garden Susie 1246 S1  
 Summitcrest Missie 2F55 #Finks 5522-6148  
 #Summitcrest Missie 1C24

#B/R New Design 036		#VDAR New Trend 315		\$W				
E&B Lady New Design 241		B/R Blackcap Empress 76		+24.70				
E&b 1483 Lady Scotchman 709		#RR 9440 Scotch Cap 1483		\$F				
		Lady 107 Rito Traveler 508		+20.69				
CED	BW	WW	YW	Scrotal	CEM	Milk	\$EN	\$G
I+4	I+2.4	I+40	I+77	I+.01	I+6	I+26	+24	+28.19
Act. BW	Adj. WW	Adj. YW	%IMF	RE	Fat	\$B		
88	713	1318	+37	+43	-009	+45.77		

\* This High Prime son will add carcass and maternal. 241 is one of our top 36 daughters and one of our very best donors. Full brother to Lots 31-33. Dams WR 3/103.

## 16 Bull Calved: 9/15/06 Tattoo: 6216 15810768

#GAR Precision 1680 #Tehama Bando 155  
 +E&B 1680 Precision 295 9J9 GAR 856  
 E&b 4137 Lady Dominique 794 #Gardens EXT 4137 S2  
 Lady Scotch Traveler 321

#Gardens EXT 4137 S2		#N Bar Emulation EXT		\$W				
+E&d 4137 Dominique 7115		#Green Garden Bonnie 1134 S1		+22.05				
Enamel 4010 of Dalebanks		#Lemmon Impact		\$F				
		Enamel 2053 of Dalebanks		+15.96				
CED	BW	WW	YW	Scrotal	CEM	Milk	\$EN	\$G
+6	+2.1	+37	I+71	N/A	+7	+17	+9.44	+24.13
Act. BW	Adj. WW	Adj. YW	%IMF	RE	Fat	\$B		
86	686	1442	+34	+26	-001	+38.88		

\* We have used the 295 bull on heifers and have had great success. The 295 sons are moderate with good fleshing ability. Dams WR 2/98.

## 17 Bull Calved: 9/12/06 Tattoo: 6213 15810765

#GAR Precision 1680 #Tehama Bando 155  
 +E&B 1680 Precision 295 9J9 GAR 856  
 E&b 4137 Lady Dominique 794 #Gardens EXT 4137 S2  
 Lady Scotch Traveler 321

#Hilltop Skylar 524		#Pine Drive Big Sky		\$W				
E&b Lady Skylar 8008		#Cedar Hills Blackbird 2011		+22.51				
+E&b 71 Lady Traveler 638		#GDAR Traveler 71		\$F				
		Lady Stacker B184		+12.48				
CED	BW	WW	YW	Scrotal	CEM	Milk	\$EN	\$G
+6	+2.7	+36	I+67	N/A	+7	+21	+7.25	+20.33
Act. BW	Adj. WW	Adj. YW	%IMF	RE	Fat	\$B		
84	718	1415	+20	+35	+000	+32.52		

\* This is a top 295 son that will not be hard to pick out. Dams WR 3/106.

## 18 Bull Calved: 9/29/06 Tattoo: 6215 15810767

#GAR Precision 1680 #Tehama Bando 155  
 +E&B 1680 Precision 295 9J9 GAR 856  
 E&b 4137 Lady Dominique 794 #Gardens EXT 4137 S2  
 Lady Scotch Traveler 321

+E&d 6807 793		#DHD Traveler 6807		\$W				
E&B Blackbird Eve		Lady 183 Traveler 334		+19.84				
+E&B Lady 131 Royce 9109		#+GDAR Royce 131		\$F				
		Lady Scotch Traveler 345		+16.34				
CED	BW	WW	YW	Scrotal	CEM	Milk	\$EN	\$G
+7	+2.8	+36	I+71	N/A	+6	+17	+9.44	+22.15
Act. BW	Adj. WW	Adj. YW	%IMF	RE	Fat	\$B		
85	682	1344	+24	+34	-008	+36.89		

\* You will like these easy fleshing 295 sons. Dams WR 2/100.

## 19 Bull Calved: 9/25/06 Tattoo: 6220 15810770

#GAR Precision 1680 #Tehama Bando 155  
 +E&B 1680 Precision 295 9J9 GAR 856  
 E&b 4137 Lady Dominique 794 #Gardens EXT 4137 S2  
 Lady Scotch Traveler 321

CH Quantum 5502		#CH Quantum 3330		\$W				
E&b 5502 Lady Quantum 72		Cedar Hills Blackbird 8036		+22.16				
Lady 1483 High Rise 411		#RR 9440 Scotch Cap 1483		\$F				
		Lady Stacker B162		+10.58				
CED	BW	WW	YW	Scrotal	CEM	Milk	\$EN	\$G
+7	+2.3	+36	I+65	N/A	+6	+16	+11.89	+29.54
Act. BW	Adj. WW	Adj. YW	%IMF	RE	Fat	\$B		
84	696	1353	+46	+39	-002	+40.38		

\* Another typical 295 son that is made right. Dams WR 1/101.

# LiveAuctions. TV

Real-time bidding is available via the internet. Live audio and live video will allow buyers to bid on Lots just as if they were present at the sale. Go to <http://www.liveauctions.tv>. If you cannot attend the sale because of weather, distance or business conflicts, please use LiveAuctions.tv. Call (sale management) for assistance.

# E & B SPRING BULLS

## 20 Bull Calved: 2/02/07 Tattoo: 720 15807842

#B/R New Design 036 #VDAR New Trend 315  
GAR Predestined B/R Blackcap Empress 76  
#+GAR Ext 4206 #N Bar Emulation EXT  
+GAR 6807 Traveler 1432

#GAR Precision 1680	#Tehama Bando 155	\$W
E&B Lady Precision 144	9J9 GAR 856	+21.88
E&b Lady 4137 Ext 904	#Gardens EXT 4137 S2	\$F
	E&b 5502 Lady Quantum 720	+32.71
CED I+8	BW I+4.1	WW I+48
YW I+92	Scrotal I+.10	CEM I+7
Milk I+23	\$EN -1.42	\$G
		+30.25
Act. BW	Adj. WW	Adj. YW
95	762	1391
%IMF	RE	Fat
I+.54	I+.58	I+.006
		\$B
		+59.35

• If you need to upgrade your carcass numbers and maternal traits this bull will work. Predestined has worked well on our Precision daughters. Dams WR 4/99.

## 21 Bull Calved: 2/25/07 Tattoo: 721 15794745

#Bon View New Design 878 #B/R New Design 036  
+E&B 878 New Design 4114 Bon View Gammer 85  
+E&d Lady 6807 796 #DHD Traveler 6807  
Lady 183 Traveler 334

#GAR Precision 1680	#Tehama Bando 155	\$W
+E&B Lady Precision 321	9J9 GAR 856	+26.63
E&b 5667 Lady Regal 788	CH Regal 5667	\$F
	Lady 963 Dividend 404	+15.21
CED I+10	BW I+0.7	WW I+39
YW I+71	Scrotal N/A	CEM I+10
Milk I+20	\$EN +6.99	\$G
		+18.38
Act. BW	Adj. WW	Adj. YW
77	722	1311
%IMF	RE	Fat
I+.16	I+.35	I+.001
		\$B
		+33.14

• 721 is a really good 4114 son. The 321 cow is a very good cow. Dams WR 3/97.

## 22 Bull Calved: 2/17/07 Tattoo: 722 15794746

#Bon View New Design 878 #B/R New Design 036  
+E&B 878 New Design 4114 Bon View Gammer 85  
+E&d Lady 6807 796 #DHD Traveler 6807  
Lady 183 Traveler 334

#GAR Precision 1680	#Tehama Bando 155	\$W
+E&B Lady Precision 3138	9J9 GAR 856	+19.58
+E&b 1483 Lady Scotchman 826	#RR 9440 Scotch Cap 1483	\$F
	Lady 228 Stepahead 473	+25.62
CED I+7	BW I+2.3	WW I+35
YW I+80	Scrotal I+.22	CEM I+8
Milk I+23	\$EN +1.97	\$G
		+11.99
Act. BW	Adj. WW	Adj. YW
83	686	1390
%IMF	RE	Fat
I+.04	I+.54	I+.019
		\$B
		+31.92

• These 4114 sons are very good and well balanced with good carcass and excellent scrotal. Dams WR 2/98.

## 23 Bull Calved: 1/29/07 Tattoo: 723 15807843

#+Leachman Right Time #N Bar Emulation EXT  
Hyline Right Time 338 Leachman Erica 0025  
Hyline Pride 265 +Hyline SVF Traveler 0115  
Hyline Pride 870

+HA Power Alliance 1025	#Sitz Alliance 6595	\$W
E&B Lady Power Alliance 371	+HA Rito Lady 4167	+28.47
E&b Everelda Queen 0104	#GDAR Rainmaker 340	\$F
	+E&b Lady Ext 887	+26.03
CED I+5	BW I+3.5	WW I+52
YW I+87	Scrotal N/A	CEM I+5
Milk I+27	\$EN -3.44	\$G
		+18.79
Act. BW	Adj. WW	Adj. YW
92	788	1334
%IMF	RE	Fat
I+.22	I+.25	I-.006
		\$B
		+42.24

• If you need to add maternal traits and growth this bull will work. This bull has tremendous cows in the pedigree. Dams WR 3/104.

## 24 Bull Calved: 1/30/07 Tattoo: 724 +15814340

#GAR Precision 1680 #Tehama Bando 155  
+E&B 1680 Precision 1023 9J9 GAR 856  
E&b 6807 Lady Traveler 61 #DHD Traveler 6807  
Lady 963 Dividend 404

#Bon View New Design 878	#B/R New Design 036	\$W
E&B Primrose Lady 332	Bon View Gammer 85	+27.08
+E&B Everelda Maid 143	#Sitz Traveler 9929	\$F
	Lady Stacker 308	+22.29
CED I+9	BW I+0.4	WW I+41
YW I+79	Scrotal I-.38	CEM I+11
Milk I+23	\$EN +2.25	\$G
		+26.09
Act. BW	Adj. WW	Adj. YW
78	686	1228
%IMF	RE	Fat
I+.32	I+.68	I-.003
		\$B
		+45.50

• Dams WR 2/104.



E&B 1023 Precision 7107 - Lot 25

## 25 Bull Calved: 1/28/07 Tattoo: 7107 +15814338

#GAR Precision 1680 #Tehama Bando 155  
+E&B 1680 Precision 1023 9J9 GAR 856  
E&b 6807 Lady Traveler 61 #DHD Traveler 6807  
Lady 963 Dividend 404

#Bon View New Design 878	#B/R New Design 036	\$W
E&B Primrose Lady 332	Bon View Gammer 85	+29.94
+E&B Everelda Maid 143	#Sitz Traveler 9929	\$F
	Lady Stacker 308	+36.53
CED I+9	BW I+1.5	WW I+54
YW I+98	Scrotal I-.38	CEM I+11
Milk I+23	\$EN -3.15	\$G
		+24.44
Act. BW	Adj. WW	Adj. YW
87	827	1475
%IMF	RE	Fat
I+.32	I+.68	I-.003
		\$B
		+52.77

• The two 1023 sons out of the 332 cow can be your next herd bulls. The 332 cow is in a joint embryo transplant program with Tim Henricks in OK. The 7107 bull will be one of the better bulls selling this spring. Outstanding herd bull. Dams WR 2/104.



E&B Primrose Lady 332 - Dam of Lots 24 & 25

## 26 Bull Calved: 2/03/07 Tattoo: 726 15807844

#SS Traveler 6807 T510 #DHD Traveler 6807  
 GAR Solution #SS Miss Hi Spade A114  
 +GAR New Design 50 #B/R New Design 036  
 GAR Precision 2536

LD Exactly 1912	#GAR Precision 1680	\$W
E&B Lady Exactly 567	+LD Pride 1489 9124	+27.96
E&B Lady Popatop 368	RR Popatop 0600	\$F
	+E&b Queen Princess 084	+31.05
CED I+11	BW I+0.8	WW I+47
YW I+90	Scrotal N/A	CEM I+7
Milk I+23	\$EN -85	\$G
		+22.43
Act. BW 75	Adj. WW 720	Adj. YW 1293
%IMF I+.33	RE I+.44	Fat I-.009
		\$B
		+42.93

• This calving ease son of Solution should work well on heifers. Dams WR 1/100.



E&B Retail Product 7125

## 27 Bull Calved: 3/27/07 Tattoo: 7180 15794737

+B/R New Frontier 095 #B/R New Design 036  
 LD Hawkeye 211 White Fence Pride H1  
 #LD 6807 Pride 9211 #DHD Traveler 6807  
 Molitor 473 Pride 8432

#GAR Precision 1680	#Tehama Bando 155	\$W
E&B Lady Precision 2119	9J9 GAR 856	+25.03
+E&b 71 Lady Traveler 631	#GDAR Traveler 71	\$F
	Lady Stacker B184	+17.31
CED I+9	BW I+0.4	WW I+36
YW I+72	Scrotal N/A	CEM I+9
Milk I+22	\$EN +5.04	\$G
		+28.41
Act. BW 80	Adj. WW 764	Adj. YW
%IMF I+.51	RE I+.30	Fat I+.007
		\$B
		+43.75

• This is a really good Hawkeye son with lots of eye appeal. This will be a good front pasture bull for your heifers. Dams WR 3/105.

## 28 Bull Calved: 2/25/07 Tattoo: 728 15794748

#B/R New Design 036 #VDAR New Trend 315  
 +E&B New Design 3133 B/R Blackcap Empress 76  
 E&b 6807 Lady Traveler 61 #DHD Traveler 6807  
 Lady 963 Dividend 404

#Connealy Freightliner	#Bon View Bando 598	\$W
E&B Lady Freightliner 504	Joana Erica of Conanga	+26.12
+E&d 71 Lady Traveler 7010	#GDAR Traveler 71	\$F
	#Lady 1483 High Rise 470	+14.40
CED I+9	BW I+0.7	WW I+36
YW I+69	Scrotal N/A	CEM I+9
Milk I+24	\$EN +4.17	\$G
		+13.39
Act. BW 72	Adj. WW 689	Adj. YW 1278
%IMF I+.10	RE I+.07	Fat I+.006
		\$B
		+26.88

• These 3133 sons will work great on virgin heifers. Dams WR 1/94.

## 29 Bull Calved: 2/27/07 Tattoo: 729 15807846

+B/R New Frontier 095 #B/R New Design 036  
 LD Hawkeye 211 White Fence Pride H1  
 #LD 6807 Pride 9211 #DHD Traveler 6807  
 Molitor 473 Pride 8432

#GAR Precision 1680	#Tehama Bando 155	\$W
#E&B Lady Precision 137	9J9 GAR 856	+21.62
+E&B Lady 131 Royce 982	#GDAR Royce 13	\$F
	Lady Scotch Traveler 345	+21.02
CED I+8	BW I+1.2	WW I+34
YW I+75	Scrotal I+.52	CEM I+7
Milk I+21	\$EN +5.05	\$G
		+21.40
Act. BW 80	Adj. WW 712	Adj. YW 1298
%IMF I+.30	RE I+.26	Fat I+.007
		\$B
		+38.47

• Hawkeye 211 has worked very well on heifers and his sons should work as well. The 137 cow is a very good cow. Dams WR 105.

## 30 Bull Calved: 2/02/07 Tattoo: 7125 +15797076

#GAR Precision 1680 #Tehama Bando 155  
 GAR Retail Product 9J9 GAR 856  
 +GAR Ext 4927 #N Bar Emulation EXT  
 GAR Traveler 641

#B/R New Design 036	#VDAR New Trend 315	\$W
E&B Lady New Design 241	B/R Blackcap Empress 76	+22.31
E&b 1483 Lady Scotchman 709	#RR 9440 Scotch Cap 1483	\$F
	Lady 107 Rito Traveler 508	+29.96
CED I+5	BW I+3.1	WW I+42
YW I+87	Scrotal I+.77	CEM I+5
Milk I+28	\$EN -4.32	\$G
		+26.41
Act. BW 90	Adj. WW 738	Adj. YW 1346
%IMF I+.36	RE I+.50	Fat I+.002
		\$B
		+51.02

• 7125 is another tremendous herd bull prospect out of one of our top donor cows. 241, who is the dam of Lots 30-36 and Lot 15, has great cows in her pedigree. It doesn't take long to tell how good a cow is when you breed her to several sires and her calves are all good. LaVern Koupal purchased one of the top 1023 sons in our 2007 sale out of 241. Dams WR 3/103.



**Benoit Angus will be retaining  
 1/3 revenue sharing interest in  
 all bulls selling.**



# SPRING BULLS



## FULL BROTHERS

### **31** Bull Calved: 1/24/07 Tattoo: 797 +15796161

CED	BW	WW	YW	Scrotal	CEM	Milk	\$EN	\$W
I+4	I+2.4	I+40	I+77	I+.01	I+6	I+26	+.24	+24.70
Act. BW	Adj. WW	Adj. YW	%IMF	RE	Fat	\$F		
82	773	1271	I+.27	I+.38	I-.014	+20.69		
								\$G
								+31.20
								\$B
								+46.53

### **32** Bull Calved: 1/22/07 Tattoo: 7111 +15796155

CED	BW	WW	YW	Scrotal	CEM	Milk	\$EN	\$W
I+4	I+2.4	I+40	I+77	I+.01	I+6	I+26	+.24	+24.70
Act. BW	Adj. WW	Adj. YW	%IMF	RE	Fat	\$F		
78	709	1263	I+.27	I+.38	I-.014	+20.69		
								\$G
								+31.20
								\$B
								+46.53

### **33** Bull Calved: 1/18/07 Tattoo: 7118 +15796158

#Gardens Prime Time	#RR Traveler 5204							\$W
Summitcrest High Prime 0H29	#Green Garden Susie 1246 S1							+24.70
Summitcrest Missie 2F55	#Finks 5522-6148							\$F
	#Summitcrest Missie 1C24							+20.69
#B/R New Design 036	#VDAR New Trend 315							\$G
E&B Lady New Design 241	B/R Blackcap Empress 76							+31.20
E&b 1483 Lady Scotchman 709	#RR 9440 Scotch Cap 1483							\$B
	Lady 107 Rito Traveler 508							+46.53
CED	BW	WW	YW	Scrotal	CEM	Milk	\$EN	
I+4	I+2.4	I+40	I+77	I+.01	I+6	I+26	+.24	
Act. BW	Adj. WW	Adj. YW	%IMF	RE	Fat			
84	793	1358	I+.27	I+.38	I-.014			

\* These High Prime sons out of the 241 cow are very good. They will add carcass, growth, and maternal to your next calf crop. Dams WR 3/103.

## FULL BROTHERS

### **34** Bull Calved: 2/01/07 Tattoo: 796 +15797090

CED	BW	WW	YW	Scrotal	CEM	Milk	\$EN	\$W
I+9	I+2.2	I+44	I+93	I+.50	I+9	I+26	-4.28	+23.53
Act. BW	Adj. WW	Adj. YW	%IMF	RE	Fat	\$F		
85	692	1361	I+.24	I+.42	I-.001	+35.35		
								\$G
								+21.89
								\$B
								+47.51

### **35** Bull Calved: 1/30/07 Tattoo: 7120 +15797072

CED	BW	WW	YW	Scrotal	CEM	Milk	\$EN	\$W
I+9	I+2.2	I+44	I+93	I+.50	I+9	I+26	-4.28	+23.53
Act. BW	Adj. WW	Adj. YW	%IMF	RE	Fat	\$F		
92	742	1323	I+.24	I+.42	I-.001	+35.35		
								\$G
								+21.89
								\$B
								+47.51

### **36** Bull Calved: 1/29/07 Tattoo: 7122 +15797074

#GAR Precision 1680	#Tehama Bando 155							\$W
+GAR Yield Grade	9J9 GAR 856							+23.53
+GAR Ext 4526	#N Bar Emulation EXT							\$F
	+GAR 6807 Traveler 93							+35.35
#B/R New Design 036	#VDAR New Trend 315							\$G
E&B Lady New Design 241	B/R Blackcap Empress 76							+21.89
E&b 1483 Lady Scotchman 709	#RR 9440 Scotch Cap 1483							\$B
	Lady 107 Rito Traveler 508							+47.51
CED	BW	WW	YW	Scrotal	CEM	Milk	\$EN	
I+9	I+2.2	I+44	I+93	I+.50	I+9	I+26	-4.28	
Act. BW	Adj. WW	Adj. YW	%IMF	RE	Fat			
84	798	1417	I+.24	I+.42	I-.001			

\* These Yield Grade sons out of 241 will also add tremendous growth, carcass and maternal to your next calf crop. We needed to take more pictures, but due to the time and mud it did not work. Dams WR 3/103.

### Repeat Buyer Discount

To show our appreciation for the support of our loyal repeat customers over the years, we are starting a Repeat buyer discount. This discount will be 5% from your total purchase price if you purchased a bull in the prior years sale. This discount will involve only the previous years sale, not just any previous sale. If you didn't purchase a bull last year, but purchase a bull this year, you'll receive a 5% discount on your purchase in next year's sale should you decide to be a repeat customer. This will be an on going process that will continue in up coming years. With this new repeat buyer credit, we will discontinue the volume discounts we have given in the past. Also, the 5% discount will be determined after all credits have been subtracted from the gross purchase price.

### **37** Bull Calved: 2/23/07 Tattoo: 737 15794752

#Bon View New Design 878	#B/R New Design 036							\$W
+E&B 878 New Design 4114	Bon View Gammer 85							+23.98
+E&d Lady 6807 796	#DHD Traveler 6807							\$F
	Lady 183 Traveler 334							+14.99
#GAR Precision 1680	#Tehama Bando 155							\$G
+E&B Lady Precision 2156	9J9 GAR 856							+15.91
+E&d 7040 Lady Stacker 671	#CH Stacker 7040							\$B
	Lady Traveler B148							+30.04
CED	BW	WW	YW	Scrotal	CEM	Milk	\$EN	
I+8	I+2.1	I+37	I+70	I+.58	I+7	I+22	+5.59	
Act. BW	Adj. WW	Adj. YW	%IMF	RE	Fat			
83	724	1265	I+.08	I+.57	I+.011			

\* The sire of this bull, 4114, is one of the bulls we have raised and his sons are very good also. Dams WR 4/102.

# E & B SPRING BULLS

## 38 Bull Calved: 2/13/07 Tattoo: 738 15794753

+B/R New Frontier 095 #B/R New Design 036  
 LD Hawkeye 211 White Fence Pride H1  
 #LD 6807 Pride 9211 #DHD Traveler 6807  
 Molitor 473 Pride 8432

LD Exactly 1912		#GAR Precision 1680		\$W				
E&B Lady Exactly 471		+LD Pride 1489 9124		+25.36				
+E&B 598 Lady Bando 294		#Bon View Bando 598		\$F				
		+E&d 1483 Lady Scotchman 797		+29.8				
CED	BW	WW	YW	Scrotal	CEM	Milk	\$EN	\$G
I+7	I+3.3	I+50	I+90	N/A	I+7	I+22	-.01	+17.40
Act. BW	Adj. WW	Adj. YW	%IMF		RE	Fat	\$B	
91	794	1348	I+.16		I+.52	I+.004	+42.30	

• This is one of the best Hawkeye sons selling. Note his grand dam 294 is the dam of the Lot 2 bull. Great cows in this pedigree. Dams WR 1/110.

## 39 Bull Calved: 2/25/07 Tattoo: 739 15794754

#Bon View New Design 878 #B/R New Design 036  
 +E&B 878 New Design 4114 Bon View Gammer 85  
 +E&d Lady 6807 796 #DHD Traveler 6807  
 Lady 183 Traveler 334

#GDAR Rainmaker 340		#Lovana		\$W				
E&B Everelda Queen 381		#Lady Blackbird 987 GDAR		+23.03				
+E&B Lady Precision 15		#GAR Precision 1680		\$F				
		E&b 6807 Lady Traveler 61		+15.53				
CED	BW	WW	YW	Scrotal	CEM	Milk	\$EN	\$G
I+8	I+1.5	I+33	I+69	I+.52	I+8	I+24	+4.17	+15.13
Act. BW	Adj. WW	Adj. YW	%IMF		RE	Fat	\$B	
85	679	1324	I+.10		I+.31	I+.008	+28.59	

• Another good son of 4114. Note the cows in the pedigree on the bottom side. The grand dam, Lady Precision 15, was the donor of the good Predestined bulls that sold in our 2007 sale. Dams WR 3/97.

## 40 Bull Calved: 2/21/07 Tattoo: 754 +15797084

#DHD Traveler 6807 #QAS Traveler 23-4  
 #Rito 616 of 4B20 6807 #Bemindful Maid DHD 0807  
 +Rita 4B20 of 0FB1 Bando #Tehama Bando 155  
 +Rita 0FB1 of 5H11 Fullback

#B/R New Design 036		#VDAR New Trend 315		\$W				
+E&B Lady New Design 2120		B/R Blackcap Empress 76		+25.80				
+E&d 1483 Lady Scotchman 797		#RR 9440 Scotch Cap 1483		\$F				
		Lady 183 Traveler 334		+33.74				
CED	BW	WW	YW	Scrotal	CEM	Milk	\$EN	\$G
I+8	I+2.0	I+48	I+93	I+.09	I+6	I+22	-.87	+20.17
Act. BW	Adj. WW	Adj. YW	%IMF		RE	Fat	\$B	
83	796	1390	I+.09		I+.45	I+.009	+44.42	

• 754 is a super herd bull prospect out of Rito 616, the great female producing bull that sires great dispositions. The 2120 cow is a tremendous 036 cow that looks at feed and gains weight. Dr. Gray at Cross Country Genetics, said they had to put her on a diet to keep her weight down. Easy keeping cows that will produce and are great assets to any cow herd. You will not miss this bull in the pen. Dams WR 2/103.

## 41 Bull Calved: 2/04/07 Tattoo: 741 15794756

#B/R New Design 036 #VDAR New Trend 315  
 +E&B New Design 3133 B/R Blackcap Empress 76  
 E&b 6807 Lady Traveler 61 #DHD Traveler 6807  
 Lady 963 Dividend 404

+SAF Strategy 9015		#SAF Focus of ER		\$W				
E&B Lady Strategy 523		+SAF Royal Queen 5084		+25.47				
E&B Lady Cornerstone 354		+HD Dunn Cornerstone 0245		\$F				
		+E&b Lady Erica 077		+20.15				
CED	BW	WW	YW	Scrotal	CEM	Milk	\$EN	\$G
I+8	I+2.8	I+44	I+78	N/A	I+9	I+22	+3.38	+18.32
Act. BW	Adj. WW	Adj. YW	%IMF		RE	Fat	\$B	
83	722	1268	I+.26		I+.18	I+.013	+37.21	

• These 3133 sons are moderate framed, easy fleshing, calving ease bulls. We are calving the 1st 3133 heifers. They have beautiful udders and are the right size in our opinion. The 61 and the 404 cows are great cows. Dams WR 1/96.

## 42 Bull Calved: 2/15/07 Tattoo: 742 15794757

#B/R New Design 036 #VDAR New Trend 315  
 +E&B New Design 3133 B/R Blackcap Empress 76  
 E&b 6807 Lady Traveler 61 #DHD Traveler 6807  
 Lady 963 Dividend 404

KCF Bennett Coalition SCC		#Sitz Alliance 6595		\$W				
E&B Lady Coalition 5014		#Pleasant Pill of Conanga		+28.65				
E&b 4137 Lady Dominett 862		#Gardens EXT 4137 S2		\$F				
		Lady 90 Stacker 339		+16.40				
CED	BW	WW	YW	Scrotal	CEM	Milk	\$EN	\$G
I+8	I+0.5	I+41	I+73	N/A	I+8	I+23	+3.92	+14.18
Act. BW	Adj. WW	Adj. YW	%IMF		RE	Fat	\$B	
73	737	1278	I+.19		I+.04	I+.019	+30.15	

• You will really appreciate these 3133 sons when you see them on virgin heifers. Dams WR 1/100.



E&B Lady New Design 2120 - Dam of Lot 40



E&B 616 754 - Lot 40

# B SPRING BULLS B

## FULL BROTHERS

### 43 Bull Calved: 1/31/07 Tattoo: 781 +15807856

#### E&B Predestined 781

CED	BW	WW	YW	Scrotal	CEM	Milk	\$EN	\$W
I+9	I+2.1	I+49	I+91	I+.05	I+9	I+22	+.04	+27.22
Act. BW	Adj. WW	Adj. YW	%IMF	RE	Fat			\$F
81	767	1428	I+.49	I+.48	I+.014			+31.28
								\$G
								+29.13
								\$B
								+56.82

### 44 Bull Calved: 2/02/07 Tattoo: 795 +15797089

#### E&B Predestined 795

#B/R New Design 036		#VDAR New Trend 315						
GAR Predestined		B/R Blackcap Empress 76						
#+GAR Ext 4206		#N Bar Emulation EXT						
		+GAR 6807 Traveler 1432						
#GAR Precision 1680		#Tehama Bando 155		\$W				
#E&b Lady 1680 Precision 921		9J9 GAR 856		+26.98				
E&b 5667 Lady Regal 788		CH Regal 5667		\$F				
		Lady 963 Dividend 404		+23.35				
CED	BW	WW	YW	Scrotal	CEM	Milk	\$EN	\$G
I+9	I+2.4	I+46	I+82	I+.05	I+9	I+22	+2.59	+29.76
Act. BW	Adj. WW	Adj. YW	%IMF	RE	Fat			\$B
85	708	1266	I+.49	I+.48	I+.014			+54.83

\* These two Predestined sons of Precision 921 are very good. Predestined has worked well on our Precision daughters. Dams WR 7/105 and YR 6/101.



GAR Predestined - Sire of Lots 43-44

### 45 Bull Calved: 2/19/07 Tattoo: 798 +15797091

#### E&B Predestined 798

#B/R New Design 036		#VDAR New Trend 315						
GAR Predestined		B/R Blackcap Empress 76						
#+GAR Ext 4206		#N Bar Emulation EXT						
		+GAR 6807 Traveler 1432						
#GAR Precision 1680		#Tehama Bando 155		\$W				
+E&B Lady Precision 15		9J9 GAR 856		+25.97				
E&b 6807 Lady Traveler 61		#DHD Traveler 6807		\$F				
		Lady 963 Dividend 404		+28.78				
CED	BW	WW	YW	Scrotal	CEM	Milk	\$EN	\$G
I+8	I+2.2	I+45	I+87	I-.02	I+7	I+26	-2.57	+31.35
Act. BW	Adj. WW	Adj. YW	%IMF	RE	Fat			\$B
82	754	1336	I+.61	I+.62	I+.025			+58.26

\* 798 is a full brother to three of our top selling bulls in 2007. One going to Koupal Angus in SD and Daniel & Son, TX; one to Valley View in IA and NY and one to Dean Christenson in NE. Predestined has worked well here especially on our Precision daughters. Dams WR 3/105.



E&B Predestined 798 - Lot 45



E&B Lady Precision 15 - Dam of Lot 45



### Trailer Discount

**We will deduct \$50 off the purchase price of each lot if picked up the day of the sale.**

## 46 Bull Calved: 2/20/07 Tattoo: 700 15794677

+B/R New Frontier 095 #B/R New Design 036  
 LD Hawkeye 211 White Fence Pride H1  
 #LD 6807 Pride 9211 #DHD Traveler 6807  
 Molitor 473 Pride 8432

#CA Future Direction 5321 #GAR Precision 1680  
 +E&B Lady Direction 469 CA Miss Power Fix 308  
 E&b 1483 Lady Scotchman 709 #RR 9440 Scotch Cap 1483  
 Lady 107 Rito Traveler 508

CED	BW	WW	YW	Scrotal	CEM	Milk	\$EN
I+8	I+1.5	I+35	I+74	N/A	I+7	I+25	+1.94
							\$W
							+23.41
							\$F
							+19.65
							\$G
							+26.79
							\$B
							+43.29

• This well bred Hawkeye son is out of a very good Future Direction daughter and should work well on heifers. Lady Scotchman 709 was a great donor and is also the dam of Lady Design 241. 241 is the mother of Lots 30-36 and Lot 15. Dams WR 2/105.

## 47 Bull Calved: 2/19/07 Tattoo: 701 15794678

#Bon View New Design 878 #B/R New Design 036  
 +E&B 878 New Design 4114 Bon View Gammer 85  
 +E&d Lady 6807 796 #DHD Traveler 6807  
 Lady 183 Traveler 334

+LD Axis 1410 #Bon View Bando 598  
 E&B Lady 1410 Axis 498 Hinksons Erica 9310  
 E&B Lady Popatop 231 RR Popatop 0600  
 E&B Forever Lady 025

CED	BW	WW	YW	Scrotal	CEM	Milk	\$EN
I+10	I+1.8	I+37	I+75	N/A	I+10	I+23	+3.37
							\$W
							+23.50
							\$F
							+19.87
							\$G
							+8.23
							\$B
							+25.30

• This is another well bred bull that should work great. He will also produce great replacements. Dams WR 2/93.

## 48 Bull Calved: 1/28/07 Tattoo: 702 15807829

#Bon View New Design 878 #B/R New Design 036  
 +Rito 2 878 of 2536 BVND 878 Bon View Gammer 85  
 GAR Precision 2536 #GAR Precision 1680  
 +GAR Ext 2104

+HA Power Alliance 1025 #Sitz Alliance 6595  
 E&B Lady Power Alliance 4145 +HA Rito Lady 4167  
 E&b Lady 4137 Ext 918 #Gardens EXT 4137 S2  
 E&b 5667 Lady Regal 781

CED	BW	WW	YW	Scrotal	CEM	Milk	\$EN
I+6	I+1.9	I+42	I+77	I+.70	I+7	I+25	+1.10
							\$W
							+26.96
							\$F
							+19.93
							\$G
							+20.57
							\$B
							+38.95

• We used Rito 2-878 AI on a few cows and we like what we see. Dams WR 2/100.

## 49 Bull Calved: 1/31/07 Tattoo: 703 15807830

#SS Traveler 6807 T510 #DHD Traveler 6807  
 GAR Solution #SS Miss Hi Spade A114  
 +GAR New Design 50 #B/R New Design 036  
 GAR Precision 2536

GAR Retail Product #GAR Precision 1680  
 E&B Lady Retail Product 583 +GAR Ext 4927  
 +E&b 71 Lady Traveler 631 #GDAR Traveler 71  
 Lady Stacker B184

CED	BW	WW	YW	Scrotal	CEM	Milk	\$EN
I+11	I+0.7	I+32	I+74	N/A	I+8	I+23	+3.64
							\$W
							+21.46
							\$F
							+20.79
							\$G
							+29.21
							\$B
							+45.30

• This well bred bull should work great on heifers. The replacements and carcass should be very good also. Dams WR 1/85.

Gentlemen,

It is my pleasure to have worked with the Benoit's nutrition program and this set of outstanding bulls. My philosophy over the past 17 years is that bull development diets should be formulated too promote fiber digestion, increase feed intake and result in excellent ADG. Experience has shown bulls fed high fiber/forage diets hold up better on pasture, stacking additional value on your genetic investment. To accomplish our feeding goals we developed these bulls on a diet consisting of Alfalfa hay, Sorghum Hay, CRP Hay, Corn Silage, Corn, and supplement that contained DDGS, Soybean meal, and Vita-Ferm mineral.

Please contrast this approach with simply increasing the amount of grain fed to put the bulls in sale condition. Many of us have had the unpleasant experience of purchasing a high value bull, only to be disappointed later as the bull falls apart on a forage diet. You have my confidence that these bulls will be solid performers, who will work hard, and stay in the herd for many years. Feel free to give me a call for more information and buy great genetics today with the utmost confidence.

Sincerely,

*Kevin Glaubius (308)-233-4012*

**The Spring bulls have not been fed any creep. The bulls were fed a high roughage ration to gain 3.5 lbs. per day to ensure soundness. Ultrasound data and daily gains will be available, on a supplemental sheet, by the 1st of March.**

# B SPRING BULLS B

## FULL BROTHERS

**50** Bull **E&B Predestined 750**  
 Calved: 1/21/07 Tattoo: 750 +15797081

CED	BW	WW	YW	Scrotal	CEM	Milk	\$EN	\$W
I+8	I+3.0	I+44	I+86	N/A	I+7	I+25	-1.42	+23.60
Act. BW	Adj. WW	Adj. YW	%IMF	RE	Fat	\$F	\$G	\$B
86	677	1218	I+.44	I+.67	I+.013	+28.15	+30.24	+56.86

**51** Bull **E&B Predestined 716**  
 Calved: 1/31/07 Tattoo: 716 +15797078

CED	BW	WW	YW	Scrotal	CEM	Milk	\$EN	\$W
I+8	I+2.6	I+43	I+85	N/A	I+7	I+25	-1.14	+24.00
Act. BW	Adj. WW	Adj. YW	%IMF	RE	Fat	\$F	\$G	\$B
80	705	1257	I+.44	I+.67	I+.013	+27.53	+30.31	+56.59

**52** Bull **E&B Predestined 747**  
 Calved: 2/02/07 Tattoo: 747 +15797080

CED	BW	WW	YW	Scrotal	CEM	Milk	\$EN	\$W
I+8	I+3.8	I+44	I+90	N/A	I+7	I+25	-2.56	+20.73
Act. BW	Adj. WW	Adj. YW	%IMF	RE	Fat	\$F	\$G	\$B
92	736	1363	I+.44	I+.67	I+.013	+32.24	+29.95	+57.68

**53** Bull **E&B Predestined 7102**  
 Calved: 1/23/07 Tattoo: 7102 +15797062

CED	BW	WW	YW	Scrotal	CEM	Milk	\$EN	\$W
I+8	I+3.9	I+43	I+86	N/A	I+7	I+25	-1.42	+20.92
Act. BW	Adj. WW	Adj. YW	%IMF	RE	Fat	\$F	\$G	\$B
93	715	1283	I+.44	I+.67	I+.013	+28.55	+30.24	+54.31

**54** Bull **E&B Predestined 7108**  
 Calved: 2/03/07 Tattoo: 7108 +15797065

CED	BW	WW	YW	Scrotal	CEM	Milk	\$EN	\$W
I+8	I+2.4	I+35	I+77	N/A	I+7	I+25	+1.10	+20.74
Act. BW	Adj. WW	Adj. YW	%IMF	RE	Fat	\$F	\$G	\$B
85	594	1132	I+.44	I+.67	I+.013	+22.61	+30.79	+54.31

**55** Bull **E&B Predestined 7116**  
 Calved: 2/01/07 Tattoo: 7116 +15797069

CED	BW	WW	YW	Scrotal	CEM	Milk	\$EN	\$W
I+8	I+3.4	I+46	I+92	N/A	I+7	I+25	-3.13	+22.49
Act. BW	Adj. WW	Adj. YW	%IMF	RE	Fat	\$F	\$G	\$B
88	765	1389	I+.44	I+.67	I+.013	+33.51	+29.83	+58.32

**56** Bull **E&B Predestined 756**  
 Calved: 2/01/07 Tattoo: 756 +15797085

CED	BW	WW	YW	Scrotal	CEM	Milk	\$EN	\$W
I+8	I+3.8	I+49	I+91	N/A	I+7	I+25	-2.85	+24.07
Act. BW	Adj. WW	Adj. YW	%IMF	RE	Fat	\$F	\$G	\$B
90	783	1332	I+.44	I+.67	I+.013	+31.28	+29.89	+58.01

**57** Bull **E&B Predestined 757**  
 Calved: 2/02/07 Tattoo: 757 +15797086

#B/R New Design 036	#VDAR New Trend 315	\$W						
GAR Predestined	B/R Blackcap Empress 76	+25.58						
#+GAR Ext 4206	#N Bar Emulation EXT	\$F						
	+GAR 6807 Traveler 1432	+27.60						
#GAR Precision 1680	#Tehama Bando 155	\$G						
+E&B Lady Precision 310	9J9 GAR 856	+30.18						
+E&d Lady 6807 767	#DHD Traveler 6807	\$B						
	Lady 183 Traveler 334	+57.04						
CED	BW	WW	YW	Scrotal	CEM	Milk	\$EN	\$W
I+8	I+3.3	I+48	I+87	N/A	I+7	I+25	-1.71	+24.00
Act. BW	Adj. WW	Adj. YW	%IMF	RE	Fat	\$F	\$G	\$B
93	764	1266	I+.44	I+.67	I+.013	+27.53	+30.31	+56.59

• These Predestined sons out of 310 will be one of the best set of full brothers we have raised. Great herd bulls and they are that. Our Predestined daughters are calving and they have beautiful udders on them. Their Dam 310 is moderate framed with near perfect udder also. Dams WR 2/104, YR 2/102.



E&B Predestined 716 - Lot 51



E&B Predestined 757 - Lot 57



E&B Lady Precision 310 - Dam of Lots 50-57

# B SPRING BULLS B

## 58 Bull Calved: 1/31/07 Tattoo: 758 +15797087

#GAR Precision 1680 #Tehama Bando 155  
GAR Retail Product 9J9 GAR 856  
+GAR Ext 4927 #N Bar Emulation EXT  
GAR Traveler 641

#Bon View New Design 878 #B/R New Design 036  
E&B Primrose Lady 348 Bon View Gammer 85  
+E&B Everelda Queen 189 #GDAR Rainmaker 340  
E&b 6807 Lady Traveler 61

CED	BW	WW	YW	Scrotal	CEM	Milk	\$EN	\$W
I+6	I+1.7	I+48	I+88	I+.38	I+8	I+28	-4.60	+29.30
Act. BW	Adj. WW	Adj. YW	%IMF	RE	Fat	\$F		
85	808	1386	I+.29	I+.48	I+.000	+28.61		
								\$G
								+23.52
								\$B
								+46.15

This Retail Product bull should be something special with super cows in his pedigree. Breeders that know pedigrees know the E&B 6807 Lady Traveler 61 cow. The Rainmaker 189 daughter of 61 is also one of the great cows raised on the Ranch. This is an outstanding herd bull prospect. Dams WR 2/100.



E&B Retail Product 758 - Lot 58

## 59 Bull Calved: 3/05/07 Tattoo: 704 15794679

BR Midland #Twin Valley Precision E161  
A&B Midland 5096 BR Royal Lass 7036-19  
A&B Own Lass 9050 SVF Oscar 18E  
A&b Lass 5037

#Ideal 1418 of 8103 4286 Ideal 8103 of Eldo 5110 5213  
E&B Ideal Lady 162 EE 4286 of Ideal 2240 1254  
+E&b Lady Ext 858 #N Bar Emulation EXT  
Lady Scotch Traveler 320

CED	BW	WW	YW	Scrotal	CEM	Milk	\$EN	\$W
I+6	I+3.6	I+45	I+87	N/A	I+6	I+20	+2.52	+21.33
Act. BW	Adj. WW	Adj. YW	%IMF	RE	Fat	\$F		
92	743	1327	I+.38	I+.50	I+.023	+28.78		
								\$G
								+22.63
								\$B
								+46.16

We bought the A&B Midland 5096 from Arlen Sawyer in NE to use as a clean up bull. The bull has a really good carcass number and we hope he can pass that on to his offspring. This calf is out of a great cow family. We believe that he is an excellent prospect. Check him out! Dams WR 5/103.



E&B Retail Product 7115 - Lot 61

### FULL BROTHERS

## 60 Bull Calved: 2/24/07 Tattoo: 7113 +15797067

CED	BW	WW	YW	Scrotal	CEM	Milk	\$EN	\$W
I+7	I+1.5	I+47	I+86	I+.49	I+9	I+26	+1.43	+32.85
Act. BW	Adj. WW	Adj. YW	%IMF	RE	Fat	\$F		
85	698	1300	I+.28	I+.54	I+.024	+26.98		
								\$G
								+21.00
								\$B
								+45.22

## 61 Bull Calved: 2/25/07 Tattoo: 7115 +15797068

CED	BW	WW	YW	Scrotal	CEM	Milk	\$EN	\$W
I+7	I+1.5	I+47	I+86	I+.49	I+9	I+26	+1.43	+32.85
Act. BW	Adj. WW	Adj. YW	%IMF	RE	Fat	\$F		
80	698	1188	I+.28	I+.54	I+.024	+26.98		
								\$G
								+21.00
								\$B
								+45.22

## 62 Bull Calved: 1/29/07 Tattoo: 7117 +15797070

CED	BW	WW	YW	Scrotal	CEM	Milk	\$EN	\$W
I+7	I+1.5	I+47	I+86	I+.49	I+9	I+26	+1.43	+32.85
Act. BW	Adj. WW	Adj. YW	%IMF	RE	Fat	\$F		
85	673	1334	I+.28	I+.54	I+.024	+26.98		
								\$G
								+21.00
								\$B
								+45.22

## 63 Bull Calved: 2/24/07 Tattoo: 7119 +15797071

CED	BW	WW	YW	Scrotal	CEM	Milk	\$EN	\$W
I+7	I+1.5	I+47	I+86	I+.49	I+9	I+26	+1.43	+32.85
Act. BW	Adj. WW	Adj. YW	%IMF	RE	Fat	\$F		
85	734	1276	I+.28	I+.54	I+.024	+26.98		
								\$G
								+21.00
								\$B
								+45.22

## 64 Bull Calved: 1/29/07 Tattoo: 7123 +15797075

CED	BW	WW	YW	Scrotal	CEM	Milk	\$EN	\$W
I+7	I+1.5	I+47	I+86	I+.49	I+9	I+26	+1.43	+32.85
Act. BW	Adj. WW	Adj. YW	%IMF	RE	Fat	\$F		
82	750	1220	I+.28	I+.54	I+.024	+26.98		
								\$G
								+21.00
								\$B
								+45.22

## 65 Bull Calved: 2/28/07 Tattoo: 7182 +15797079

#GAR Precision 1680	#Tehama Bando 155	\$W						
GAR Retail Product	9J9 GAR 856	+32.85						
+GAR Ext 4927	#N Bar Emulation EXT	\$F						
	GAR Traveler 641	+26.98						
#N Bar Emulation EXT	#Emulation N Bar 5522	\$G						
+E&B Lady Erica 174	N Bar Primrose 2424	+21.00						
E&b 6807 Lady Traveler 61	#DHD Traveler 6807	\$B						
	Lady 963 Dividend 404	+45.22						
CED	BW	WW	YW	Scrotal	CEM	Milk	\$EN	\$W
I+7	I+1.5	I+47	I+86	I+.49	I+9	I+26	+1.43	+32.85
Act. BW	Adj. WW	Adj. YW	%IMF	RE	Fat	\$F		
90	659	1269	I+.28	I+.54	I+.024	+26.98		
								\$G
								+21.00
								\$B
								+45.22

If you need cow makers these Retail Product sons out of the 174 will fit the bill. These flush brothers are uniform and good. They should work on heifers also. Dams WR 3/107, YR 3/101.

# E B SPRING BULLS E B

## 66 E&B 4670 Centennial 766

**Bull** Calved: 2/16/07 Tattoo: 766 15794766

Dalebanks Centennial 2526 #Bon View New Design 878  
 Dalebanks Centennial 4670 #Witch of Dalebanks 9067  
 #Enamel 1614 of Dalebanks Dalebanks Emulation EXT 3383  
 #Enamel 4054 of Dalebanks

+Alc Balridge Kenworth I30K #Connealy Dateline  
 E&B Lady Kenworth 215 +Alcbalridge Primroselady54F  
 #E&b Lady Dividend 629 #TC Dividend 963  
 Lady 212 Heavy Time 468

CED	BW	WW	YW	Scrotal	CEM	Milk	\$EN	\$W
I+6	I+3.2	I+43	I+75	I+.43	I+7	I+20	+5.88	+24.11
								\$F
								+17.59
								\$G
								+16.26
								\$B
								+33.35

• These Centennial sons will have moderate birth with tremendous growth. The Centennial sons will be larger framed but are the right kind if you sell calves by the pound. Dams WR 4/103.



E&B 1023 Precision 718 - Lot 67

## 67 E&B 1023 Precision 718

**Bull** Calved: 1/30/07 Tattoo: 718 15794736

#GAR Precision 1680 #Tehama Bando 155  
 +E&B 1680 Precision 1023 9J9 GAR 856  
 E&b 6807 Lady Traveler 61 #DHD Traveler 6807  
 Lady 963 Dividend 404

+HA Power Alliance 1025 #Sitz Alliance 6595  
 E&B Lady Power Alliance 376 +HA Rito Lady 4167  
 E&b Lady 4137 Ext 964 #Gardens EXT 4137 S2  
 Lady High Flyer 598

CED	BW	WW	YW	Scrotal	CEM	Milk	\$EN	\$W
I+8	I+1.2	I+49	I+92	I+.02	I+10	I+22	+5.56	+29.30
								\$F
								+28.22
								\$G
								+23.51
								\$B
								+47.38

• This 1023 son is a terrific prospect. He is out of one of the very best Power Alliance daughters. If your cows are getting to big framed you need to look at this bull. We believe he can get the job done. Dams WR 3/105.



## 68 E&B Solution 707

**Bull** Calved: 1/22/07 Tattoo: 707 15807832

#SS Traveler 6807 T510 #DHD Traveler 6807  
 GAR Solution #SS Miss Hi Spade A114  
 +GAR New Design 50 #B/R New Design 036  
 GAR Precision 2536

+HA Power Alliance 1025 #Sitz Alliance 6595  
 E&B Lady Power Alliance 4127 +HA Rito Lady 4167  
 E&B Lady Bonnie 103 #Gardens EXT 4137 S2  
 E&b Lady 744 Bouncer 947

CED	BW	WW	YW	Scrotal	CEM	Milk	\$EN	\$W
I+11	I+0.5	I+44	I+85	I+.27	I+8	I+22	+1.41	+27.21
								\$F
								+27.14
								\$G
								+25.84
								\$B
								+48.26

• This calving ease son of Solution should add carcass and maternal. Good cows in the pedigree. Dams WR 2/95.

## 69 E&B Yield Grade 708

**Bull** Calved: 1/23/07 Tattoo: 708 15807833

#GAR Precision 1680 #Tehama Bando d155  
 +GAR Yield Grade 9J9 GAR 856  
 +GAR Ext 4526 #N Bar Emulation EXT  
 +GAR 6807 Traveler 93

S&S Traveler 6807-6 #DHD Traveler 6807  
 E&B Blackbird Pride 158 #S&S Pride 1922  
 E&b 5667 Lady Regal 788 CH Regal 5667  
 Lady 963 Dividend 404

CED	BW	WW	YW	Scrotal	CEM	Milk	\$EN	\$W
I+11	I+2.5	I+51	I+93	I+.51	I+12	I+19	+1.63	+25.96
								\$F
								+32.54
								\$G
								+15.83
								\$B
								+41.75

• This Yield Grade son will add lots of power and carcass to his pedigree. Dams WR 5/99.

## 70 E&B 1023 Precision 770

**Bull** Calved: 1/24/07 Tattoo: 770 15794770

#GAR Precision 1680 #Tehama Bando 155  
 +E&B 1680 Precision 1023 9J9 GAR 856  
 E&b 6807 Lady Traveler 61 #DHD Traveler 6807  
 Lady 963 Dividend 404

#Bon View New Design 878 #B/R New Design 036  
 E&B Primrose Lady 374 Bon View Gammer 85  
 E&b 4137 Lady Dominett 867 #Gardens EXT 4137 S2  
 Lady Scotch Traveler 374

CED	BW	WW	YW	Scrotal	CEM	Milk	\$EN	\$W
I+9	I+0.6	I+45	I+84	N/A	I+11	I+24	-.00	+28.68
								\$F
								+25.74
								\$G
								+23.58
								\$B
								+45.56

• This 1023 son has that herd bull look. His dam 374 is one of the better 878 daughters in the herd. The good cowman will sort this bull out. Dams WR 2/109, YR 2/111.



E&B 1023 Precision 770 - Lot 70

# B SPRING BULLS B

## FULL BROTHERS

## FULL BROTHERS

### 71 Bull Calved: 2/01/07 Tattoo: 755 +15794762

### 73 Bull Calved: 1/29/07 Tattoo: 794 +15794786

CED	BW	WW	YW	Scrotal	CEM	Milk	\$EN	\$W
I+10	I+0.1	I+44	I+81	N/A	I+11	I+23	+1.82	+29.13
Act. BW	Adj. WW	Adj. YW	%IMF	RE	Fat	\$F		
81	721	1281	I+.41	I+.64	I+.003	+23.12		
						\$G		
						+27.68		
						\$B		
						+48.05		

CED	BW	WW	YW	Scrotal	CEM	Milk	\$EN	\$W
I+9	I+1.5	I+46	I+85	I-.50	I+9	I+21	+2.25	+27.34
Act. BW	Adj. WW	Adj. YW	%IMF	RE	Fat	\$F		
87	718	1294	I+.38	I+.66	I-.001	+26.36		
						\$G		
						+27.00		
						\$B		
						+49.41		

### 72 Bull Calved: 1/29/07 Tattoo: 759 +15794763

### 74 Bull Calved: 1/26/07 Tattoo: 7100 +15794682

#GAR Precision 1680	#Tehama Bando 155							
+E&B 1680 Precision 1023	9J9 GAR 856							
E&b 6807 Lady Traveler 61	#DHD Traveler 6807							
	Lady 963 Dividend 404							
#B/R New Design 036	#VDAR New Trend 315							\$W
+E&B Lady Precision 328	B/R Blackcap Empress 76							+30.38
+E&b Lady Ext 858	#N Bar Emulation EXT							\$F
	Lady Scotch Traveler 320							+25.58
CED	BW	WW	YW	Scrotal	CEM	Milk	\$EN	\$G
I+10	I+0.8	I+48	I+85	N/A	I+11	I+23	-.84	+27.31
Act. BW	Adj. WW	Adj. YW	%IMF	RE	Fat	\$B		
85	709	1274	I+.41	I+.64	I+.003	+49.70		

#GAR Precision 1680	#Tehama Bando 155							
+E&B 1680 Precision 1023	9J9 GAR 856							
E&b 6807 Lady Traveler 61	#DHD Traveler 6807							
	Lady 963 Dividend 404							
#B/R New Design 036	#VDAR New Trend 315							\$W
+E&B Lady New Design 373	B/R Blackcap Empress 76							+28.76
+E&b Lady Ext 858	#N Bar Emulation EXT							\$F
	Lady Scotch Traveler 320							+26.75
CED	BW	WW	YW	Scrotal	CEM	Milk	\$EN	\$G
I+9	I-0.7	I+45	I+85	I-.50	I+9	I+21	+2.25	+27.00
Act. BW	Adj. WW	Adj. YW	%IMF	RE	Fat	\$B		
71	674	1274	I+.38	I+.66	I-.001	+49.42		

• These two 1023 sons are moderate framed with lots of power. 328 is one of the better 036 daughters in the herd out of the top notch EXT cow. These 1023 sons should be great heifer bulls. Dams WR 3/109, YR 2/111.

• Full brothers in blood to Lots 71 and 72. Lady 373 is another powerful 036 cow from E&B Lad EXT 858. These are also outstanding heifer bulls. WR 2/106, YR 2/106.



E&B 1023 Precision 755 - Lot 71



E&B Lady EXT 858 - Grand dam of Lots 71-74



E&B 1680 Precision 1023

### 75 Bull Calved: 1/26/07 Tattoo: 775 15794775

#GAR Precision 1680	#Tehama Bando 155							
+E&B 1680 Precision 1023	9J9 GAR 856							
E&b 6807 Lady Traveler 61	#DHD Traveler 6807							
	Lady 963 Dividend 404							
#B/R New Design 036	#VDAR New Trend 315							\$W
+E&B Lady New Design 3135	B/R Blackcap Empress 76							+25.56
+E&b 1483 Lady Scotchman 75	#RR 9440 Scotch Cap 1483							\$F
	Lady 183 Traveler 334							+22.68
CED	BW	WW	YW	Scrotal	CEM	Milk	\$EN	\$G
I+9	I+0.6	I+40	I+79	I-.53	I+10	I+21	+3.93	+25.01
Act. BW	Adj. WW	Adj. YW	%IMF	RE	Fat	\$B		
80	667	1243	I+.34	I+.49	I+.000	+44.41		

• This 1023 is another very good prospect that goes back to the 75 cow, a great calving ease prospect here. Dams WR 3/97.

# B SPRING BULLS B

## FULL BROTHERS

### 76 Bull Calved: 2/25/07 Tattoo: 753 +15797083

CED	BW	WW	YW	Scrotal	CEM	Milk	\$EN	\$W
I+4	I+2.9	I+53	I+98	I+.56	I+6	I+27	-6.51	+27.40
Act. BW	Adj. WW	Adj. YW	%IMF	RE	Fat	\$F		
90	809	1390	I+.26	I+.58	I+.014	+36.93		
								\$G
								+20.14
								\$B
								+48.62

### 77 Bull Calved: 2/25/07 Tattoo: 7121 +15797073

CED	BW	WW	YW	Scrotal	CEM	Milk	\$EN	\$W
I+4	I+2.8	I+49	I+97	I+.56	I+6	I+27	-6.22	+25.05
Act. BW	Adj. WW	Adj. YW	%IMF	RE	Fat	\$F		
86	750	1403	I+.26	I+.58	I+.014	+37.51		
								\$G
								+20.21
								\$B
								+48.52

### 78 Bull Calved: 2/26/07 Tattoo: 7101 +15797061

CED	BW	WW	YW	Scrotal	CEM	Milk	\$EN	\$W
I+4	I+3.6	I+51	I+105	I+.56	I+6	I+27	-8.54	+22.44
Act. BW	Adj. WW	Adj. YW	%IMF	RE	Fat	\$F		
92	741	1491	I+.26	I+.58	I+.014	+45.19		
								\$G
								+19.75
								\$B
								+50.21

• These Retail Products are out of one of the top 598 daughters in the herd. These bulls have the power to be herd builders. Check them out. You will not be disappointed. Dams WR 3/105.



E&B Retail Product 7101 - Lot 78



E&B 598 Lady Bando 291 - Dam of Lots 76-78

### 79 Bull Calved: 2/21/07 Tattoo: 779 15794778

#Twin Valley Precision E161 #GAR Precision 1680  
 +ALC National T60N +WCC Blackcap C9  
 #ALC Blackcap E03F #N Bar Emulation EXT  
 Bon View Blackcap 1330

#Gardens EXT 4137 S2 #N Bar Emulation EXT  
 E&b 4137 Lady Dominette 697 #Green Garden Bonnie 1134 S1  
 Lady 1001 Traveler 484 RR Traveler 1001  
 Lady Stacker 268

CED	BW	WW	YW	Scrotal	CEM	Milk	\$EN	\$W
I+3	I+3.1	I+45	I+92	I+.99	I+6	I+20	+1.09	+20.99
Act. BW	Adj. WW	Adj. YW	%IMF	RE	Fat	\$F		
85	751	1437	I+.17	I+.19	I+.010	+33.91		
								\$G
								+13.86
								\$B
								+39.55

• This National son is out of one of our better older cows and she still does a great job. This is a very good bull. Dams WR 10/103.

## FULL BROTHERS

### 80 Bull Calved: 1/31/07 Tattoo: 752 +15797082

CED	BW	WW	YW	Scrotal	CEM	Milk	\$EN	\$W
I+8	I+0.3	I+39	I+83	I-.05	I+8	I+22	+1.97	+24.29
Act. BW	Adj. WW	Adj. YW	%IMF	RE	Fat	\$F		
78	701	1314	I+.18	I+.20	I+.011	+27.08		
								\$G
								+19.71
								\$B
								+37.92

### 81 Bull Calved: 2/01/07 Tattoo: 793 +15797088

CED	BW	WW	YW	Scrotal	CEM	Milk	\$EN	\$W
I+8	I+0.6	I+43	I+91	I-.05	I+8	I+22	-.29	+24.68
Act. BW	Adj. WW	Adj. YW	%IMF	RE	Fat	\$F		
82	746	1418	I+.18	I+.20	I+.011	+33.68		
								\$G
								+19.19
								\$B
								+40.14

### 82 Bull Calved: 2/05/07 Tattoo: 7110 +15797066

CED	BW	WW	YW	Scrotal	CEM	Milk	\$EN	\$W
I+8	I+2.0	I+45	I+91	I-.05	I+8	I+22	-.29	+24.20
Act. BW	Adj. WW	Adj. YW	%IMF	RE	Fat	\$F		
94	762	1407	I+.18	I+.20	I+.011	+32.88		
								\$G
								+19.19
								\$B
								+40.10

### 83 Bull Calved: 1/30/07 Tattoo: 7105 +15797063

#DHD Traveler 6807 #OAS Traveler 23-4  
 #Rito 616 of 4B20 6807 #Bemindful Maid DHD 0807  
 +Rita 4B20 of 0FB1 Bando #Tehama Bando 155  
 +Rita 0FB1 of 5H11 Fullback

#SAF Focus of ER #SAF Fame  
 E&B Lady Focus 242 GDAR Forever Lady 246  
 E&b Everelda Queen 074 #GDAR Rainmaker 340  
 E&b 5667 Lady Regal 86

CED	BW	WW	YW	Scrotal	CEM	Milk	\$EN	\$W
I+8	I+0.3	I+41	I+90	I-.05	I+8	I+22	-.01	+23.78
Act. BW	Adj. WW	Adj. YW	%IMF	RE	Fat	\$F		
80	697	1396	I+.18	I+.20	I+.011	+33.45		
								\$G
								+19.23
								\$B
								+39.74

• These 616 sons out of the 242 cow are bred to be calving ease deluxe. When you have Focus and Rainmaker 340 on the bottom side you can't miss. The 242 cow with 616 make an excellent mating. They are very docile. Dams WR 4/106.

# B SPRING BULLS B

## 84 Bull E&B Hawkeye 7138 Calved: 3/12/07 Tattoo: 7138 15794694

+B/R New Frontier 095 #B/R New Design 036  
LD Hawkeye 211 White Fence Pride H1  
#LD 6807 Pride 9211 #DHD Traveler 6807  
Molitor 473 Pride 8432

#SAF Focus of ER #SAF Fame  
E&B Lady Focus 242 GDAR Forever Lady 246  
E&b Everelda Queen 074 #GDAR Rainmaker 340  
E&b 5667 Lady Regal 86

CED	BW	WW	YW	Scrotal	CEM	Milk	\$EN	\$W
I+7	I+0.0	I+40	I+76	I+.63	I+9	I+24	+2.24	+27.83
Act. BW	Adj. WW	Adj. YW	%IMF	RE	Fat			\$F
75	744	1251	I+.31	I+.26	I+.018			+19.71
								\$G
								+20.24
								\$B
								+38.08

• This Hawkeye natural son out of 242 is also a heifer bull prospect. We used Hawkeye as a clean-up on our heifer until he got to big. Dams WR 4/104.

### FULL BROTHERS

## 85 Bull E&B E161 Precision 748 Calved: 1/29/07 Tattoo: 748 +15796160

CED	BW	WW	YW	Scrotal	CEM	Milk	\$EN	\$W
I+4	I+3.2	I+35	I+81	I+.59	I+7	I+20	+4.20	+16.50
Act. BW	Adj. WW	Adj. YW	%IMF	RE	Fat			\$F
87	615	1244	I+.29	I+.33	I+.005			+26.62
								\$G
								+21.25
								\$B
								+41.66

## 86 Bull E&B E161 Precision 7104 Calved: 1/31/07 Tattoo: 7104 +15794683

CED	BW	WW	YW	Scrotal	CEM	Milk	\$EN	\$W
I+4	I+3.9	I+46	I+89	I+.59	I+7	I+20	+1.94	+20.83
Act. BW	Adj. WW	Adj. YW	%IMF	RE	Fat			\$F
93	787	1381	I+.29	I+.33	I+.005			+30.42
								\$G
								+20.47
								\$B
								+44.75

## 87 Bull E&B E161 Precision 7109 Calved: 1/31/07 Tattoo: 7109 +15796154

#GAR Precision 1680 #Tehama Bando 155  
#Twin Valley Precision E161 9J9 GAR 856  
+WCC Blackcap C9 #SS Traveler 6T6  
Premier Blackcap 6276A

+HA Power Alliance 1025 #Sitz Alliance 6595  
E&B Lady Power Alliance 344 +HA Rito Lady 4167  
E&b Bonnie Lady 023 #Gardens EXT 4137 S2  
E&b Lady Lucy 630

CED	BW	WW	YW	Scrotal	CEM	Milk	\$EN	\$W
I+4	I+4.2	I+48	I+93	I+.59	I+7	I+20	+1.80	+20.47
Act. BW	Adj. WW	Adj. YW	%IMF	RE	Fat			\$F
95	816	1424	I+.29	I+.33	I+.005			+33.74
								\$G
								+20.04
								\$B
								+46.00

• This is a very good flush of E161 sons out of one of our very top Power Alliance 1025 daughters. This should be a great combination. Your next herd bull just might be in this flush. **We think their pretty good.** Dams WR 4/104.



E&B E161 Precision 7104 - Lot 86

Benoit - 23 - Angus

### FULL BROTHERS

## 88 Bull E&B 6106 Ext 7103 Calved: 1/26/07 Tattoo: 7103 +15796153

CED	BW	WW	YW	Scrotal	CEM	Milk	\$EN	\$W
I+9	I+0.6	I+39	I+71	I-.23	I+9	I+23	+4.47	+27.63
Act. BW	Adj. WW	Adj. YW	%IMF	RE	Fat			\$F
81	670	1140	I+.15	I+.32	I-.001			+15.21
								\$G
								+18.15
								\$B
								+32.00

## 89 Bull E&B 6106 Ext 7114 Calved: 1/27/07 Tattoo: 7114 +15796157

CED	BW	WW	YW	Scrotal	CEM	Milk	\$EN	\$W
I+9	I+1.5	I+46	I+84	I-.23	I+9	I+23	+1.85	+28.21
Act. BW	Adj. WW	Adj. YW	%IMF	RE	Fat			\$F
90	793	1371	I+.15	I+.32	I-.001			+25.35
								\$G
								+17.16
								\$B
								+36.10

## 90 Bull E&B 6106 Ext 7124 Calved: 1/26/07 Tattoo: 7124 +15796159

CED	BW	WW	YW	Scrotal	CEM	Milk	\$EN	\$W
I+9	I+1.1	I+39	I+77	I-.23	I+9	I+23	+2.81	+25.48
Act. BW	Adj. WW	Adj. YW	%IMF	RE	Fat			\$F
85	719	1300	I+.15	I+.32	I-.001			+21.08
								\$G
								+17.73
								\$B
								+34.14

• These flush brothers are out of one very top 1680 cows. Precision 221's dam and great dam were some of the very best. The kind we take pride in having in our cow herd. The bulls are bred for calving ease and you will like their replacements. Dams WR 2/98.

## 91 Bull E&B Hawkeye 745 Calved: 2/22/07 Tattoo: 745 15794758

CED	BW	WW	YW	Scrotal	CEM	Milk	\$EN	\$W
I+9	I+0.5	I+33	I+75	I+.32	I+8	I+21	+5.05	+21.55
Act. BW	Adj. WW	Adj. YW	%IMF	RE	Fat			\$F
80	699	1374	I+.38	I+.34	I+.006			+21.40
								\$G
								+24.76
								\$B
								+41.83

• We take pride in our clean-up bulls. There is no let down in performance, style, and maternal. Our clean-ups are some of the very best. Several are bulls we have raised and we know their dams, grand dam and down the line. We look for consistency. This bull will work on heifers. Dams WR 2/98.

# B SPRING BULLS B

## 92 Bull Calved: 1/20/07 Tattoo: 792 15794785

#GAR Precision 1680 #Tehama Bando 155  
 +E&B 1680 Precision 1023 9J9 GAR 856  
 E&b 6807 Lady Traveler 61 #DHD Traveler 6807  
 Lady 963 Dividend 404

#GT Maximum #Scotch Cap  
 E&B Lady Maxima 363 #GT Miss Traveler 58  
 E&b Everelda Queen 0117 #GDAR Rainmaker 340  
 +E&b Lady Ext 858

CED	BW	WW	YW	Scrotal	CEM	Milk	\$EN	\$W
I+8	I+1.5	I+45	I+83	I-.61	I+8	I+14	+8.49	+24.63
								\$F
								+24.74
								\$G
								+27.34
Act. BW	Adj. WW	Adj. YW	%IMF	RE	Fat	\$B		
85	682	1279	I+.43	I+.43	I-.005	+48.85		

• This elite 1023 son is a top herd bull prospect with great cows in the pedigree. 792 is a big scrotal 1023 son that should be a great calving ease bull. This is a bull we have great faith in. You will want to look him up and you will not be disappointed. Dams WR 3/93.



E&B 1023 Precision 792 - Lot 92



E&B Everelda Queen 0117 - Grand dam of Lot 92

**Receive a 5% discount if you purchased a bull from last years sale.**

## 93 Bull Calved: 1/30/07 Tattoo: 710 15794681

#GAR Precision 1680 #Tehama Bando 155  
 +E&B 1680 Precision 1023 9J9 GAR 856  
 E&b 6807 Lady Traveler 61 #DHD Traveler 6807  
 Lady 963 Dividend 404

Connealy Lead On #Connealy Leadtime  
 E&B Lady Lead ON 4110 Eligence Plus of Conanga  
 E&B Everelda Queen 214 #GDAR Rainmaker 340  
 E&b Forever Lady 036

CED	BW	WW	YW	Scrotal	CEM	Milk	\$EN	\$W
I+9	I+0.5	I+41	I+86	I-.24	I+10	I+25	-1.42	+25.54
								\$F
								+29.34
								\$G
								+20.27
Act. BW	Adj. WW	Adj. YW	%IMF	RE	Fat	\$B		
80	682	1327	I+.19	I+.47	I-.013	+43.15		

• This is a full brother to one of the very top bulls in our 2007 sale going to McCracken Ranch in OK. This bull started a little slow but really has come on. He is a great prospect with great cows in the pedigree. He should be a calving ease herd bull that will add power, maternal, and carcass. Dams WR 2/101.



E&B 1680 Precision 1023

### FULL BROTHERS

## 94 Bull Calved: 2/15/07 Tattoo: 799 +15796162

CED	BW	WW	YW	Scrotal	CEM	Milk	\$EN	\$W
I+8	I+1.5	I+40	I+78	I+.02	I+10	I+20	+5.04	+24.60
								\$F
								+21.68
								\$G
								+16.54
								\$B
								+34.74

## 95 Bull Calved: 2/16/07 Tattoo: 7112 +15796156

#N Bar Emulation EXT #Emulation N Bar 5522  
 +Wulffs Ext 6106 N Bar Primrose 2424  
 Wulffs Erica Dianna C116 #Tehama Bando 155  
 Wulffs Erica Dianna A308

#GAR Precision 1680 #Tehama Bando 155  
 E&B Lady Precision 122 9J9 GAR 856  
 E&b Lady 4137 Ext 964 #Gardens EXT 4137 S2  
 Lady High Flyer 598

CED	BW	WW	YW	Scrotal	CEM	Milk	\$EN	\$W
I+8	I+1.5	I+40	I+78	I+.02	I+10	I+20	+5.04	+24.60
								\$F
								+21.68
								\$G
								+16.54
Act. BW	Adj. WW	Adj. YW	%IMF	RE	Fat	\$B		
82	703	1327	I+.13	I+.28	I-.003	+34.74		

• Lots 94 and 95 are calving ease prospects also out of one of our very best 1680 daughters. The cows we select for donors will have it all with great udders, pedigree, disposition, and type. Dams WR 4/98.

# B SPRING BULLS B

## 96 Bull Calved: 2/21/07 Tattoo: 7106 +15797064

#DHD Traveler 6807 #OAS Traveler 23-4  
 #Rito 616 of 4B20 6807 #Bemindful Maid DHD 0807  
 +Rita 4B20 of 0FB1 Bando #Tehama Bando 155  
 +Rita 0FB1 of 5H11 Fullback

#GAR Precision 1680	#Tehama Bando 155	\$W						
E&B Lady Precision 122	9J9 GAR 856	+20.53						
E&b Lady 4137 Ext 964	#Gardens EXT 4137 S2	\$F						
	Lady High Flyer 598	+21.62						
CED	BW	WW	YW	Scrotal	CEM	Milk	\$EN	\$G
I+9	I+1.4	I+35	I+76	I-.12	I+8	I+17	+8.06	+22.43
Act. BW	Adj. WW	Adj. YW	%IMF	RE	Fat	\$B		
79	653	1234	I+.23	I+.24	I-.003	+42.57		

• This 616 is also a great calving prospect. The 616 calves are very easy to handle. Dams WR 4/98.

## 97 Bull Calved: 2/19/07 Tattoo: 715 15794704

Sitz Traveler 7594 #Sitz Traveler 9929  
 +HD Dunn Cornerstone 0245 Sitz Emma E 2552  
 #Dixie Erica of CH 6180 #Shoshone Intent KGEA27  
 Dixie Erica of CH 1019

#GAR Precision 1680	#Tehama Bando 155	\$W						
E&B Lady Precision 122	9J9 GAR 856	+16.95						
E&b Lady 4137 Ext 964	#Gardens EXT 4137 S2	\$F						
	Lady High Flyer 598	+23.06						
CED	BW	WW	YW	Scrotal	CEM	Milk	\$EN	\$G
I+5	I+3.6	I+39	I+79	I+.44	I+4	I+14	+9.61	+17.41
Act. BW	Adj. WW	Adj. YW	%IMF	RE	Fat	\$B		
88	756	1396	I+.17	I+.28	I+.000	+36.82		

• This Cornerstone son is 122's natural calf. He is a very correct powerful bull that your cows will enjoy very much. Dams WR 4/98.

## 98 Bull Calved: 1/21/07 Tattoo: 785 15807859

#Bon View New Design 878 #B/R New Design 036  
 +Rito 2 878 of 2536 BVND 878 Bon View Gammer 85  
 GAR Precision 2536 #GAR Precision 1680  
 +GAR Ext 2104

#Sitz Traveler 9929	#DHD Traveler 6807	\$W						
+E&B Everelda Maid 177	Sitz Everelda Entense 1137	+26.20						
Lady Stacker 308	#CH Stacker 7040	\$F						
	Lady Blackbird 1049	+12.17						
CED	BW	WW	YW	Scrotal	CEM	Milk	\$EN	\$G
I+5	I+2.8	I+42	I+69	I+.04	I+6	I+21	+6.70	+17.98
Act. BW	Adj. WW	Adj. YW	%IMF	RE	Fat	\$B		
88	755	1225	I+.13	I+.62	I+.014	+31.54		

• This 2-878 son is a very good bull. His dam, 177, is a moderate framed cow that has a perfect udder. We have a heifer replacement producer here. Dams WR 4/100.

## 99 Bull Calved: 1/25/07 Tattoo: 709 15807834

#B/R New Design 036 #VDAR New Trend 315  
 GAR Predestined B/R Blackcap Empress 76  
 #+GAR Ext 4206 #N Bar Emulation EXT  
 +GAR 6807 Traveler 1432

+E&B 1680 Precision 1023	#GAR Precision 1680	\$W						
E&B Lady 1023 Precision 420	E&b 6807 Lady Traveler 61	+26.63						
#E&b Lady Bingo 097	GAR Bingo 4192	\$F						
	E&b 5502 Lady Quantum 807	+32.77						
CED	BW	WW	YW	Scrotal	CEM	Milk	\$EN	\$G
I+9	I+3.3	I+53	I+94	I-.29	I+8	I+23	-2.00	+24.40
Act. BW	Adj. WW	Adj. YW	%IMF	RE	Fat	\$B		
90	772	1383	I+.45	I+.46	I+.017	+50.93		

• This is a very good Predestined bull out of a good 1023 cow. Dams WR 2/103.

## 100 Bull Calved: 1/30/07 Tattoo: 712 15794684

#Bon View New Design 878 #B/R New Design 036  
 +E&B 878 New Design 4114 Bon View Gammer 85  
 +E&d Lady 6807 796 #DHD Traveler 6807  
 Lady 183 Traveler 334

#GAR Precision 1680	#Tehama Bando 155	\$W						
#+E&B Lady Precision 287	9J9 GAR 856	+23.94						
S&S Zara 3025	#N Bar Emulation EXT	\$F						
	#S&S Zara 1473	+14.40						
CED	BW	WW	YW	Scrotal	CEM	Milk	\$EN	\$G
I+8	I+2.4	I+36	I+69	I+.41	I+9	I+26	+2.45	+19.31
Act. BW	Adj. WW	Adj. YW	%IMF	RE	Fat	\$B		
88	707	1229	I+.22	I+.43	I+.019	+32.80		

• This is a well bred 4114 son. Dams WR 4/104.

## 101 Bull Calved: 2/14/07 Tattoo: 70 15794676

#Twin Valley Precision E161 #GAR Precision 1680  
 +E&B E161 Precision 591 +WCC Blackcap C9  
 +E&d Lady 6807 767 #DHD Traveler 6807  
 Lady 183 Traveler 334

#Bon View New Design 1407	#B/R New Design 036	\$W						
+E&B Empress Pride 2108	Bon View Pride 664	+21.85						
+E&d 7040 Lady Stacker 671	#CH Stacker 7040	\$F						
	Lady Traveler B148	+24.00						
CED	BW	WW	YW	Scrotal	CEM	Milk	\$EN	\$G
I+6	I+0.1	I+34	I+78	I-.07	I+6	I+21	+4.21	+20.45
Act. BW	Adj. WW	Adj. YW	%IMF	RE	Fat	\$B		
73	652	1279	I+.27	I+.39	I+.013	+39.36		

• This is a well bred bull out of a very good cow. Dams WR 4/96.

## 102 Bull Calved: 3/01/07 Tattoo: 705 15794680

#B/R New Design 036 #VDAR New Trend 315  
 +E&B New Design 3133 B/R Blackcap Empress 76  
 E&b 6807 Lady Traveler 61 #DHD Traveler 6807  
 Lady 963 Dividend 404

+HA Power Alliance 1025	#Sitz Alliance 6595	\$W						
E&B Lady Power Alliance 596	+HA Rito Lady 4167	+26.30						
+E&b Blackcap Lady 002	#GDAR Traveler 71	\$F						
	Lady Stacker 365	+19.33						
CED	BW	WW	YW	Scrotal	CEM	Milk	\$EN	\$G
I+9	I+2.0	I+41	I+76	N/A	I+8	I+25	+1.38	+12.28
Act. BW	Adj. WW	Adj. YW	%IMF	RE	Fat	\$B		
80	731	1368	I+.08	I+.25	I+.014	+30.13		

• These 3133 sons will work on heifers. Dams WR 1/100.

## 103 Bull Calved: 1/13/07 Tattoo: 706 15807831

Ironwood New Design 022 701 #B/R New Design 036  
 Ironwood New Level Wardens Lady 022 5410  
 Wardens Blackcap 6148 6309 #Finks 5522-6148  
 Wardens Blackcap SC 025

+HD Dunn Cornerstone 0245	Sitz Traveler 7594	\$W						
E&B Lady Cornerstone 5035	#Dixie Erica of CH 6180	+25.48						
#E&B Lady Precision 210	#GAR Precision 1680	\$F						
	E&b 5706 Lady Arbitrator 824	+23.74						
CED	BW	WW	YW	Scrotal	CEM	Milk	\$EN	\$G
I+8	I+3.1	I+45	I+82	N/A	I+4	I+26	-1.16	+13.97
Act. BW	Adj. WW	Adj. YW	%IMF	RE	Fat	\$B		
84	775	1348	I+.08	I+.32	I+.000	+35.05		

• We used New Level on 1st calf heifers and got along fine. This bull has a little more birth weight for heifers, with Cornerstone on the dam's side, but he will work great on cows. Dams WR 1/106.

# B SPRING BULLS B

## 104 Bull Calved: 1/25/07 Tattoo: 711 15807835

#+Leachman Right Time #N Bar Emulation EXT  
Hyline Right Time 338 Leachman Erica 0025  
Hyline Pride 265 +Hyline SVF Traveler 0115  
Hyline Pride 870

#GAR Precision 1680	#Tehama Bando 155	\$W						
+E&B Lady Precision 304	9J9 GAR 856	+22.83						
+E&b 1483 Lady Scotchman 826	#RR 9440 Scotch Cap 1483	\$F						
	Lady 228 Stepahead 473	+36.06						
CED	BW	WW	YW	Scrotal	CEM	Milk	\$EN	\$G
I+5	I+4.5	I+50	I+96	I+.43	I+5	I+27	-5.43	+14.28
Act. BW	Adj. WW	Adj. YW	%IMF	RE	Fat	\$B		
95	775	1404	I+.19	I+.42	I+.010	+41.04		

• These 338 sons will add growth, maternal and carcass. Dams WR 3/105.

## 108 Bull Calved: 2/08/07 Tattoo: 725 15794747

#Bon View New Design 208 #B/R New Design 036  
E&B 208 New Design 573 #Bon View Erica 443  
E&B Lady Cornerstone 382 +HD Dunn Cornerstone 0245  
E&b 5706 Lady Arbitrator 866

+HA Power Alliance 1025	#Sitz Alliance 6595	\$W						
E&B Lady Power Alliance 5011	+HA Rito Lady 4167	+22.84						
E&B Lady Precision 227	#GAR Precision 1680	\$F						
	+E&b Eriskay Lady 091	+22.07						
CED	BW	WW	YW	Scrotal	CEM	Milk	\$EN	\$G
I+6	I+3.0	I+39	I+78	N/A	I+6	I+28	-1.79	+16.72
Act. BW	Adj. WW	Adj. YW	%IMF	RE	Fat	\$B		
82	661	1250	I+.11	I+.45	I-.001	+35.62		

• Very good cows in this bulls pedigree. Dams WR 1/90.

## 105 Bull Calved: 2/21/07 Tattoo: 714 15807840

+B/R New Frontier 095 #B/R New Design 036  
LD Hawkeye 211 White Fence Pride H1  
#LD 6807 Pride 9211 #DHD Traveler 6807  
Molitor 473 Pride 8432

#N Bar Emulation EXT	#Emulation N Bar 5522	\$W						
E&b Lady Ext 738	N Bar Primrose 2424	+17.46						
Lady Stacker 356	#CH Stacker 7040	\$F						
	#Lady Paramount E524	+20.25						
CED	BW	WW	YW	Scrotal	CEM	Milk	\$EN	\$G
I+4	I+3.8	I+36	I+75	I+.46	I+5	I+19	+6.87	+18.94
Act. BW	Adj. WW	Adj. YW	%IMF	RE	Fat	\$B		
94	709	1354	I+.30	I+.18	I+.021	+36.01		

• The Hawkeye sons have worked well in many herds. Dams WR 9/101.

## 109 Bull Calved: 2/05/07 Tattoo: 730 15807847

#GAR Precision 1680 #Tehama Bando 155  
+GAR US Premium Beef 9J9 GAR 856  
GAR Ext 2928 #N Bar Emulation EXT  
+GAR 6807 Traveler 154

#Connealy Freightliner	#Bon View Bando 598	\$W						
E&B Lady Freightliner 5022	Joana Erica of Conanga	+22.78						
+E&b Everelda Maid 004	#Sitz Traveler 9929	\$F						
	Lady Dividend 382	+20.09						
CED	BW	WW	YW	Scrotal	CEM	Milk	\$EN	\$G
I+5	I+2.3	I+39	I+76	N/A	I+8	I+20	+5.60	+13.78
Act. BW	Adj. WW	Adj. YW	%IMF	RE	Fat	\$B		
78	727	1281	I+.25	I+.38	I+.023	+36.13		

• The way this bull is bred he should work on heifers. Dams WR 1/105.

## 106 Bull Calved: 3/27/07 Tattoo: 7126 15794685

BR Midland #Twin Valley Precision E161  
A&B Midland 5096 BR Royal Lass 7036-19  
A&B Own Lass 9050 SVF Oscar 18E  
A&b Lass 5037

GAR Bingo 4192	#RR Traveler 5204	\$W						
E&b Lady Bingo 093	GAR Bando 247	+19.35						
E&b 4137 Lady Dominett 814	#Gardens EXT 4137 S2	\$F						
	+E&d 524 Lady Skylar 672	+19.65						
CED	BW	WW	YW	Scrotal	CEM	Milk	\$EN	\$G
I+7	I+2.1	I+35	I+74	N/A	I+6	I+16	+9.42	+20.60
Act. BW	Adj. WW	Adj. YW	%IMF	RE	Fat	\$B		
86	655		I+.37	I+.12	I+.022	+37.11		

• This is a younger Midland son with tremendous upside. Dams WR 6/95.

## 110 Bull Calved: 1/31/07 Tattoo: 731 15807848

Ironwood New Design 022 701 #B/R New Design 036  
Ironwood New Level Wardens Lady 022 5410  
Wardens Blackcap 6148 6309 #Finks 5522-6148  
Wardens Blackcap SC 025

GAR Retail Product	#GAR Precision 1680	\$W						
E&B Lady Retail Product 591	+GAR Ext 4927	+30.42						
E&B Lady Dateline 2116	E&b 3134 Dateline 0157	\$F						
	+E&b 1483 Lady Scotchman 747	+29.40						
CED	BW	WW	YW	Scrotal	CEM	Milk	\$EN	\$G
I+11	I-0.5	I+46	I+88	N/A	I+8	I+29	-5.48	+19.50
Act. BW	Adj. WW	Adj. YW	%IMF	RE	Fat	\$B		
67	772	1388	I+.24	I+.22	I+.011	+43.46		

• This well bred New Level will be a great heifer bull. Dams WR 1/105.

## 107 Bull Calved: 2/18/07 Tattoo: 719 15794744

#Twin Valley Precision E161 #GAR Precision 1680  
+E&B E161 Precision 557 +WCC Blackcap C9  
+E&b 1483 Lady Scotchman 75 #RR 9440 Scotch Cap 1483  
Lady 183 Traveler 334

JD Daigger 901	#Sitz Alliance 6595	\$W						
E&B Lady Daigger 478	JD Queen Eisa 7021	+25.94						
E&B Everelda Queen 2151	#GDAR Rainmaker 340	\$F						
	E&b Blackbird Eve 058	+18.13						
CED	BW	WW	YW	Scrotal	CEM	Milk	\$EN	\$G
I+7	I+1.6	I+39	I+74	I+.30	I+8	I+24	+2.79	+16.91
Act. BW	Adj. WW	Adj. YW	%IMF	RE	Fat	\$B		
82	746	1256	I+.15	I+.27	I+.002	+33.43		

• The way this young bull is bred he should work on heifers with excellent maternal. Dams WR 2/102.

## 111 Bull Calved: 2/21/07 Tattoo: 732 15794749

+B/R New Frontier 095 #B/R New Design 036  
LD Hawkeye 211 White Fence Pride H1  
#LD 6807 Pride 9211 #DHD Traveler 6807  
Molitor 473 Pride 8432

LD Exactly 1912	#GAR Precision 1680	\$W						
E&B Lady Exactly 480	+LD Pride 1489 9124	+24.58						
E&B Lady Kenworth 215	+Aic Baldrige Kenworth I30K	\$F						
	#E&b Lady Dividend 629	+25.90						
CED	BW	WW	YW	Scrotal	CEM	Milk	\$EN	\$G
I+10	I+1.7	I+42	I+83	N/A	I+9	I+21	+2.81	+20.16
Act. BW	Adj. WW	Adj. YW	%IMF	RE	Fat	\$B		
84	712	1339	I+.21	I+.54	I+.003	+41.72		

• We have a great line-up of heifer bulls with a variety of pedigrees. Dams WR 2/103.

# B SPRING BULLS B

## 112 Bull Calved: 1/29/07 Tattoo: 733 15794750

#Bon View New Design 208 #B/R New Design 036  
E&B 208 New Design 573 #Bon View Erica 443  
E&B Lady Cornerstone 382 +HD Dunn Cornerstone 0245  
E&b 5706 Lady Arbitrator 866

+E&B 1680 Precision 1023		#GAR Precision 1680		\$W				
E&B Lady 1023 Precision 5039		E&b 6807 Lady Traveler 61		+35.98				
E&B Lady Kenworth 396		+Alc Baldridge Kenworth 130K		\$F				
		+E&B Lady Stacker 186		+21.65				
CED	BW	WW	YW	Scrotal	CEM	Milk	\$EN	\$G
I+8	I+0.1	I+53	I+83	N/A	I+8	I+27	-2.31	+22.74
Act. BW	Adj. WW	Adj. YW	%IMF	RE	Fat	\$B		
65	820	1282	I+.26	I+.57	I-.002	+44.26		

• These heifer bulls have great growth, maternal and carcass. Excellent pedigree here. Dams WR 1/112.

## 113 Bull Calved: 1/31/07 Tattoo: 734 15807849

#B/R New Design 036 #VDAR New Trend 315  
+Lemmon Newline C804 B/R Blackcap Empress 76  
White Fence Pride H1 #Connealy Dateline  
#Pleasant Pill of Conanga

+E&B 1680 Precision 1023		#GAR Precision 1680		\$W				
E&B Lady 1023 Precision 4111		E&b 6807 Lady Traveler 61		+28.40				
E&b 4137 Lady Dominette 683		#Gardens EXT 4137 S2		\$F				
		Lady 1001 Traveler 403		+24.35				
CED	BW	WW	YW	Scrotal	CEM	Milk	\$EN	\$G
I+7	I+1.8	I+46	I+83	N/A	I+9	I+25	-5.8	+19.69
Act. BW	Adj. WW	Adj. YW	%IMF	RE	Fat	\$B		
84	760	1400	I+.19	I+.33	I-.014	+41.25		

• This young bull is out of a really good 1023 daughter. He should work on heifers. Dams WR 2/104.

## 114 Bull Calved: 2/04/07 Tattoo: 736 15807850

Ironwood New Design 022 701 #B/R New Design 036  
Ironwood New Level Wardens Lady 022 5410  
Wardens Blackcap 6148 6309 #Finks 5522-6148  
Wardens Blackcap SC 025

#Connealy Freightliner		#Bon View Bando 598		\$W				
E&B Lady Freightliner 510		Joana Erica of Conanga		+27.11				
+E&b Lady Transformer 643		#Transformer 100 EAR		\$F				
		#Lady Skylar 1075		+28.94				
CED	BW	WW	YW	Scrotal	CEM	Milk	\$EN	\$G
I+8	I+0.1	I+42	I+86	N/A	I+5	I+27	-3.13	+14.06
Act. BW	Adj. WW	Adj. YW	%IMF	RE	Fat	\$B		
67	686	1310	I+.13	I+.31	I+.023	+36.57		

• These young heifer type bulls have a very good spread from birth to yearling. We really like the Freightliner daughters. Dams WR 1/93.

## 115 Bull Calved: 1/23/07 Tattoo: 740 15794755

#B/R New Design 036 #VDAR New Trend 315  
+E&B New Design 3133 B/R Blackcap Empress 76  
E&b 6807 Lady Traveler 61 #DHD Traveler 6807  
Lady 963 Dividend 404

+HD Dunn Cornerstone 0245		Sitz Traveler 7594		\$W				
E&B Lady Cornerstone 552		#Dixie Erica of CH 6180		+26.27				
+E&B Lady Precision 2147		#GAR Precision 1680		\$F				
		+E&d 7040 Lady Stacker 671		+20.53				
CED	BW	WW	YW	Scrotal	CEM	Milk	\$EN	\$G
I+9	I+1.6	I+43	I+78	N/A	I+6	I+19	+5.87	+14.04
Act. BW	Adj. WW	Adj. YW	%IMF	RE	Fat	\$B		
76	767	1388	I+.10	I+.20	I+.000	+32.94		

• You will like the 3133 sons as heifer bulls and you will love the replacement heifers. Dams WR 1/104.

## 116 Bull Calved: 2/06/07 Tattoo: 743 15807851

#B/R New Design 036 #VDAR New Trend 315  
GAR Predestined B/R Blackcap Empress 76  
#+GAR Ext 4206 #N Bar Emulation EXT  
+GAR 6807 Traveler 1432

Pine Ridge Focal Point L035		#SAF Focus of ER		\$W				
E&B Lady Focal Point 451		#Belmont Enchantress Exp 9049		+27.85				
E&b 5667 Lady Regal 781		CH Regal 5667		\$F				
		Lady 228 Stepahead 464		+34.38				
CED	BW	WW	YW	Scrotal	CEM	Milk	\$EN	\$G
I+6	I+1.6	I+49	I+94	N/A	I+8	I+25	-3.70	+23.50
Act. BW	Adj. WW	Adj. YW	%IMF	RE	Fat	\$B		
76	710	1315	I+.44	I+.46	I+.022	+50.11		

• This is a good Predestined son that will work well on your cows. Dams WR 2/98.

## 117 Bull Calved: 2/22/07 Tattoo: 744 15794675

Dalebanks Centennial 2526 #Bon View New Design 878  
Dalebanks Centennial 4670 #Witch of Dalebanks 9067  
#Enamel 1614 of Dalebanks Dalebanks Emulation Ext 3383  
#Enamel 4054 of Dalebanks

#Bon View Bando 598		#Tehama Bando 155		\$W				
+E&B Lady 598 Bando 448		#Bon View Dora 56		+27.43				
E&b 6807 Lady Traveler 61		#DHD Traveler 6807		\$F				
		Lady 963 Dividend 404		+28.61				
CED	BW	WW	YW	Scrotal	CEM	Milk	\$EN	\$G
I+5	I+1.9	I+48	I+88	I+.15	I+6	I+22	+5.6	+15.56
Act. BW	Adj. WW	Adj. YW	%IMF	RE	Fat	\$B		
82	779	1422	I+.18	I+.26	I+.008	+39.44		

• This is a very good Centennial son out of a great 598 cow. Note the 61 cow on the bottom side of the pedigrees. 448 is one of our best. Dams WR 2/108.

## 118 Bull Calved: 3/12/07 Tattoo: 746 15794759

#GAR Precision 1680 #Tehama Bando 155  
+E&B 1680 Precision 295 9J9 GAR 856  
E&b 4137 Lady Dominique 794 #Gardens EXT 4137 S2  
Lady Scotch Traveler 321

+Leachman Arbitrator		#Paramont Ambush 2172		\$W				
E&b Lady Arbitrator 713		Leachman Blackbird 9053		+24.52				
Lady 1483 Scotchmaid 574		#RR 9440 Scotch Cap 1483		\$F				
		Lady Stacker 1087		+15.05				
CED	BW	WW	YW	Scrotal	CEM	Milk	\$EN	\$G
I+5	I+3.2	I+42	I+72	I+.17	I+7	I+21	+5.88	+23.17
Act. BW	Adj. WW	Adj. YW	%IMF	RE	Fat	\$B		
89	807	1391	I+.25	I+.37	I-.013	+38.56		

• This is a good, well balanced 295 bull. Dams WR 6/107.

## 119 Bull Calved: 3/18/07 Tattoo: 749 15794760

+HA Power Alliance 1025 #Sitz Alliance 6595  
E&B Power Alliance 5152 +HA Rito Lady 4167  
E&B Lady Cornerstone 2121 +HD Dunn Cornerstone 0245  
E&b 4137 Lady Dominett 862

+HD Dunn Cornerstone 0245		Sitz Traveler 7594		\$W				
E&B Lady Cornerstone 354		#Dixie Erica of CH 6180		+27.00				
+E&b Lady Erica 077		#N Bar Emulation EXT		\$F				
		Lady 71 Traveler 346		+22.58				
CED	BW	WW	YW	Scrotal	CEM	Milk	\$EN	\$G
I+3	I+2.3	I+48	I+82	N/A	I+3	I+18	+5.57	+14.98
Act. BW	Adj. WW	Adj. YW	%IMF	RE	Fat	\$B		
80	788		I+.17	I+.36	I+.022	+36.06		

• 5152 is a very good Power Alliance bull we decided to keep as Power Alliance is no longer working. This is his 1st calf. Dams WR 2/107.

# B SPRING BULLS B

## 120 Bull Calved: 3/03/07 Tattoo: 751 15794761

#Bon View New Design 878 #B/R New Design 036  
 +E&B 878 New Design 4114 Bon View Gammer 85  
 +E&d Lady 6807 796 #DHD Traveler 6807  
 Lady 183 Traveler 334

+E&B 1680 Precision 295 #GAR Precision 1680  
 E&B Lady 295 Precision 4118 E&b 4137 Lady Dominique 794  
 +E&b Everelda Maid 004 #Sitz Traveler 9929  
 Lady Dividend 382

CED	BW	WW	YW	Scrotal	CEM	Milk	\$EN	\$W
I+6	I+4.7	I+39	I+68	N/A	I+7	I+23	+5.30	+20.67
								\$F
								+12.33
								\$G
								+18.31
								\$B
								+31.20

• We think you will like these 4114 sons. We sure like the way he is bred. Great cows in the pedigree. Dams WR 2/98.

## 121 Bull Calved: 1/12/07 Tattoo: 760 15807720

BR Midland #Twin Valley Precision E161  
 Stevenson Midland 1543 BR Royal Lass 7036-19  
 Stevenson Rosebud 9271 #Rockn D Ambush 1531  
 #Stevenson Rosebud J716

+WCC Special Design L309 #Bon View New Design 878  
 E&B Lady Special Design 5006 N Bar Primrose 2424  
 E&B Lady Bonnie 226 #Gardens EXT 4137 S2  
 #E&b Lady 394 Shylock 966

CED	BW	WW	YW	Scrotal	CEM	Milk	\$EN	\$W
N/A	I+1.5	I+51	I+85	N/A	N/A	I+21	+2.25	+30.94
								\$F
								+24.41
								\$G
								+14.68
								\$B
								+37.06

• This Midland son should work on heifers. Dams WR 1/106.

## 122 Bull Calved: 1/13/07 Tattoo: 761 15807852

Ironwood New Design 022 701 #B/R New Design 036  
 Ironwood New Level Wardens Lady 022 5410  
 Wardens Blackcap 6148 6309 #Finks 5522-6148  
 Wardens Blackcap SC 025

+HA Power Alliance 1025 #Sitz Alliance 6595  
 E&B Lady Power Alliance 588 +HA Rito Lady 4167  
 E&b Lady 4137 Ext 945 #Gardens EXT 4137 S2  
 E&b Lady Arbitrator 7004

CED	BW	WW	YW	Scrotal	CEM	Milk	\$EN	\$W
I+9	I+1.3	I+43	I+74	N/A	I+6	I+28	-.67	+30.24
								\$F
								+16.62
								\$G
								+13.75
								\$B
								+30.30

• We added Ironwell New Level as a heifer bull with a little different pedigree. Dams WR 1/97.

## 123 Bull Calved: 2/03/07 Tattoo: 762 15807853

#Leachman Right Time #N Bar Emulation EXT  
 Hyline Right Time 338 Leachman Erica 0025  
 Hyline Pride 265 +Hyline SVF Traveler 0115  
 Hyline Pride 870

#Bon View New Design 878 #B/R New Design 036  
 +E&B Lady 878 New Design 444 Bon View Gammer 85  
 +E&d Lady 6807 796 #DHD Traveler 6807  
 Lady 183 Traveler 334

CED	BW	WW	YW	Scrotal	CEM	Milk	\$EN	\$W
I+7	I+2.7	I+47	I+89	N/A	I+6	I+28	-4.89	+26.23
								\$F
								+30.03
								\$G
								+13.33
								\$B
								+36.80

• These 338 bulls have tremendous growth with moderate birth. You have to like the cows in the bottom part of the pedigree. Dams WR 2/98.

## 124 Bull Calved: 2/15/07 Tattoo: 763 15794764

BR Midland #Twin Valley Precision E161  
 RR Midland 5166 BR Royal Lass 7036-19  
 #RR Revolution Rose 1663 #Hero 6267 of RR 2418  
 RR Revolution Rose 9700

#Bon View New Design 208 #B/R New Design 036  
 E&B Lady 208 New Design 5024 #Bon View Erica 443  
 E&B Lady Kenworth 399 +Alc Baldrige Kenworth I30K  
 +E&B Queen Kimberly 172

CED	BW	WW	YW	Scrotal	CEM	Milk	\$EN	\$W
I+8	I+1.0	I+43	I+76	N/A	I+6	I+27	-.35	+29.78
								\$F
								+18.57
								\$G
								+20.90
								\$B
								+38.74

• These Midland sons should work on heifers. Dams WR 1/102.

## 125 Bull Calved: 1/08/07 Tattoo: 764 15807854

#SS Traveler 6807 T510 #DHD Traveler 6807  
 GAR Solution #SS Miss Hi Spade A114  
 +GAR New Design 50 #B/R New Design 036  
 GAR Precision 2536

+HA Power Alliance 1025 #Sitz Alliance 6595  
 E&B Lady Power Alliance 522 +HA Rito Lady 4167  
 E&b 1483 Lady Scotch Cap 864 #RR 9440 Scotch Cap 1483  
 #Lady 228 Stepahead 469

CED	BW	WW	YW	Scrotal	CEM	Milk	\$EN	\$W
I+7	I+2.3	I+49	I+85	N/A	I+6	I+23	+.57	+28.46
								\$F
								+25.19
								\$G
								+27.68
								\$B
								+50.06

• This light birth weight Solution son should add carcass to his offspring. Dams WR 1/105.

## 126 Bull Calved: 2/12/07 Tattoo: 765 15794765

BR Midland #Twin Valley Precision E161  
 A&B Midland 5096 BR Royal Lass 7036-19  
 A&B Own Lass 9050 SVF Oscar 18E  
 A&b Lass 5037

#GDAR Traveler 71 #Traveler 1148 GDAR  
 +E&b Blackcap Lady 002 GDAR Miss Blackcap 567  
 Lady Stacker 365 #CH Stacker 7040  
 E&b Lady Viking 0867

CED	BW	WW	YW	Scrotal	CEM	Milk	\$EN	\$W
I+8	I+1.3	I+35	I+63	N/A	I+6	I+21	+8.34	+25.56
								\$F
								+9.06
								\$G
								+19.11
								\$B
								+28.41

• This Midland bred bull should work on heifers. Dams WR 6/97.

## 127 Bull Calved: 1/14/07 Tattoo: 7127 15807836

#DHD Traveler 6807 #OAS Traveler 23-4  
 #Rito 616 of 4B20 6807 #Bemindful Maid DHD 0807  
 +Rita 4B20 of OFB1 Bando #Tehama Bando 155  
 +Rita OFB1 of 5H11 Fullback

+WCC Special Design L309 #Bon View New Design 878  
 E&B Lady Special Design 5000 N Bar Primrose 2424  
 E&B Lady Precision 122 #GAR Precision 1680  
 E&b Lady 4137 Ext 964

CED	BW	WW	YW	Scrotal	CEM	Milk	\$EN	\$W
I+9	I+2.3	I+40	I+86	N/A	I+7	I+20	+2.80	+20.72
								\$F
								+29.73
								\$G
								+20.84
								\$B
								+42.88

• You will like the disposition and calving ease in these 616 sons. Dams WR 1/100.

# E B SPRING BULLS E B

## 128 Bull Calved: 1/25/07 Tattoo: 7128 15794686

#Sitz Alliance 6595 #Sitz Traveler 8180  
 +HA Power Alliance 1025 #Sitz Barbaramere Jet 2698  
 +HA Rito Lady 4167 #CH Stacker 7040  
 H 96 Band Lady 3714

#Bon View New Design 1407	#B/R New Design 036	\$W						
E&B Empress Pride 141	Bon View Pride 664	+20.92						
E&b Lady 1680 Precision 900	#GAR Precision 1680	\$F						
	E&b 4137 Lady Dominique 794	+29.17						
CED	BW	WW	YW	Scrotal	CEM	Milk	\$EN	\$G
I+5	I+4.1	I+44	I+87	I+.70	I+7	I+25	-1.71	+24.36
Act. BW	Adj. WW	Adj. YW	%IMF	RE	Fat	\$B		
91	714	1413	I+.37	I+.51	I+.008	+47.89		

• This is a good Power Alliance son with good growth, carcass and maternal numbers. Dams WR 4/98.

## 129 Bull Calved: 2/13/07 Tattoo: 7129 15794687

BR Midland #Twin Valley Precision E161  
 RR Midland 5166 BR Royal Lass 7036-19  
 #RR Revolution Rose 1663 #Hero 6267 of RR 2418  
 RR Revolution Rose 9700

#Bon View New Design 208	#B/R New Design 036	\$W						
E&B Lady 208 New Design 520	#Bon View Erica 443	+32.02						
E&B Lady Power Alliance 380	+HA Power Alliance 1025	\$F						
	E&b Bonnie Lady 037	+22.35						
CED	BW	WW	YW	Scrotal	CEM	Milk	\$EN	\$G
I+8	I-0.3	I+46	I+81	N/A	I+6	I+28	-2.63	+22.06
Act. BW	Adj. WW	Adj. YW	%IMF	RE	Fat	\$B		
64	742	1259	I+.34	I+.43	I+.019	+42.43		

• This is a well bred Midland son that your heifers will appreciate. Dams WR 1/101.

## 130 Bull Calved: 3/01/07 Tattoo: 7130 15794689

Dalebanks Centennial 2526 #Bon View New Design 878  
 Dalebanks Centennial 4670 #Witch of Dalebanks 9067  
 #Enamel 1614 of Dalebanks Dalebanks Emulation Ext 3383  
 #Enamel 4054 of Dalebanks

#Baldrige Jethro 75J	Baldrige Bob	\$W						
E&B Lady J 336	#JLB Queen Eva 424	+21.13						
+E&B Lady Precision 176	#GAR Precision 1680	\$F						
	E&b 6807 Lady Traveler 61	+28.78						
CED	BW	WW	YW	Scrotal	CEM	Milk	\$EN	\$G
I+6	I+4.1	I+45	I+87	N/A	I+4	I+23	+0.00	+16.30
Act. BW	Adj. WW	Adj. YW	%IMF	RE	Fat	\$B		
101	794	1453	I+.22	I+.18	I+.009	+39.82		

• This high growth, high maternal bull will work well on your cows. Dams WR 2/109.

## 131 Bull Calved: 1/12/07 Tattoo: 7131 15807837

Ironwood New Design 022 701 #B/R New Design 036  
 Ironwood New Level Wardens Lady 022 5410  
 Wardens Blackcap 6148 6309 #Finks 5522-6148  
 Wardens Blackcap SC 025

+ALC National T60N	#Twin Valley Precision E161	\$W						
E&B Lady National 511	#ALC Blackcap E03F	+29.39						
+E&B Everelda Maid 143	#Sitz Traveler 9929	\$F						
	Lady Stacker 308	+36.29						
CED	BW	WW	YW	Scrotal	CEM	Milk	\$EN	\$G
I+7	I+1.7	I+52	I+97	N/A	I+6	I+27	-6.30	+12.49
Act. BW	Adj. WW	Adj. YW	%IMF	RE	Fat	\$B		
74	789	1434	I+.12	I+.33	I+.012	+40.26		

• This moderate birth weight New Level could be used on heifers. Dams WR 1/107.

## 132 Bull Calved: 1/06/07 Tattoo: 7132 15807838

#+SAF 598 Bando 5175 #Bon View Bando 598  
 +HSAF Bando 1961 +SAF Royal Lass 1002  
 +JKS Miss Cheyenne 196 #N Bar Emulation EXT  
 +Magic Meadow Miss Cheyenne

LD Hawkeye 211	+B/R New Frontier 095	\$W						
E&B Lady Hawkeye 597	#LD 6807 Pride 9211	+25.81						
E&b Lady 1680 Precision 900	#GAR Precision 1680	\$F						
	E&b 4137 Lady Dominique 794	+26.91						
CED	BW	WW	YW	Scrotal	CEM	Milk	\$EN	\$G
I+7	I+1.5	I+42	I+84	N/A	I+8	I+25	-8.6	+19.61
Act. BW	Adj. WW	Adj. YW	%IMF	RE	Fat	\$B		
75	680	1309	I+.28	I+.23	I+.006	+41.62		

• This well bred 1961 will work well on virgin heifers. Dams WR 1/93.

## 133 Bull Calved: 2/17/07 Tattoo: 7133 15794690

#Twin Valley Precision E161 #GAR Precision 1680  
 +ALC National T60N +WCC Blackcap C9  
 #ALC Blackcap E03F #N Bar Emulation EXT  
 Bon View Blackcap 1330

#RR 9440 Scotch Cap 1483	#RR Scotchcap 9440	\$W						
+E&b 1483 Lady Scotchman 826	Eriskay of Rollin Rock 8211	+22.51						
Lady 228 Stepahead 473	+Finks Stepahead	\$F						
	Lady Stacker B24	+37.74						
CED	BW	WW	YW	Scrotal	CEM	Milk	\$EN	\$G
I+2	I+3.6	I+51	I+98	I+.29	I+6	I+20	-6.4	+8.00
Act. BW	Adj. WW	Adj. YW	%IMF	RE	Fat	\$B		
85	794	1407	I+.06	I+.28	I+.023	+36.07		

• 7133's dam 826 is one of the better older cows on the place. If you need to add growth and maternal to your herd, this bull will do the job on your cows. Dams WR 8/105.

## 134 Bull Calved: 2/20/07 Tattoo: 7134 15794691

#Bon View New Design 878 #B/R New Design 036  
 +E&B 878 New Design 4114 Bon View Gammer 85  
 +E&d Lady 6807 796 #DHD Traveler 6807  
 Lady 183 Traveler 334

#Baldrige Jethro 75J	Baldrige Bob	\$W						
E&B Lady J 364	#JLB Queen Eva 424	+21.35						
+E&B Lady Precision 176	#GAR Precision 1680	\$F						
	E&b 6807 Lady Traveler 61	+20.47						
CED	BW	WW	YW	Scrotal	CEM	Milk	\$EN	\$G
I+9	I+3.3	I+38	I+76	I+.61	I+7	I+25	+1.38	+13.23
Act. BW	Adj. WW	Adj. YW	%IMF	RE	Fat	\$B		
95	696	1344	I+.10	I+.33	I+.018	+30.85		

• This moderate birth weight 4114 is well bred on the bottom part of the pedigree. Dams WR 3/99.

## 135 Bull Calved: 1/27/07 Tattoo: 7135 15807839

#DHD Traveler 6807 #OAS Traveler 23-4  
 #Rito 616 of 4B20 6807 #Bemindful Maid DHD 0807  
 +Rita 4B20 of OFB1 Bando #Tehama Bando 155  
 +Rita OFB1 of 5H11 Fullback

#Bon View New Design 208	#B/R New Design 036	\$W						
E&B Lady 208 New Design 5008	#Bon View Erica 443	+25.20						
+E&B Lady Precision 306	#GAR Precision 1680	\$F						
	+E&d Lady 6807 767	+26.69						
CED	BW	WW	YW	Scrotal	CEM	Milk	\$EN	\$G
I+10	I+1.2	I+40	I+83	N/A	I+7	I+26	-1.44	+24.49
Act. BW	Adj. WW	Adj. YW	%IMF	RE	Fat	\$B		
79	699	1267	I+.23	I+.40	I+.002	+45.06		

• This 616 son is a true heifer bull. You could not write a better pedigree. You need to look this bull up. Dams WR 1/96.

# B SPRING BULLS B

## 136 Bull **E&B Popatop 7136** Calved: 1/04/07 Tattoo: 7136 15794692

#Hero 6267 of RR 2418 #RR Hero 6267  
RR Popatop 0600 RR Everelda Entense 0413  
Erica Lassie of RR 2407 #Sitz Rito 9819  
Erica Lassie of RR 6313

LD Hawkeye 211		+B/R New Frontier 095		\$W				
E&B Lady Hawkeye 5041		#LD 6807 Pride 9211		+30.27				
+E&B Lady Precision 2105		#GAR Precision 1680		\$F				
		S&S Zara 3025		+19.55				
CED	BW	WW	YW	Scrotal	CEM	Milk	\$EN	\$G
N/A	I+0.8	I+43	I+77	N/A	N/A	I+30	-3.28	
Act. BW	Adj. WW	Adj. YW	%IMF		RE	Fat	\$B	
76	771	1336						

• This is another great heifer bull prospect. This bull is a cow maker on the top and bottom side of the pedigree. Dams WR 1/106.

## 137 Bull **E&B 1123 Precision 7137** Calved: 2/19/07 Tattoo: 7137 15794693

#GAR Precision 1680 #Tehama Bando 155  
E&B 1680 Precision 1123 9J9 GAR 856  
E&b 4137 Ext 9004 #Gardens EXT 4137 S2  
+E&d 71 Lady Traveler 677

+E&B Lady Focus 309		#SAF Fame		\$W				
#E&b Lady 1680 Precision 921		GDAR Forever Lady 246		+26.55				
		#GAR Precision 1680		\$F				
		E&b 5667 Lady Regal 788		+14.62				
CED	BW	WW	YW	Scrotal	CEM	Milk	\$EN	\$G
I+9	I+0.3	I+38	I+70	N/A	I+10	I+20	+7.26	+17.28
Act. BW	Adj. WW	Adj. YW	%IMF		RE	Fat	\$B	
73	661	1154	I+.22		I+.24	I+.021	+31.42	

• Another well bred heifer bull prospect. Dams WR 3/96.

## 138 Bull **E&B 5096 Midland 713** Calved: 2/10/07 Tattoo: 713 15794688

BR Midland #Twin Valley Precision E161  
A&B Midland 5096 BR Royal Lass 7036-19  
A&B Own Lass 9050 SVF Oscar 18E  
A&b Lass 5037

+E&B Everelda Queen 170		#Lovana		\$W				
E&b 6807 Lady Traveler 61		#Lady Blackbird 987 GDAR		+26.76				
		#DHD Traveler 6807		\$F				
		Lady 963 Dividend 404		+12.48				
CED	BW	WW	YW	Scrotal	CEM	Milk	\$EN	\$G
I+8	I-0.3	I+36	I+67	N/A	I+7	I+21	+7.25	+22.74
Act. BW	Adj. WW	Adj. YW	%IMF		RE	Fat	\$B	
72	682	1199	I+.33		I+.24	I+.011	+34.94	

• This Midland son is out of a very good Rainmaker cow 170. She goes back to the Traveler 61 cow. This bull will work on heifers. Dams WR 5/100.

## 139 Bull **E&B Hawkeye 7139** Calved: 2/15/07 Tattoo: 7139 15794695

+B/R New Frontier 095 #B/R New Design 036  
LD Hawkeye 211 White Fence Pride H1  
#LD 6807 Pride 9211 #DHD Traveler 6807  
Molitor 473 Pride 8432

+E&B Lady New Day 342		#AAR New Trend		\$W				
Lady 107 Rito Traveler 508		SVF Forever Lady 57D		+23.84				
		RR Traveler 1001		\$F				
		Lady Stacker 353		+16.71				
CED	BW	WW	YW	Scrotal	CEM	Milk	\$EN	\$G
I+8	I+0.5	I+35	I+71	N/A	I+5	I+20	+6.99	+17.43
Act. BW	Adj. WW	Adj. YW	%IMF		RE	Fat	\$B	
75	659	1176	I+.15		I+.37	I+.007	+32.17	

• This well bred Hawkeye son will work on heifers. Dams WR 3/95.

## 140 Bull **E&B Power Alliance 767** Calved: 2/05/07 Tattoo: 767 15794767

#Sitz Alliance 6595 #Sitz Traveler 8180  
+HA Power Alliance 1025 #Sitz Barbaramere Jet 2698  
+HA Rito Lady 4167 #CH Stacker 7040  
H 96 Band Lady 3714

E&B 1407 New Design 116		#Bon View New Design 1407		\$W				
E&B Lady 116 New Design 481		E&b 6807 Lady Traveler 61		+24.99				
E&B Lady Quantum 286		#CH Quantum 3330		\$F				
		E&b 4137 Dominett 89		+32.14				
CED	BW	WW	YW	Scrotal	CEM	Milk	\$EN	\$G
I+4	I+4.2	I+52	I+93	N/A	I+6	I+26	-4.28	+14.00
Act. BW	Adj. WW	Adj. YW	%IMF		RE	Fat	\$B	
91	757	1320	I+.08		I+.46	I+.000	+39.91	

• This is a very good Power Alliance with a moderate birth weight. He will work well on cows and his offspring of heifer calves will be the kind you would want to raise. Dams WR 2/106.

## 141 Bull **E&B 5166 Midland 7141** Calved: 2/21/07 Tattoo: 7141 15794697

BR Midland #Twin Valley Precision E161  
RR Midland 5166 BR Royal Lass 7036-19  
#RR Revolution Rose 1663 #Hero 6267 of RR 2418  
RR Revolution Rose 9700

+E&B Lady 1407 New Design 533		#B/R New Design 036		\$W				
+E&b 1483 Lady Scotchman 75		Bon View Pride 664		+26.54				
		#RR 9440 Scotch Cap 1483		\$F				
		Lady 183 Traveler 334		+27.14				
CED	BW	WW	YW	Scrotal	CEM	Milk	\$EN	\$G
N/A	I+1.6	I+44	I+85	N/A	N/A	I+24	-2.8	+24.23
Act. BW	Adj. WW	Adj. YW	%IMF		RE	Fat	\$B	
75	743	1319	I+.39		I+.37	I+.006	+46.65	

• These Midland sons should work well on heifers. Dams WR 1/101.

## 142 Bull **E&B 3133 New Design 7142** Calved: 2/21/07 Tattoo: 7142 15794698

#B/R New Design 036 #VDAR New Trend 315  
+E&B New Design 3133 B/R Blackcap Empress 76  
E&b 6807 Lady Traveler 61 #DHD Traveler 6807  
Lady 963 Dividend 404

+LD Axis 1410		#Bon View Bando 598		\$W				
E&B Lady Axis 5048		Hinksons Erica 9310		+27.99				
+E&B Lady Focus 309		#SAF Focus of ER		\$F				
		#E&b Lady 1680 Precision 921		+14.03				
CED	BW	WW	YW	Scrotal	CEM	Milk	\$EN	\$G
I+11	I-1.1	I+37	I+69	N/A	I+11	I+22	+5.87	+15.77
Act. BW	Adj. WW	Adj. YW	%IMF		RE	Fat	\$B	
62	672	1229	I+.16		I+.10	I+.008	+29.27	

• This should be a calving ease deluxe. Dams WR 1/92.

## 143 Bull **E&B K526 Glory 7143** Calved: 3/26/07 Tattoo: 7143 15794699

#OCC Glory 950G +OCC Exodus 712E  
Koupals Glory 526 OCC Dixie Erica 971E  
#Koupals Flower 072 #+OCC Edison 801E  
Beefland Flower 675

+E&B Lady 1407 New Design 447		#B/R New Design 036		\$W				
+E&B Lady Precision 176		Bon View Pride 664		+32.91				
		#GAR Precision 1680		\$F				
		E&b 6807 Lady Traveler 61		+32.14				
CED	BW	WW	YW	Scrotal	CEM	Milk	\$EN	\$G
I+11	I-0.5	I+52	I+93	N/A	I+6	I+27	-5.15	+16.02
Act. BW	Adj. WW	Adj. YW	%IMF		RE	Fat	\$B	
61	741		I+.14		I+.32	I+.040	+41.94	

• This is a moderate birth weight Glory son out of a very good cow family on the bottom side. Dams WR 2/102.

# B SPRING BULLS B

## 144 E&B 557 E161 Precision 771

**Bull Calved: 2/22/07 Tattoo: 771 15794771**  
 #Twin Valley Precision E161 #GAR Precision 1680  
 +E&B E161 Precision 557 +WCC Blackcap C9  
 +E&b 1483 Lady Scotchman 75 #RR 9440 Scotch Cap 1483  
 Lady 183 Traveler 334

#B/R New Design 036		#VDAR New Design 315		\$W				
E&B Lady New Design		B/R Blackcap Empress 76		+19.74				
E&b 4137 Lady Dominique 794		#Gardens EXT 4137 S2		\$F				
		Lady Scotch Traveler 321		+16.50				
CED	BW	WW	YW	Scrotal	CEM	Milk	\$EN	\$G
I+7	I+2.7	I+33	I+70	I+.39	I+8	I+22	+5.59	+24.24
Act. BW	Adj. WW	Adj. YW	%IMF	RE	Fat	\$B		
87	655	1263	I+.29	I+.58	I+.007	+38.34		

• This E161 grandson is a moderate birth weight bull with good cows in the pedigree. He should work well on cows. Dams WR 4/99.

## 148 E&B K526 Glory 7148

**Bull Calved: 3/05/07 Tattoo: 7148 15794703**  
 #OCC Glory 950G +OCC Exodus 712E  
 Koupals Glory 526 OCC Dixie Erica 971E  
 #Koupals Flower 072 #+OCC Edison 801E  
 Beefland Felson 675

+Alc Baldrige Kenworth I30K		#Connealy Dateline		\$W				
E&B Lady Kenworth 396		+Alc Baldrige Primroselady54F		+24.26				
+E&B Lady Stacker 186		#CH Stacker 7040		\$F				
		Sandhill Dee 41 Jewel		+12.54				
CED	BW	WW	YW	Scrotal	CEM	Milk	\$EN	\$G
I+5	I+2.9	I+41	I+69	I+.19	I+5	I+18	+9.18	+16.34
Act. BW	Adj. WW	Adj. YW	%IMF	RE	Fat	\$B		
85	741	1242	I+.11	I+.51	I+.015	+29.90		

• This is a very good moderate birth weight bull that will work well on cows. Dams WR 3/101.

## 145 E&B Power Alliance 717

**Bull Calved: 1/17/07 Tattoo: 717 15794725**  
 #Sitz Alliance 6595 #Sitz Traveler 8180  
 +HA Power Alliance 1025 #Sitz Barbaramere Jet 2698  
 +HA Rito Lady 4167 #CH Stacker 7040  
 H 96 Band Lady 3714

GAR Retail Product		#GAR Precision 1680		\$W				
E&B Lady Retail Product 5034		+GAR Ext 4927		+24.30				
E&b 1483 Lady Scotchman 822		#RR 9440 Scotch Cap 1483		\$F				
		Lady Stacker 308		+22.96				
CED	BW	WW	YW	Scrotal	CEM	Milk	\$EN	\$G
I+4	I+4.3	I+47	I+82	N/A	I+4	I+26	-1.16	+22.37
Act. BW	Adj. WW	Adj. YW	%IMF	RE	Fat	\$B		
85	761	1254	I+.29	I+.52	I+.008	+43.44		

• This is a well bred moderate birth weight bull with very good carcass numbers and will work on cows and will leave you top replacement females. Dams WR 1/104.

## 149 E&B 616 7149

**Bull Calved: 2/02/07 Tattoo: 7149 15797077**  
 #DHD Traveler 6807 #OAS Traveler 23-4  
 #Rito 616 of 4B20 6807 #Bemindful Maid DHD 0807  
 +Rita 4B20 of 0FB1 Bando #Tehama Bando 155  
 +Rita 0FB1 of 5H11 Fullback

+Alc Baldrige Kenworth I30K		#Connealy Dateline		\$W				
E&B Lady Kenworth 5023		+Alc Baldrige Primroselady54F		+25.93				
E&b Everelda Queen 0122		#GDAR Rainmaker 340		\$F				
		E&b Lady Ext 8100		+23.90				
CED	BW	WW	YW	Scrotal	CEM	Milk	\$EN	\$G
I+10	I+0.5	I+42	I+81	N/A	I+8	I+19	+5.03	+15.06
Act. BW	Adj. WW	Adj. YW	%IMF	RE	Fat	\$B		
73	776	1389	I+.10	I+.37	I+.001	+35.44		

• Excellent calving ease 616 son with lots of growth. WR 1/106.

## 146 E&B Yield Grade 7146

**Bull Calved: 1/26/07 Tattoo: 7146 15807841**  
 #GAR Precision 1680 #Tehama Bando 155  
 +GAR Yield Grade 9J9 GAR 856  
 +GAR Ext 4526 #N Bar Emulation EXT  
 +GAR 6807 Traveler 93

S&S Traveler 6807-6		#DHD Traveler 6807		\$W				
E&B Blackbird Pride 218		#S&S Pride 1922		+22.43				
E&b 5706 Arbitrator 8104		+Leachman Arbitrator		\$F				
		Lady 1001 Traveler 431		+29.57				
CED	BW	WW	YW	Scrotal	CEM	Milk	\$EN	\$G
I+8	I+2.4	I+43	I+87	I+.67	I+9	I+20	+2.51	+12.41
Act. BW	Adj. WW	Adj. YW	%IMF	RE	Fat	\$B		
85	693	1282	I+.09	I+.23	I+.004	+35.96		

• This Yield Grade son is moderate birth with great numbers. He will work well on cows. Dams WR 4/98.

## 150 E&B National 772

**Bull Calved: 2/17/07 Tattoo: 772 15794772**  
 #Twin Valley Precision E161 #GAR Precision 1680  
 +ALC National T60N +WCC Blackcap C9  
 #ALC Blackcap E03F #N Bar Emulation EXT  
 Bon View Blackcap 1330

#Gardens EXT 4137 S2		#N Bar Emulation EXT		\$W				
E&B Lady Bonnie 103		#Green Garden Bonnie 1134 S1		+25.66				
E&b Lady 744 Bouncer 947		+Lukens 6807 Bouncer 744		\$F				
		+E&b Lady Krugerrand 7001		+33.74				
CED	BW	WW	YW	Scrotal	CEM	Milk	\$EN	\$G
I+6	I+1.6	I+48	I+93	I+.75	I+8	I+19	+1.63	+11.54
Act. BW	Adj. WW	Adj. YW	%IMF	RE	Fat	\$B		
80	719	1359	I+.12	I+.08	I+.005	+37.50		

• This is a top notch National son out of a top cow. Treat your cows with this bull. Dams WR 5/105.

## 147 E&B 4670 Centennial 7147

**Bull Calved: 3/09/07 Tattoo: 7147 15794702**  
 Dalebanks Centennial 2526 #Bon View New Design 878  
 Dalebanks Centennial 4670 #Witch of Dalebanks 9067  
 #Enamel 1614 of Dalebanks Dalebanks Emulation Ext 3383  
 #Enamel 4054 of Dalebanks

+Car Don Shylock B394		#Traveler 1148 GDAR		\$W				
E&B Forever Lady 161		+Car Don Mss Traveler B226		+25.39				
E&b Lady 1680 Precision 940		#GAR Precision 1680		\$F				
		E&b 1483 Lady Scotchman 760		+27.53				
CED	BW	WW	YW	Scrotal	CEM	Milk	\$EN	\$G
I+6	I+1.3	I+43	I+85	I+.05	I+6	I+21	+2.25	+17.59
Act. BW	Adj. WW	Adj. YW	%IMF	RE	Fat	\$B		
82	780	1508	I+.19	I+.28	I-.002	+40.02		

• This is a real good bull with good cows in the pedigree. Dams WR 5/100.

## 151 E&B National 7151

**Bull Calved: 3/11/07 Tattoo: 7151 15794706**  
 #Twin Valley Precision E161 #GAR Precision 1680  
 +ALC National T60N +WCC Blackcap C9  
 #ALC Blackcap E03F #N Bar Emulation EXT  
 Bon View Blackcap 1330

+Alc Baldrige Kenworth I30K		#Conneal Dateline		\$W				
E&B Lady Kenworth 436		+Alc Baldrige Primroselady54F		+23.30				
E&b Everelda Queen 094		#GDAR Rainmaker 340		\$F				
		E&b 5667 Lady Regal 8200		+24.96				
CED	BW	WW	YW	Scrotal	CEM	Milk	\$EN	\$G
I+6	I+3.6	I+47	I+84	I+.41	I+8	I+19	+4.19	+13.53
Act. BW	Adj. WW	Adj. YW	%IMF	RE	Fat	\$B		
90	748	1306	I+.16	I+.17	I+.015	+35.50		

• This is a good National son out of a low birth weight cow family. Dams WR 2/99.

# B SPRING BULLS B

## 152 E&B 3133 New Design 7152

**Bull Calved: 2/04/07 Tattoo: 7152 15794707**  
 #B/R New Design 036 #VDAR New Trend 315  
 +E&B New Design 3133 B/R Blackcap Empress 76  
 E&b 6807 Lady Traveler 61 #DHD Traveler 6807  
 Lady 963 Dividend 404

+LD Axis 1410 #Bon View Bando 598  
 E&B Lady Axis 515 Hinksons Erica 9310  
 +E&B Lady Precision 314 #GAR Precision 1680  
 E&b 5667 Lady Regal 788

CED	BW	WW	YW	Scrotal	CEM	Milk	\$EN	\$W
I+11	I-1.5	I+37	I+72	N/A	I+11	I+22	+5.04	+27.51
								\$F
								+16.93
								\$G
								+17.78
								\$B
								+33.13

• These 3133 sons are not only light birth weight they are the right kind that will leave you tremendous replacements. Dams WR 1/94.

## 153 E&B 557 E161 Precision 773

**Bull Calved: 2/25/07 Tattoo: 773 15794773**  
 #Twin Valley Precision E161 #GAR Precision 1680  
 +E&B E161 Precision 557 +WCC Blackcap C9  
 +E&b 1483 Lady Scotchman 75 #RR 9440 Scotch Cap 1483  
 Lady 183 Traveler 334

#GDAR Rainmaker 340 #Lovana  
 E&B Everelda Queen 214 #Lady Blackbird 987 GDAR  
 E&b Forever Lady 036 +Car Don Shylock B394  
 +E&b Ext 8112

CED	BW	WW	YW	Scrotal	CEM	Milk	\$EN	\$W
I+8	I+2.2	I+34	I+74	I+.24	I+10	I+24	+2.79	+20.98
								\$F
								+20.03
								\$G
								+15.61
								\$B
								+32.11

• This E161 grandson is out of one of our top Rainmaker 340 daughters. This good bull will work on heifers. Dams WR 2/105.

## 154 E&B 4670 Centennial 774

**Bull Calved: 3/11/07 Tattoo: 774 15794774**  
 Dalebanks Centennial 2526 #Bon View New Design 878  
 Dalebanks Centennial 4670 #Witch of Dalebanks 9067  
 #Enamel 1614 of Dalebanks Dalebanks Emulation Ext 3383  
 #Enamel 4054 of Dalebanks

+HA Power Alliance 1025 #Sitz Alliance 6595  
 E&B Lady Power Alliance 4113 +HA Rito Lady 4167  
 Lady 1001 Traveler 323 RR Traveler 1001  
 Lady Traveler B57

CED	BW	WW	YW	Scrotal	CEM	Milk	\$EN	\$W
I+4	I+3.4	I+42	I+81	N/A	I+4	I+21	+3.37	+21.58
								\$F
								+23.90
								\$G
								+16.49
								\$B
								+36.87

• This is a moderate birth weight Centennial son. Cows on the bottom side of the pedigree are the right kind. Dams WR 2/97.

## 155 E&B 4670 Centennial 776

**Bull Calved: 1/28/07 Tattoo: 776 15794776**  
 Dalebanks Centennial 2526 #Bon View New Design 878  
 Dalebanks Centennial 4670 #Witch of Dalebanks 9067  
 #Enamel 1614 of Dalebanks Dalebanks Emulation Ext 3383  
 #Enamel 4054 of Dalebanks

#Gardens EXT 4137 S2 #N Bar Emulation EXT  
 E&b 4137 Lady Dominett 862 #Green Garden Bonnie 1134 S1  
 Lady 90 Stacker 339 E&b Stacker 190  
 Lady Traveler 158

CED	BW	WW	YW	Scrotal	CEM	Milk	\$EN	\$W
I+4	I+2.8	I+43	I+91	I+.37	I+5	I+16	+4.63	+19.03
								\$F
								+33.68
								\$G
								+13.24
								\$B
								+38.61

• A powerful bull that is out of one of our top older cows. Treat your cows to this top notch bull. Dams WR 8/100.

## 156 E&B Power Alliance 777

**Bull Calved: 2/06/07 Tattoo: 777 15794777**  
 #Sitz Alliance 6595 #Sitz Traveler 8180  
 +HA Power Alliance 1025 #Sitz Barbaramere Jet 2698  
 +HA Rito Lady 4167 #CH Stacker 7040  
 H 96 Band Lady 3714

#Bon View New Design 878 #B/R New Design 036  
 +E&B Lady 878 New Design 437 Bon View Gammer 85  
 +E&d Lady 6807 796 #DHD Traveler 6807  
 Lady 183 Traveler 334

CED	BW	WW	YW	Scrotal	CEM	Milk	\$EN	\$W
I+6	I+1.7	I+39	I+81	N/A	I+7	I+26	-.88	+24.27
								\$F
								+25.06
								\$G
								+19.52
								\$B
								+39.91

• 777 is a well bred Power Alliance son that was injured for a short time and slowed his performance. Although he is fine now he could be a sleeper in the sale. Dams WR 2/96.

## 157 E&B 295 Precision 7157

**Bull Calved: 2/19/07 Tattoo: 7157 15794712**  
 #GAR Precision 1680 #Tehama Bando 155  
 +E&B 1680 Precision 295 9J9 GAR 856  
 E&b 4137 Lady Dominique 794 #Gardens EXT 4137 S2  
 Lady Scotch Traveler 321

+E&d 6807 793 #DHD Traveler 6807  
 E&B Blackbird Eve 276 Lady 183 Traveler 334  
 E&b 409 Lady Duke 667 E&b 228 High Time 409  
 #Lady 6807 Traveler 316

CED	BW	WW	YW	Scrotal	CEM	Milk	\$EN	\$W
I+7	I+1.8	I+42	I+80	N/A	I+7	I+19	+5.31	+24.57
								\$F
								+22.90
								\$G
								+21.76
								\$B
								+41.66

• This is a well made 295 that is bred right. This bull will work great on cows. Dams WR 4/99.



## LiveAuctions.TV

Real-time bidding is available via the internet. Live audio and live video will allow buyers to bid on Lots just as if they were present at the sale. Go to <http://www.liveauctions.tv>. If you cannot attend the sale because of weather, distance or business conflicts, please use LiveAuctions.tv. Call (sale management) for assistance.

# B SPRING BULLS B

## 158 Bull Calved: 1/31/07 Tattoo: 778 15807855

#+Leachman Right Time  
 Hyline Right Time 338  
 Hyline Pride 265

#N Bar Emulation EXT  
 Leachman Erica 0025  
 +Hyline SVF Traveler 0115  
 Hyline Pride 870

								\$W
								+23.82
								\$F
								+37.92
								\$G
								+14.86
								\$B
								+42.72

CED	BW	WW	YW	Scrotal	CEM	Milk	\$EN
I+8	I+3.0	I+48	I+97	I+.70	I+7	I+27	-6.30

Act. BW	Adj. WW	Adj. YW	%IMF	RE	Fat
89	722	1464	I+.21	I+.31	I+.018

• This moderate birth weight Right Time son will sire tremendous growth, maternal, and offspring with carcass numbers. Dams WR 2/102.

## 159 Bull Calved: 2/25/07 Tattoo: 759 15794714

#GAR Precision 1680  
 +E&B 1680 Precision 295  
 E&b 4137 Lady Dominique 794

#Tehama Bando 155  
 9J9 GAR 856  
 #Gardens EXT 4137 S2  
 Lady Scotch Traveler 321

								\$W
								+22.11
								\$F
								+14.84
								\$G
								+23.84
								\$B
								+38.62

CED	BW	WW	YW	Scrotal	CEM	Milk	\$EN
I+8	I+3.3	I+40	I+71	I+.04	I+9	I+18	+8.63

Act. BW	Adj. WW	Adj. YW	%IMF	RE	Fat
95	737	1300	I+.33	I+.37	I+.006

• You will like the way this bull is made and bred. He is the right kind with moderate birth weight. Dams WR 7/104.

## 160 Bull Calved: 2/16/07 Tattoo: 7160 15794715

#GAR Precision 1680  
 +E&B 1680 Precision 295  
 E&b 4137 Lady Dominique 794

#Tehama Bando 155  
 9J9 GAR 856  
 #Gardens EXT 4137 S2  
 Lady Scotch Traveler 321

								\$W
								+24.54
								\$F
								+13.07
								\$G
								+27.08
								\$B
								+39.95

CED	BW	WW	YW	Scrotal	CEM	Milk	\$EN
I+7	I+0.3	I+37	I+68	I+.26	I+7	I+15	+11.87

Act. BW	Adj. WW	Adj. YW	%IMF	RE	Fat
71	710	1296	I+.39	I+.42	I+.001

• Lots 159 and 160 are each bred the same and should breed that way. Treat your cows to this pair of bulls. Dams WR 6/97.

## 161 Bull Calved: 3/07/07 Tattoo: 7161 15794716

#Bon View New Design 878  
 +E&B 878 New Design 4114  
 +E&d Lady 6807 796

#B/R New Design 036  
 Bon View Gammer 85  
 #DHD Traveler 6807  
 Lady 183 Traveler 334

								\$W
								+20.74
								\$F
								+20.25
								\$G
								+18.96
								\$B
								+36.03

CED	BW	WW	YW	Scrotal	CEM	Milk	\$EN
I+9	I+2.9	I+36	I+75	N/A	I+9	I+24	+2.52

Act. BW	Adj. WW	Adj. YW	%IMF	RE	Fat
88	673	1241	I+.17	I+.58	I+.011

• Another moderate birth weight 4114 son that is bred right. Dams WR 1/93.

## 162 Bull Calved: 2/22/07 Tattoo: 7162 15794717

Connealy Lead On  
 E&B Lead ON 450  
 +E&B 598 Lad Bando 292

#Connealy Leadtime  
 Eligence Plus of Conanga  
 #Bon View Bando 598  
 +E&d 1483 Lady Scotchman 797

								\$W
								+23.88
								\$F
								+28.55
								\$G
								+12.70
								\$B
								+35.55

CED	BW	WW	YW	Scrotal	CEM	Milk	\$EN
I+4	I+2.4	I+43	I+86	I+.04	I+5	I+24	-.57

Act. BW	Adj. WW	Adj. YW	%IMF	RE	Fat
83	716	1385	I+.02	I+.47	I-.005

• This is a powerful Lead On grandson that will work great on your mature cows. Dams WR 7/101.

## 163 Bull Calved: 1/21/07 Tattoo: 782 15807857

Ironwood New Design 022 701  
 Ironwood New Level  
 Wardens Blackcap 6148 6309

#B/R New Design 036  
 Wardens Lady 022 5410  
 #Finks 5522-6148  
 Wardens Blackcap SC 025

								\$W
								+27.49
								\$F
								+29.86
								\$G
								+20.16
								\$B
								+44.39

CED	BW	WW	YW	Scrotal	CEM	Milk	\$EN
I+9	I+2.7	I+50	I+90	N/A	I+5	I+31	-7.84

Act. BW	Adj. WW	Adj. YW	%IMF	RE	Fat
86	793	1401	I+.09	I+.32	I+.001

• This New Level bull is bred for power. Dams WR 1/108.

## 164 Bull Calved: 2/11/07 Tattoo: 783 15794780

#Bon View New Design 878  
 +E&B 878 New Design 4114  
 +E&d Lady 6807 796

#B/R New Design 036  
 Bon View Gammer 85  
 #DHD Traveler 6807  
 Lady 183 Traveler 334

								\$W
								+28.90
								\$F
								+17.59
								\$G
								+7.87
								\$B
								+24.96

CED	BW	WW	YW	Scrotal	CEM	Milk	\$EN
I+9	I+1.7	I+43	I+75	I+.70	I+9	I+26	+.80

Act. BW	Adj. WW	Adj. YW	%IMF	RE	Fat
87	781	1315	I-.01	I+.20	I+.016

• This 4114 son is out of a tremendous bred calving ease dam. Dams WR 3/104.

The spring bulls were scanned for ultrasound on 2-13-08. A supplementary sheet will be available sale day with ultrasound data, scrotal measurements, pelvic area, and gain information on test. If you would like this sheet before sale date, just give us a call and we can mail, e-mail or fax this to you. The ultrasound EPDs, \$G and \$B Values will change after we receive the ultrasound data. We will have updated figures available on a supplemental sheet.

## 165 Bull Calved: 3/20/07 Tattoo: 765 15794720

#Twin Valley Precision E161 #GAR Precision 1680  
 +ALC National T60N +WCC Blackcap C9  
 #ALC Blackcap E03F #N Bar Emulation EXT  
 Bon View Blackcap 1330

+HD Dunn Cornerstone 0245		Sitz Traveler 7594		CED	BW	WW	YW	Scrotal	CEM	Milk	\$EN	\$W
E&B Lady Cornerstone 4106		#Dixie Erica of CH 6180										+26.45
#+E&b 71 Lady Traveler 625		#GDAR Traveler 71		\$F								+28.05
		Lady Stacker B184		\$G								+15.64
Act. BW	Adj. WW	Adj. YW	%IMF	RE	Fat	\$B						
85	815		I+.22	I+.21	I+.014							+39.85

• This National bull should be a very good cow bull. The National daughters are in production and they are excellent cows. Dams WR 2/108.

## 166 Bull Calved: 1/15/07 Tattoo: 784 15807858

Ironwood New Design 022 701 #B/R New Design 036  
 Ironwood New Level Wardens Lady 022 5410  
 Wardens Blackcap 6148 6309 #Finks 5522-6148  
 Wardens Blackcap SC 025

+ALC National T60N		#Twin Valley Precision E161		CED	BW	WW	YW	Scrotal	CEM	Milk	\$EN	\$W
E&B Lady National 566		#ALC Blackcap E03F										+28.09
+E&B Everelda Queen 2145		#GDAR Rainmaker 340		\$F								+31.11
		+E&d 1483 Lady Scotchman 797		\$G								+14.12
Act. BW	Adj. WW	Adj. YW	%IMF	RE	Fat	\$B						
86	781	1335	I+.14	I+.26	I+.005							+39.70

• This is a little larger New Level son that is bred right. Dams WR 1/106.

## 167 Bull Calved: 3/20/07 Tattoo: 790 15794783

#GAR Precision 1680 #Tehama Bando 155  
 E&B 1680 Precision 1123 9J9 GAR 856  
 E&b 4137 Ext 9004 #Gardens EXT 4137 S2  
 +E&d 71 Lady Traveler 677

E&B 598 Bando 260		#Bon View Bando 598		CED	BW	WW	YW	Scrotal	CEM	Milk	\$EN	\$W
E&B Lady 260 Bando 495		+E&d 1483 Lady Scotchman 797										+22.98
E&B Ideal Lady 162		#Ideal 1418 of 8103 4286		\$F								+32.01
		+E&b Lady Ext 858		\$G								+12.80
Act. BW	Adj. WW	Adj. YW	%IMF	RE	Fat	\$B						
76	677		I+.13	I+.47	I+.028							+37.14

• A very good 1123 son. His dam is a beautiful brood cow. Dams WR 2/98.

## 168 Bull Calved: 2/18/07 Tattoo: 768 15794723

Dalebanks Centennial 2526 #Bon View New Design 878  
 Dalebanks Centennial 4670 #Witch of Dalebanks 9067  
 #Enamel 1614 of Dalebanks Dalebanks Emulation Ext 3383  
 #Enamel 4054 of Dalebanks

+HD Dunn Cornerstone 0245		Sitz Traveler 7594		CED	BW	WW	YW	Scrotal	CEM	Milk	\$EN	\$W
E&B Lady Cornerstone 4116		#Dixie Erica of CH 6180										+19.23
#+E&b 228 Lady Stepahead 725		+Finks Stepahead		\$F								+22.29
		Eota of Dalebanks 4189		\$G								+12.59
Act. BW	Adj. WW	Adj. YW	%IMF	RE	Fat	\$B						
85	710	1337	I+.05	I+.25	I-.001							+31.99

• This is a high growth son of Centennial. If you sell calves by the pound, this is the bull you should use on your mature cows. Dams WR 2/96.

## 169 Bull Calved: 2/21/07 Tattoo: 786 15794781

#OCC Glory 950G +OCC Exodus 712E  
 Koupals Glory 526 OCC Dixie Erica 971E  
 #Koupals Flower 072 #+OCC Edison 801E  
 Beefland Flower 675

#GDAR Rainmaker 340		#Lovana		CED	BW	WW	YW	Scrotal	CEM	Milk	\$EN	\$W
E&b Everelda Queen 0122		#Lady Blackbird 987 GDAR										+20.13
E&b Lady Ext 8100		#N Bar Emulation EXT		\$F								+16.65
		Lady 963 Dividend 402		\$G								+15.08
Act. BW	Adj. WW	Adj. YW	%IMF	RE	Fat	\$B						
80	691	1256	I+.07	I+.47	I+.010							+28.53

• This bull is bred a little different. We bought the Glory bull that was bred a little different in the good Koupal's herd in SD. This bull is bred right on the bottom side also. Dams WR 6/101.

## 170 Bull Calved: 2/28/07 Tattoo: 7170 15794726

#GAR Precision 1680 #Tehama Bando 155  
 +E&B 1680 Precision 295 9J9 GAR 856  
 #Gardens EXT 4137 S2  
 Lady Scotch Traveler 321

#GDAR Traveler 71		#Traveler 1148 GDAR		CED	BW	WW	YW	Scrotal	CEM	Milk	\$EN	\$W
+E&b Lady Traveler 631		GDAR Miss Blackcap 567										+25.52
Lady Stacker B184		#CH Stacker 7040		\$F								+10.00
		Miss Cracker Jack E220		\$G								+28.15
Act. BW	Adj. WW	Adj. YW	%IMF	RE	Fat	\$B						
76	728	1118	I+.45	I+.37	I+.008							+38.15

• This bull is bred for carcass, maternal and calving ease. Dams WR 10/98.

## 171 Bull Calved: 2/24/07 Tattoo: 7171 15794727

Dalebanks Centennial 2526 #Bon View New Design 878  
 Dalebanks Centennial 4670 #Witch of Dalebanks 9067  
 #Enamel 1614 of Dalebanks Dalebanks Emulation Ext 3383  
 #Enamel 4054 of Dalebanks

+LD Axis 1410		#Bon View Bando 598		CED	BW	WW	YW	Scrotal	CEM	Milk	\$EN	\$W
E&B Lady 1410 Axis 4126		Hinksons Erica 9310										+22.88
+E&B Everelda Queen 2153		#GDAR Rainmaker 340		\$F								+19.33
		+E&d 1483 Lady Scotchman 797		\$G								+16.94
Act. BW	Adj. WW	Adj. YW	%IMF	RE	Fat	\$B						
92	736	1357	I+.18	I+.22	I+.005							+34.79

• This good Centennial son is bred for maternal and growth. Dams WR 6/101.



# B SPRING BULLS B



E&b Everelda Queen 0117 - Dam of Lot 172

## 172 Bull Calved: 2/02/07 Tattoo: 787 15795843

+OCC Genesis 872G      #+OCC Doctor 940D  
DCC New Look 101      #Blackbird of RR 1204  
OCC Dixie Erica 814G      #OCC Anchor 771A  
   OCC Dixie Erica 764C

								#GDAR Rainmaker 340	#Lovana	\$W
								E&b Everelda Queen 0117	#Lady Blackbird 987 GDAR	+26.37
								+E&b Lady Ext 858	#N Bar Emulation EXT	\$F
								Lady Scotch Traveler 320	+7.75	
CED	BW	WW	YW	Scrotal	CEM	Milk	\$EN		\$G	
I+9	I+0.5	I+36	I+62	N/A	I+7	I+18	+11.09		+14.82	
Act. BW	Adj. WW	Adj. YW		%IMF	RE	Fat			\$B	
85	728	1312		I+.03	I+.48	I+.004			+23.53	

• This is a bull that is bred completely different. His dam 0117 is a Rainmaker daughter out of the great EXT 858 cow. He is a very good bull and it will be interesting how the bull scans. If you are looking for a bull that has a completely different pedigree, you might want to keep an eye on this bull. Dams WR 6/100.



E&b Lady Ext 858 - Granddam of Lot 172

**Benoit Angus will be retaining  
1/3 revenue sharing interest in  
all bulls selling.**

## 173 Bull Calved: 1/16/07 Tattoo: 788 15807860

#GAR Precision 1680      #Tehama Bando 155  
+GAR US Premium Beef      9J9 GAR 856  
GAR Ext 2928      #N Bar Emulation EXT  
   +GAR 6807 Traveler 154

								LD Hawkeye 211	+B/R New Frontier 095	\$W
								E&B Lady 211 Frontier 584	#LD 6807 Pride 9211	+19.35
								E&B Eriskay Lady 121	#RR 9440 Scotch Cap 1483	\$F
									+E&d 71 Lady Traveler 676	+15.90
CED	BW	WW	YW	Scrotal	CEM	Milk	\$EN		\$G	
I+8	I+2.2	I+32	I+69	N/A	I+9	I+19	+8.36		+18.86	
Act. BW	Adj. WW	Adj. YW		%IMF	RE	Fat			\$B	
84	713	1407		I+.29	I+.22	I+.028			+32.32	

• This Premium Beef son will work great on virgin heifers. He is bred that way on the bottom side of his pedigree also. Dams WR 1/97.

## 174 Bull Calved: 3/11/07 Tattoo: 7174 15794730

BR Midland      #Twin Valley Precision E 161  
A&B Midland 5096      BR Royal Lass 7036-19  
A&B Own Lass 9050      SVF Oscar 18E  
   A&b Lass 5037

								#Bon View New Design 878	#B/R New Design 036	\$W
								E&B Lady 878 New Design 429	Bon View Gammer 85	+21.89
								+E&B Lady Precision 2147	#GAR Precision 1680	\$F
									+E&d 7040 Lady Stacker 671	+23.67
CED	BW	WW	YW	Scrotal	CEM	Milk	\$EN		\$G	
I+6	I+2.7	I+40	I+80	N/A	I+5	I+21	+3.65		+27.11	
Act. BW	Adj. WW	Adj. YW		%IMF	RE	Fat			\$B	
83	723	1273		I+.50	I+.51	I+.022			+47.01	

• This is a well bred Midland grandson that is bred right for your cows. Dams WR 2/98.

## 175 Bull Calved: 2/10/07 Tattoo: 789 15794782

#B/R New Design 036      #VDAR New Trend 315  
+E&B New Design 3133      B/R Blackcap Empress 76  
E&b 6807 Lady Traveler 61      #DHD Traveler 6807  
   Lady 963 Dividend 404

								+Alc Baldrige Kenworth I30K	#Connealy Dateline	\$W
								E&B Lady Kenworth 521	+Alc Baldrige Primroselady54F	+29.43
								#+E&B Lady Erica 1001	#N Bar Emulation EXT	\$F
									+E&b 71 Lady Traveler 609	+15.65
CED	BW	WW	YW	Scrotal	CEM	Milk	\$EN		\$G	
I+12	I+1.2	I+43	I+73	N/A	I+11	I+23	+3.92		+12.69	
Act. BW	Adj. WW	Adj. YW		%IMF	RE	Fat			\$B	
77	724	1353		I+.07	I+.21	I+.008			+28.67	

• This 3133 son is bred for calving ease all the way. Dams WR 1/99.

## 176 Bull Calved: 2/19/07 Tattoo: 791 15794784

#B/R New Design 036      #VDAR New Trend 315  
+E&B New Design 3133      B/R Blackcap Empress 76  
E&b 6807 Lady Traveler 61      #DHD Traveler 6807  
   Lady 963 Dividend 404

								KCF Bennett Coalition SCC	#Sitz Alliance 6595	\$W
								+E&B Lady Coalition 579	#Pleasant Pill of Conanga	+27.21
								+E&b Lady Erica 079	#N Bar Emulation EXT	\$F
									Lady 6807 Traveler 384	+11.32
CED	BW	WW	YW	Scrotal	CEM	Milk	\$EN		\$G	
N/A	I-0.9	I+34	I+65	N/A	N/A	I+24	+5.27		+16.23	
Act. BW	Adj. WW	Adj. YW		%IMF	RE	Fat			\$B	
63	668	1201		I+.24	I-.06	I+.019			+26.91	

These 3133 sons are sure calving ease bulls that look the part. Dams WR 1/91.

# E= SPRING BULLS = E===== NOTES ===== E

## 177 Bull Calved: 3/20/07 Tattoo: 7185 15794740

#Bon View Bando 598 #Tehama Bando 155  
 +LD Axis 1410 #Bon View Dora 56  
 Hinksons Erica 9310 #DHD Traveler 6807  
 #Hinksons Erica 911119

#GDAR Traveler 71		#Traveler 1148 GDAR		\$W				
#+E&b 71 Lady Traveler 625		GDAR Miss Blackcap 567		+28.45				
Lady Stacker B184		#CH Stacker 7040		\$F				
		Miss Cracker Jack E220		+13.29				
CED	BW	WW	YW	Scrotal	CEM	Milk	\$EN	\$G
I+9	I+0.6	I+39	I+69	I+.12	I+10	I+24	+4.17	+13.64
Act. BW	Adj. WW	Adj. YW	%IMF	RE	Fat	\$B		
85	756		I+.15	I+.10	I+.021	+27.17		

• This Axis son is a light birth weight heifer bull. Dams WR 9/105.

## 178 Bull Calved: 4/02/07 Tattoo: 7181 15794738

#Bon View Bando 598 #Tehama Bando 155  
 +LD Axis 1410 #Bon View Dora 56  
 Hinksons Erica 9310 #DHD Traveler 6807  
 #Hinksons Erica 911119

#CA Future Direction 5321		#GAR Precision 1680		\$W				
+E&B Lady Future Direction 44		CA Miss Power Fix 308		+27.18				
E&b 1483 Lady Scotchman 709		#RR 9440 Scotch Cap 1483		\$F				
		Lady 107 Rito Traveler 508		+21.68				
CED	BW	WW	YW	Scrotal	CEM	Milk	\$EN	\$G
N/A	I+0.1	I+40	I+78	N/A	N/A	I+24	+1.68	+20.40
Act. BW	Adj. WW	Adj. YW	%IMF	RE	Fat	\$B		
77	757		I+.25	I+.45	I+.012	+39.29		

• Another light birth weight Axis son that will be a treat for your heifers. Dams WR 2/102.

## 179 Bull Calved: 3/25/07 Tattoo: 7179 15794735

#Bon View Bando 598 #Tehama Bando 155  
 +E&B 878 New Design 4114 Bon View Gammer 85  
 +E&d Lady 6807 796 #DHD Traveler 6807  
 Lady 183 Traveler 334

#White Oak Precise 6002		#GAR Precision 1680		\$W				
E&B Lady Precise 335		Stone Gate Jessie		+23.37				
+E&B Everelda Queen 192		#GDAR Rainmaker 340		\$F				
		E&b 6807 Lady Traveler 61		+15.15				
CED	BW	WW	YW	Scrotal	CEM	Milk	\$EN	\$G
I+8	I+1.4	I+34	I+69	I+.51	I+8	I+22	+5.87	+13.81
Act. BW	Adj. WW	Adj. YW	%IMF	RE	Fat	\$B		
83	703		I+.05	I+.35	I+.005	+27.28		

• This is a light birth weight 4114 son that is definitely bred for calving ease on the bottom side. Dams WR 3/99.

**Receive a 5% discount if you purchased a bull from last years sale.**



Now **Genetics, Source** and **Group Age** can all be documented with **ONE Tag**.

## American Angus Association \$Value Indexes

### Step 1 Become a Producer Participant

To be eligible to supply cattle to the AngusSource® program, producers must have Angus-sired cattle that originate on their operation, use registered Angus bulls, have management practices which allow for the identification of cattle that are Angus-sired, and keep calving records that document the birth date of the oldest calf.

Complete the AngusSource® Producer Participant Enrollment form and Agreement. Download forms at [www.angussource.com](http://www.angussource.com) or request by calling AngusSource®.

**This information must be submitted prior to enrolling cattle.**

### Step 2 Enroll Calves/Order Tags

Enroll calves by calling AngusSource®. Provide enrollment information to AngusSource® and submit any required records. Enrollment fee: \$1 per head for visual tags, \$3.25 for RFID matched pair tags.

### Step 3 Print/Customize Documents

Print or customize AngusSource® Document for feeder cattle or replacement females. To customize, enter information about the health, management and sale date/location. Market cattle through an auction, video or direct by using the printed AngusSource® Document(s) to convey valuable information to potential buyers.

For more information, contact AngusSource<sup>SM</sup> at 816-383-5100 or [angussource@angus.org](mailto:angussource@angus.org) or visit [www.angussource.com](http://www.angussource.com)

## ANGUS SOURCE “Rebate” Program

### From Benoit Angus

Benoit Angus will buy 20 “Angus Source” tags for every bull purchased at Benoit Angus for the last two years and in the future.

To participate in the Angus Source program, commercial customers must first complete the “Beef Improvement Records” enrollment form, available in printed form from the American Angus Association or online at [www.angussource.com](http://www.angussource.com). Tags may then be ordered in one or two ways, [www.angussource.com](http://www.angussource.com) or by calling the AAA. Allow at least two weeks for tag orders to be processed and shipped to you.

After tags have been ordered, Fax or e-mail a copy of the AAA receipt/invoice (you will receive this from the AAA a few days after your order is processed) to Benoit Angus. If you are using bulls not purchased from Benoit Angus, please indicate the total number of tags ordered from Benoit Angus sired calves only, and we will send you a check for these tags.

For more information on the Angus Source program, contact the AAA Commercial Programs department at 816-383-5100 or go to [www.angussource.com](http://www.angussource.com). Thank you for your continued use of Benoit Angus Genetics!

**\$Values** are multi-trait selection indexes expressed in dollars per head, to assist commercial beef producers by adding simplicity to genetic selection decisions. A \$Value has meaning only when used in comparison to the \$Value of another animal. For example, just as with EPDs, variation in \$Values between animals indicates average expected differences in the relative value of progeny if random mating is assumed and the calves are exposed to the same environment.

\$Values			
\$W	\$F	\$G	\$B
+21.28	+13.60	+12.53	+25.32

**Weaned Calf Value (\$W):** an index expressed in dollars per head, is the expected average difference in future progeny performance for preweaning merit. \$W includes both revenue and cost adjustments associated with differences in birth weight, weaning direct growth, maternal milk, and mature cow size.

**Feedlot Value (\$F):** an index expressed in dollars per head, is the expected average difference in future progeny performance for postweaning performance compared to progeny of other sires.

**Grid Value (\$G):** an index expressed in dollars per head, is the expected average difference in future progeny performance for carcass grid merit compared to progeny of other sires.

**Beef Value (\$B):** an index expressed in dollars per head, is the expected average difference in future progeny performance for postweaning and carcass value compared to progeny of other sires. The \$B value combines the contributions of \$F and \$G.

## How do I use them?

\$Values should be used to complement the criteria that producers already use when selecting bulls.

The \$Values are not designed to be driven by a single trait, as an index is multi-trait by design. These selection tools are the result of the application of industry-relevant market values to Angus genetics for preweaning, feedlot, and carcass merit.

The \$W, \$F, \$G and \$B values on individual animals and the Sire Evaluation Report may be viewed at [www.angus.org](http://www.angus.org).

### American Angus Association

3201 Frederick Avenue > St. Joseph, MO 64506  
816-383-5100

[ahir@angus.org](mailto:ahir@angus.org) > [www.angus.org](http://www.angus.org)



# LiveAuctions. TV

**Internet Bidding:** If you are unable to attend the bull sale for any reason, internet bidding is available via the LiveAuctions.tv website, on high speed internet only. Internet buyers must create an account and request a buyer number prior to the sale. If you choose to use this service please visit our sale at <http://www.LiveAuctions.tv>.

— or —

Real-time bidding is available via the internet for this sale. Live audio and live video will allow buyers to bid on animals just as if they were present at the sale. Buyers must create an account prior to the sale. Please visit <http://www.LiveAuctions.tv> to create an account and request a buyer number. Instructions are available at <http://www.LiveAuctions.tv> to walk you through the account setup process.

Web Address ..... <http://www.LiveAuctions.tv>  
LiveAuctions.tv, e-mail address [brad@LiveAuctions.tv](mailto:brad@LiveAuctions.tv)  
Questions call Brad Fahrmeier (816) 392-9241

*Buyers who would like to bid via the internet must register with LiveAuctions.tv two days prior to the sale.*

Check out our website at [benoitangus.com](http://benoitangus.com) for more information.

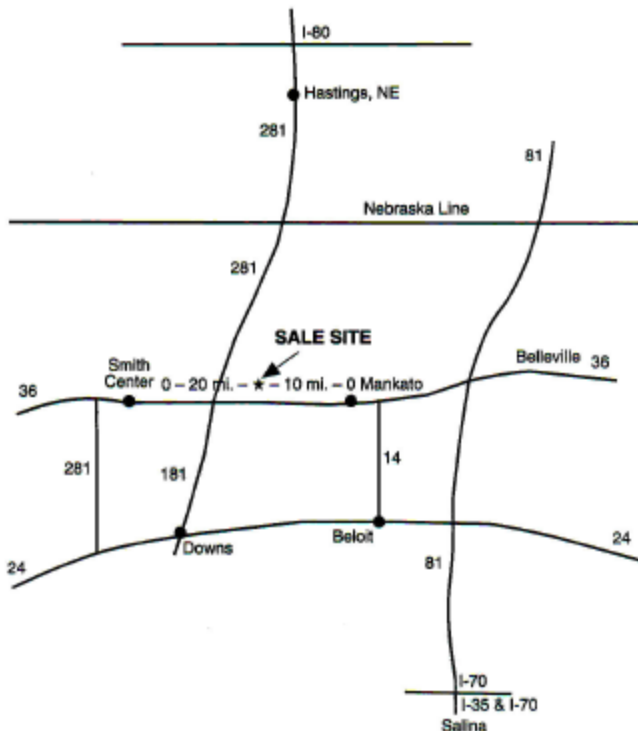

## SALE SITE:

10.5 miles west of Mankato, KS,  
on Highway 36,  
or  
22 miles east of Smith Center, KS,  
on Highway 36.

60 miles south of Hastings, NE  
or 90 miles north of Salina, KS.  
888-870-2855





19th Annual Production Sale  
Thursday, March 20, 2008  
1:00 PM - At The Ranch



The Benoit's Welcome You

Benoit Angus Ranch  
Everett & Bonnie Benoit and Family  
631 Hwy. 36  
Esbon, KS 66941

First Class  
U.S. POSTAGE  
**PAID**  
Permit #4  
Esbon, KS  
66941